



5 Maiden Close, Skelmersdale

Skelmersdale

Guide Price £215,000

# 5 Maiden Close

Skelmersdale

Well-presented detached three-bedroom home with sunroom, ensuite, modern kitchen, driveway, and private garden in a popular area. Ideal for families seeking practical, flexible living space. Council Tax band: C

Tenure: Freehold

EPC Energy Efficiency Rating: D

EPC Environmental Impact Rating: D

- Three Bedroom Detached House
- En-Suite & Family Bathroom
- Driveway
- Conservatory
- Old Skelmersdale Location







Ground Floor

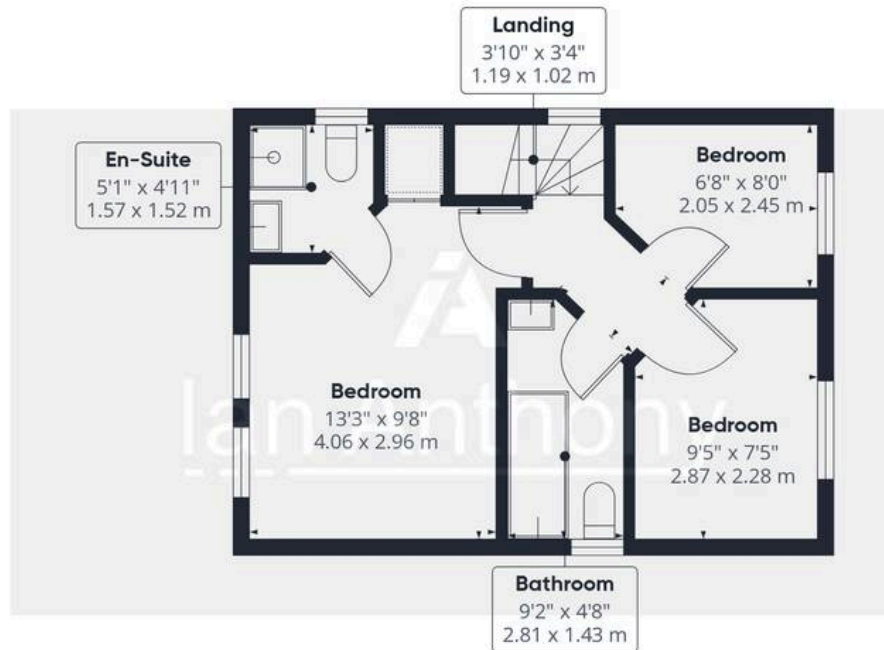

Floor 1

Approximate total area<sup>(1)</sup>

904 ft<sup>2</sup>

83.8 m<sup>2</sup>

(1) Excluding balconies and terraces

Calculations reference the RICS IPMS 3C standard. Measurements are approximate and not to scale. This floor plan is intended for illustration only.

GIRAFFE360





## IAN ANTHONY

5 Burscough Street, Ormskirk - L39 2EG

01695580888

[enquiries@iananthonyestates.co.uk](mailto:enquiries@iananthonyestates.co.uk)

[iananthonyestates.co.uk/](http://iananthonyestates.co.uk/)

