



RICHMONDS

Barton Drive, Hedge End, Southampton, SO30 2FF

£349,950

An attractive and spacious three-bedroom family home with a generous plot which features a substantial side garden that presents exceptional potential to extend the existing property or create another dwelling, obviously this is subject to the required planning consents.

Inside, the home offers a bright and versatile open plan lounge and dining area, ideal for both everyday family living and entertaining guests. There is a fitted kitchen which is well proportioned and this is complemented by a rear extension providing additional living space and flexibility for the modern lifestyle.

Upstairs, the property has three well-proportioned bedrooms and a family bathroom with separate WC.

Offered with no forward chain, this is a fantastic opportunity for those seeking a smooth and straightforward purchase, as well as those looking to unlock the future potential of the plot.

Other Information

Tenure: Freehold
Heating: Gas central heating
Windows: UPVC double glazing
Loft: Not inspected
Energy Rating: C
Sellers Position: No forward chain

Local Information:

Council Tax: C
Local Authority: Eastleigh Borough Council





Energy Efficiency Rating		
	Current	Potential
Very energy efficient - lower running costs		
(92+) A		
(81-91) B		84
(69-80) C	70	
(55-68) D		
(39-54) E		
(21-38) F		
(1-20) G		
Not energy efficient - higher running costs		
England & Wales	EU Directive 2002/91/EC	

WWW.EPC4U.COM

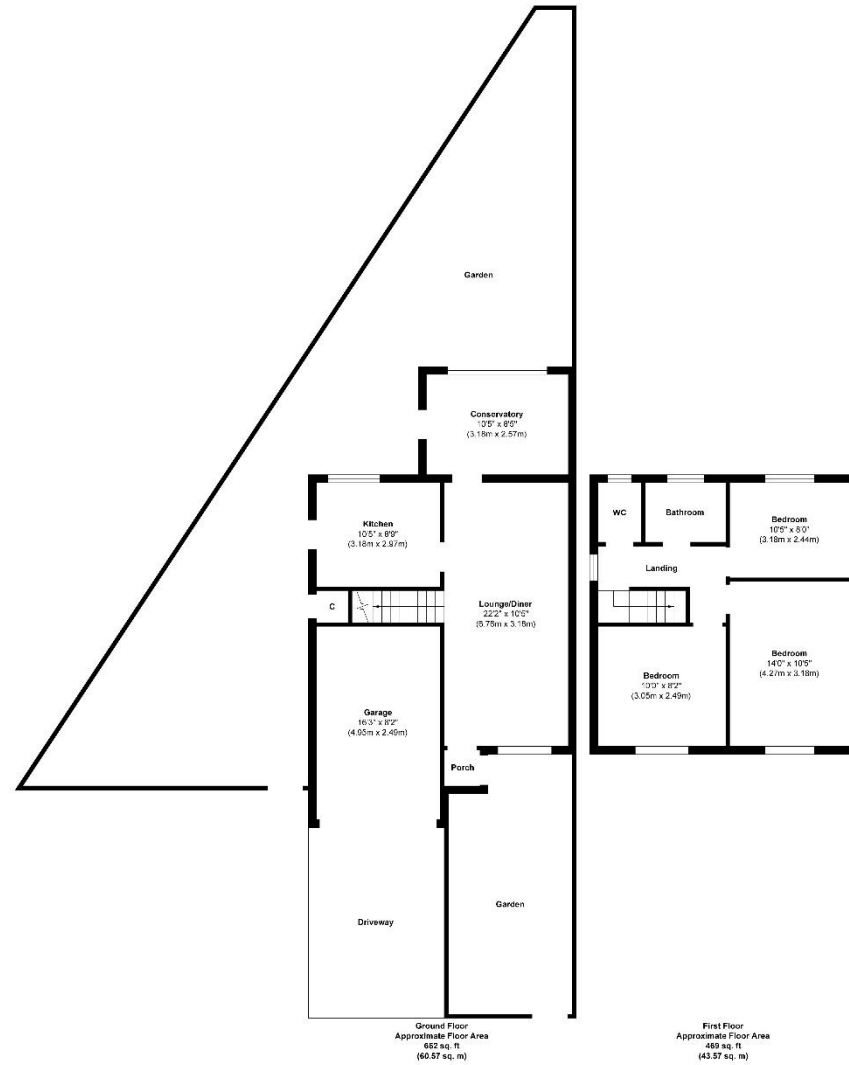

Approx. Gross Internal Floor Area 1121 sq. ft / 104.14 sq. m

Illustration for identification purposes only, measurements are approximate, not to scale.

Produced by Elements Property

Agents Note: The sellers of the property have provided the above information to us and we are therefore reliant on them providing the correct information. The floor plan and sizes are to be used as a guide only. Please check room sizes prior to ordering carpets or furniture. If you require confirmation on any particular point for specific purposes please contact our office for further information. If you have other questions about this property, please telephone **01489 789933**

R545 Ravensworth 01670 713330

Lankester House, 1 Freegrounds Road, Hedge End, Southampton SO30 0HG • 01489 789933 • admin@richmondsproperty.co.uk

