



Commercial (EPC Rating: C)

# 91 & 91A BISPAM ROAD, SOUTHPORT, PR9 7DF

## £190,000

FREEHOLD



# Null Bedroom Commercial located in Southport

Nestled on Bispham Road in the charming town of Southport, this mixed-use Commercial and Residential property presents an exceptional opportunity for both business owners and investors alike with independent access to each unit. The ground floor is accessed directly from the front forecourt, and the first floor flat has its own entrance and staircase positioned to the side of the property. This ensures complete separation between the Commercial and Residential units. A spacious forecourt area allows easy access for parking of multiple vehicles can be split between both units.

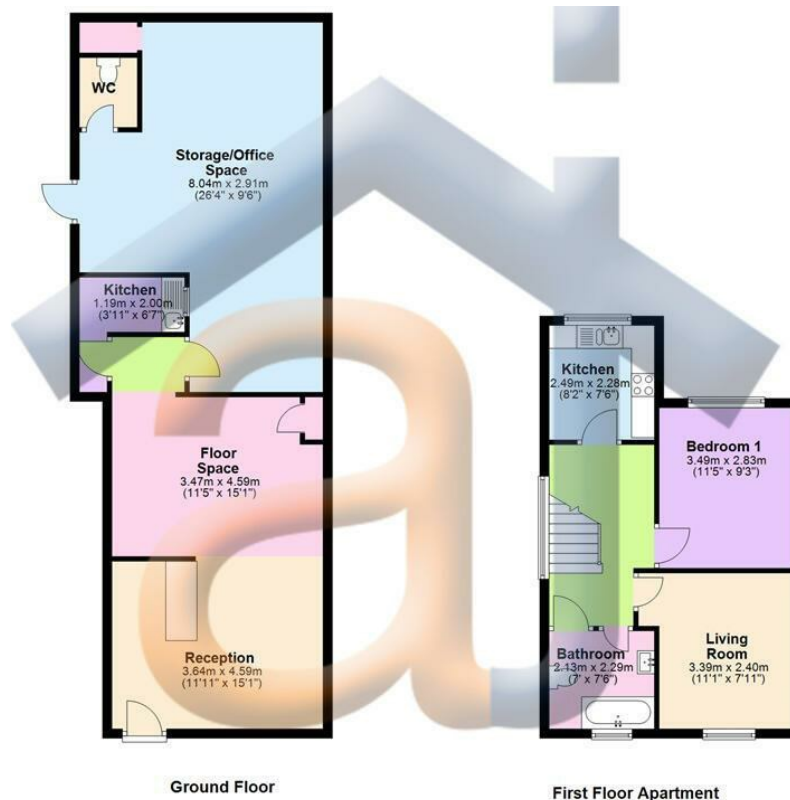

\*Whilst every attempt has been made to ensure the accuracy of the floor plan contained here, measurements of doors, windows, rooms and any other item are approximate, and no responsibility is taken for any error, omission, or misstatement. This plan is for illustrative purposes only and should only be used as such by any prospective purchaser.  
Plan produced using PlanUp.

Council Tax Band

**A**

Energy Performance Graph

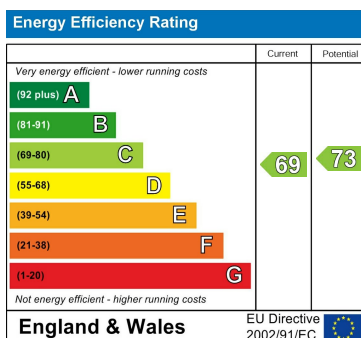

Call us on

**01704550048**

[sales@ajestateagents.co.uk](mailto:sales@ajestateagents.co.uk)

<https://www.ajestateagents.co.uk/properties/1/sale>

Agents Note: Whilst every care has been taken to prepare these particulars, they are for guidance purposes only. All measurements are approximate and are for general guidance purposes only and whilst every care has been taken to ensure their accuracy, they should not be relied upon and potential buyers are advised to recheck the measurements.