

**LONDON
VICTORIA
GROUPS** 



Bagshaw Building, 1 Wards Place

, London E14 9DY

- Panoramic River & Canary Wharf Views
 - 25m Swimming Pool
 - Residents' Lounge
 - EPC-B
- 24-Hour Concierge
 - Gym
 - CTB-E

£2,550 Per Month



Local Authority **Tower Hamlets**
Council Tax Band **E**
EPC Rating **B**

BAGSHAW BUILDING

APPROXIMATE GROSS INTERNAL FLOOR AREA: 391 SQ FT - 36.32 SQ M

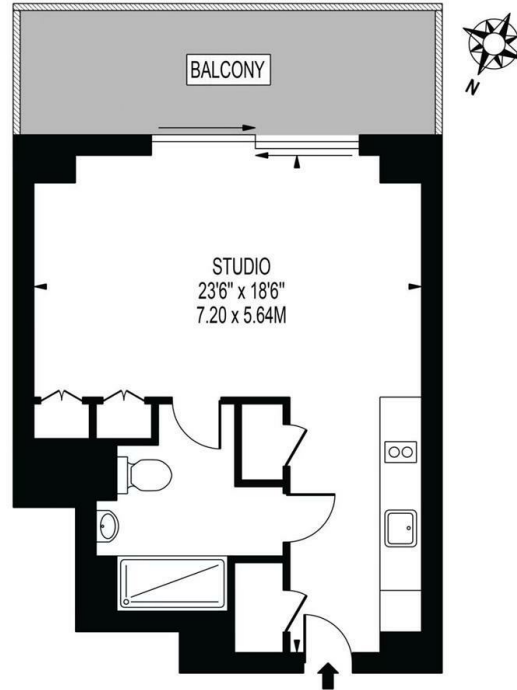

London Office Office
Spaces Victoria, 25 Wilton Road, Pimlico,
London, SW1V 1LW

Contact
020 3084 3094
XL@londonvictoriagroups.co.uk
www.londonvictoriagroups.co.uk

Agents Note: Whilst every care has been taken to prepare these particulars, they are for guidance purposes only. All measurements are approximate and for general guidance purposes only and whilst every care has been taken to ensure accuracy, they should not be relied upon and potential buyers/tenants are advised to recheck the measurements.

