



## St. George Wharf, SW8

£2,747 Per calendar month

An immaculate one bedroom apartment with direct views of the River Thames. Further benefits include a modern kitchen with brand new appliances, a bright reception and dining room which leads onto a large River facing balcony.

St George Wharf is Riverside development with great transport links to the City and West End. The building has a twenty four hour concierge and there are plenty of riverside bars and restaurants close by.

### Features

- One Double Bedroom
- Immaculate Condition
- Direct River Views
- Large Balcony
- Modern Tiled Bathroom
- Hard Flooring Throughout

# St. George Wharf, London, SW8

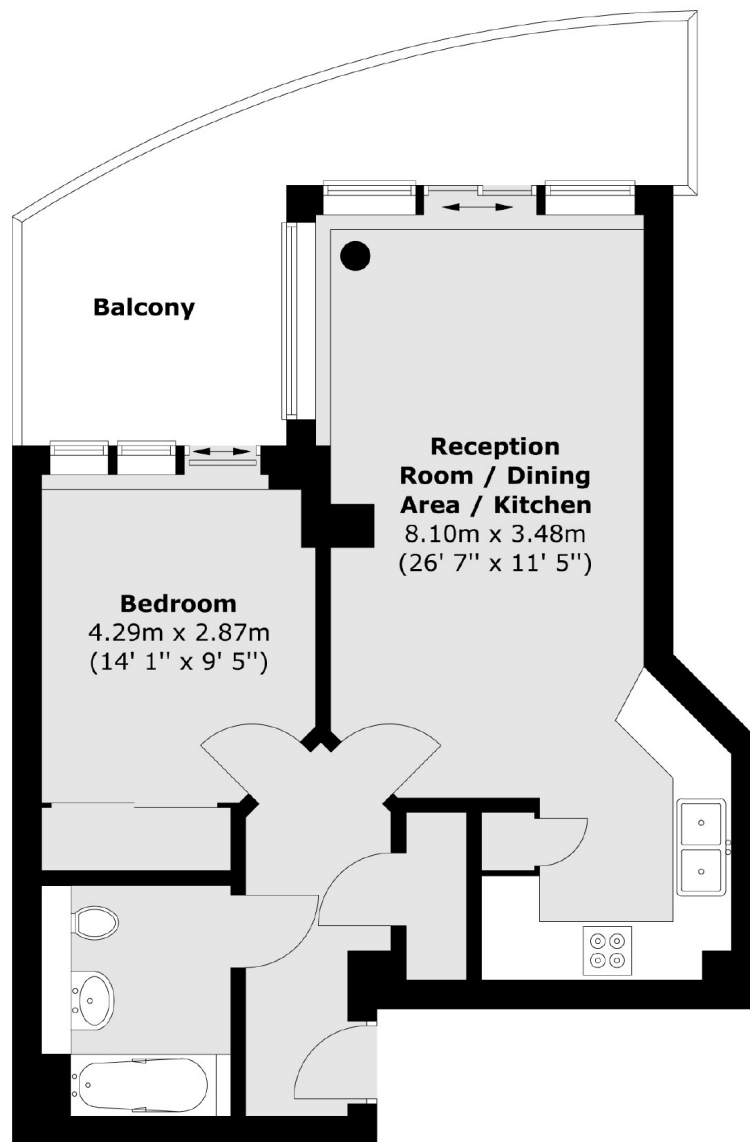

Total area (approx.) : 50.3 sq. m (541 sq. ft)  
Total balcony area (approx.) : 13.1 sq. m (141 sq. ft)