

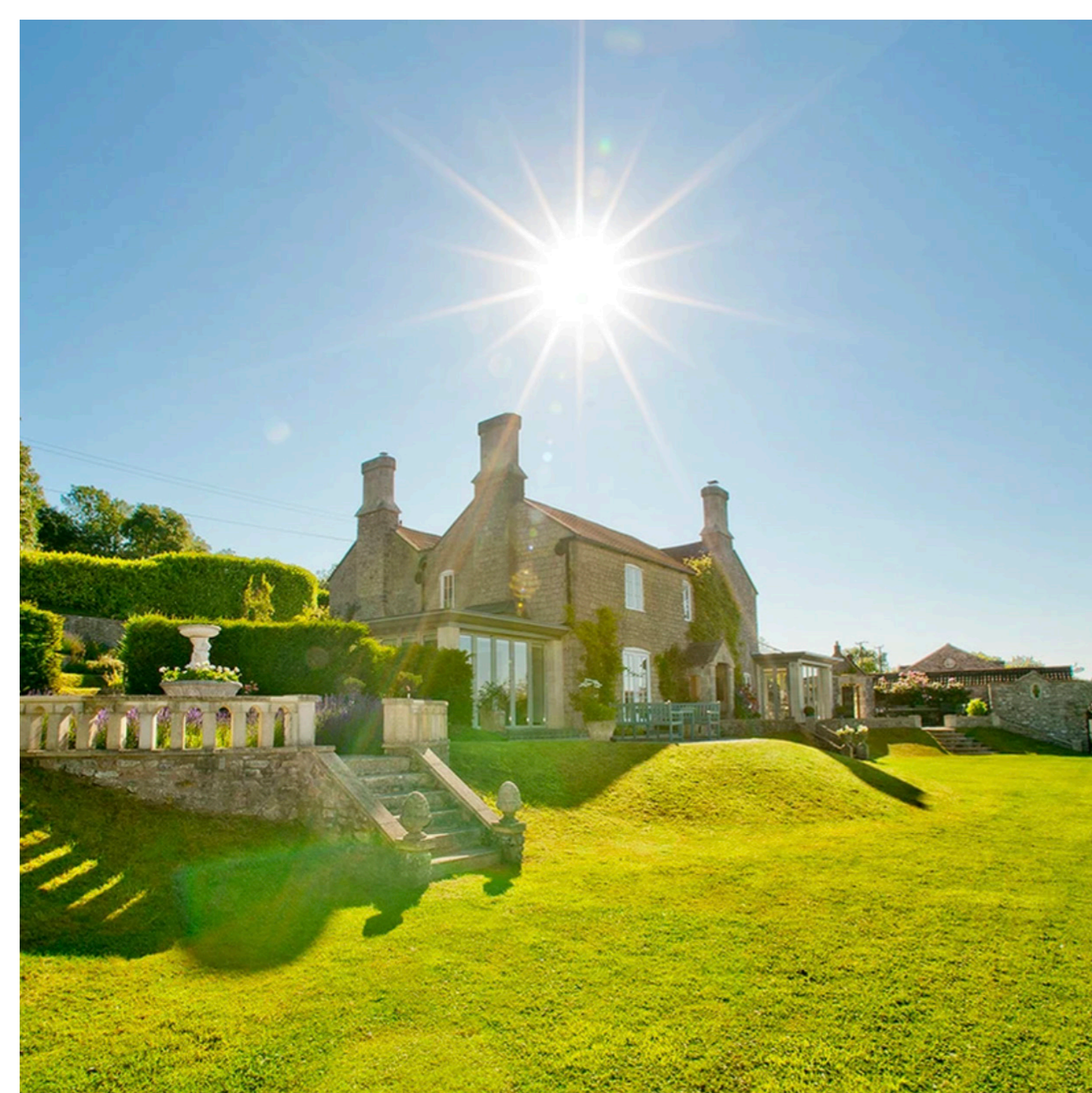

UPPER VOBSTER FARM

SOMERSET ENGLAND



UPPER VOBSTER FARM

Dating back to the 16th Century, a newly refurbished multi-dwelling luxury country estate fringes onto pristine woodland, filled with gardens, rich beauty, capturing each season grandly for all ages. A rare estate of timeless beauty...





UPPER VOBSTER FARM

Upper Vobster Farm is a timeless country estate in superb condition, having been extensively renovated throughout the last 30 years to the highest standards of workmanship and design.

This 36 acre* multi-dwelling property in beautiful Somerset is privately nestled along a valley and stream, the perfect spot for enjoying all the magnificent beauty this rare estate offers.

Along with the generous main farmhouse complete with its own annexe, there is a classic period stone cottage, converted stone barn and a further three fully equipped self-catering dwellings. All are consistently maintained to Visit England 5* Gold standard.

Situated around the lower courtyard and triangular fish filled pond there is an impressive conference room, the Long Room kitchen, extra bathrooms, office and meeting spaces, laundry and gym, beauty, painting and maintenance rooms.

Set supreme in the old apple orchard is the stunning outdoor heated pool, with automatic safety cover, and a spa and steam room set in a spacious luxury pool house. The lounge is an ideal area for a gym or simply as a relaxation space.

Upper Vobster Farm is a home as well as a

fully functioning self-catering accommodation business with the scope to have the land and space to enjoy as a family or to continue to grow the business, which has been the private sanctuary and get away for a number of high-profile guests over the years.

The love and care that has been invested is very evident and quality finishings don't go unnoticed, with the blue Lias flagstone floors, bespoke hand-built kitchens, traditional Aga stoves and exquisite bathroom features. This care extends beyond the buildings in the abundant kitchen garden, beautiful grounds, well maintained paddocks and over 6 acres of ancient protected and sacred woodland to complement such a serene living environment.

Enjoy the walking tracks, wild flower meadows and gardens. Discover the blue bells and wild garlic in the spring, the autumn leaves falling later in the year and gather around one of the many open fire places for the winter. Buzzards, red kites, kingfishers, deer, squirrels, owls, badgers and even otters are all frequent visitors to Upper Vobster Farm.

This property must be visited in person to fully experience the quality of the buildings and the magic of the grounds and we welcome genuine enquiries.



Hidden gems...

Cherry Tree Cottage

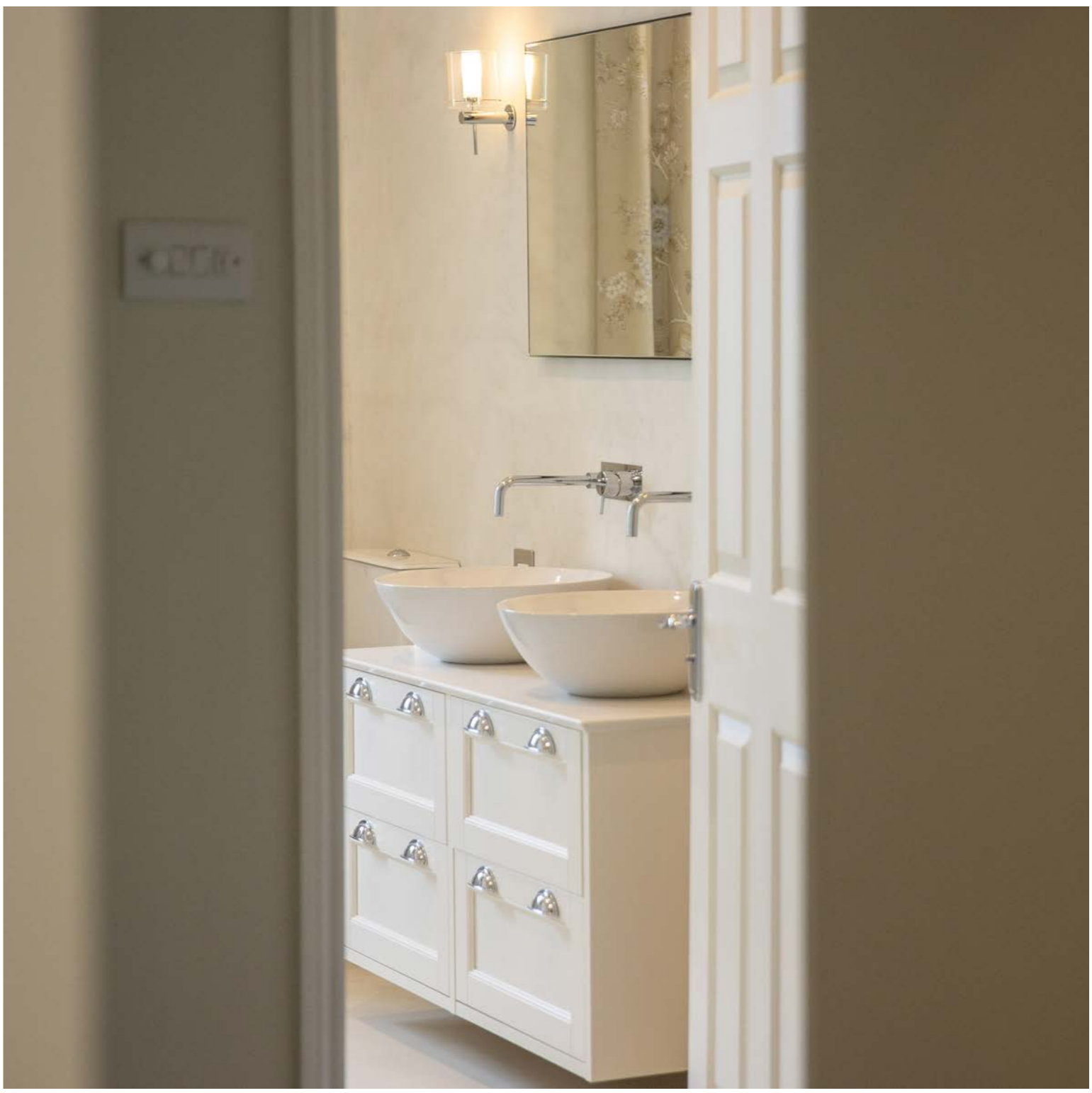
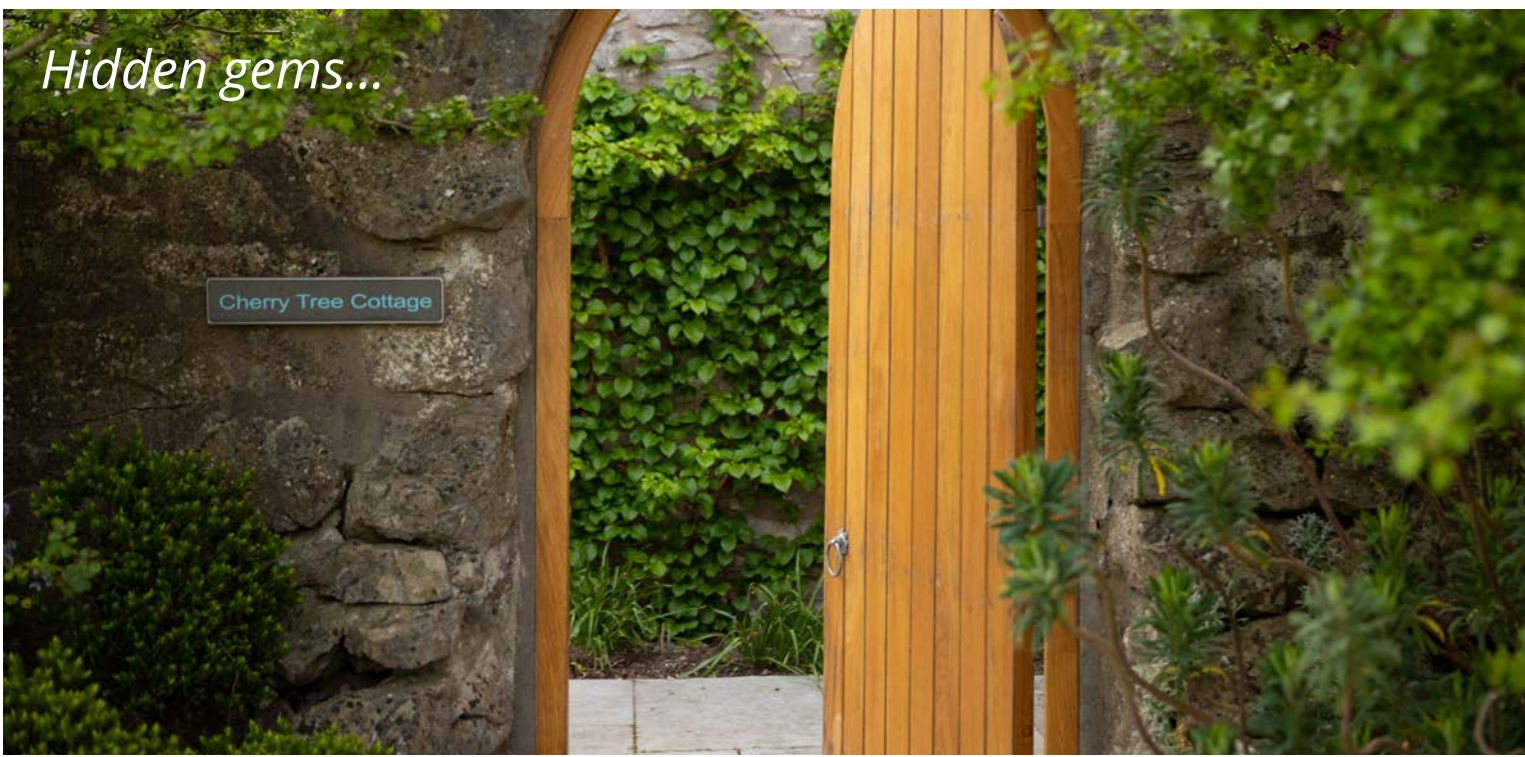



Spread over 36 acres of majestic Somerset soil

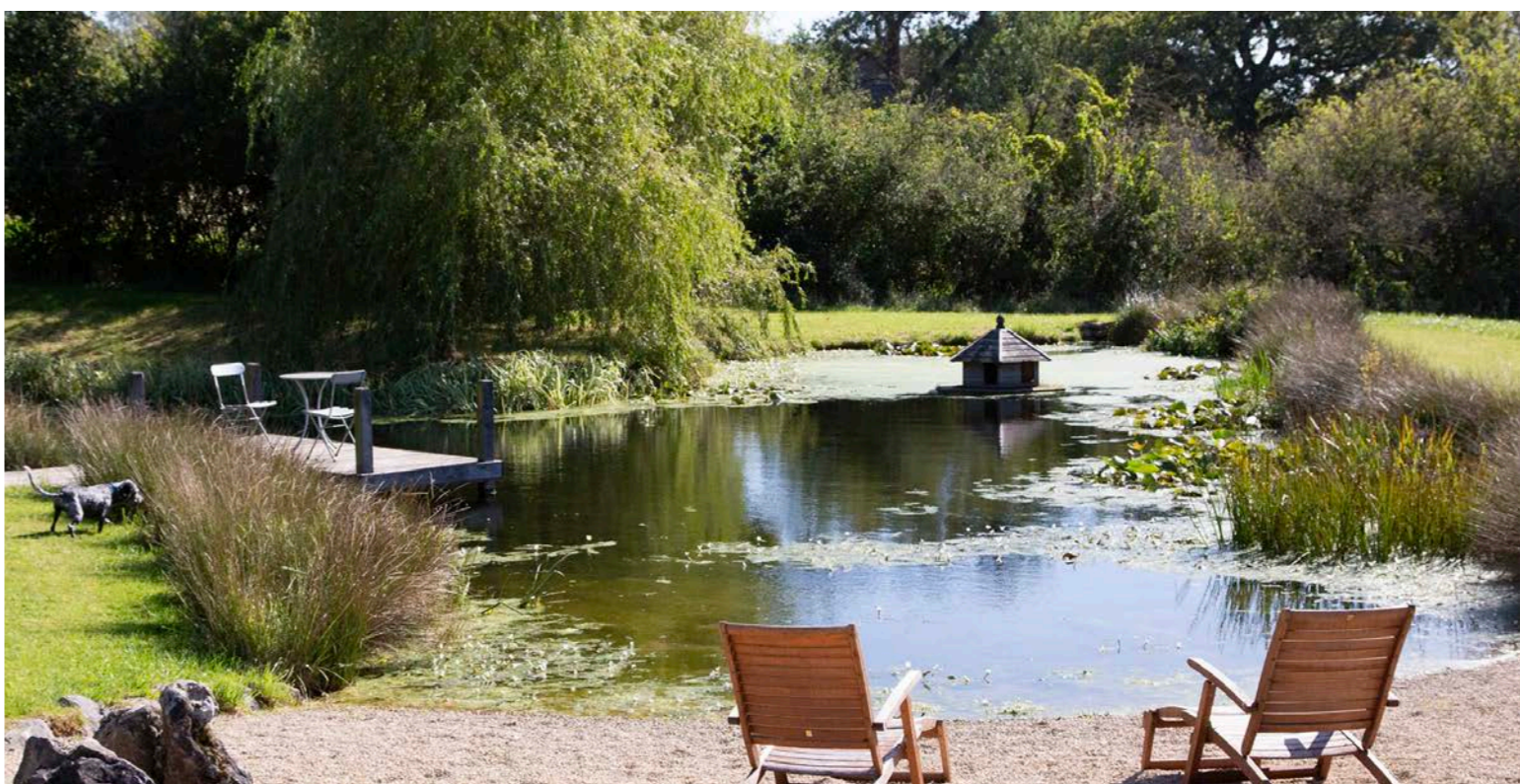



With a heart at home...









Bespoke facilities for every aspect



Light and space flowing across the entire estate





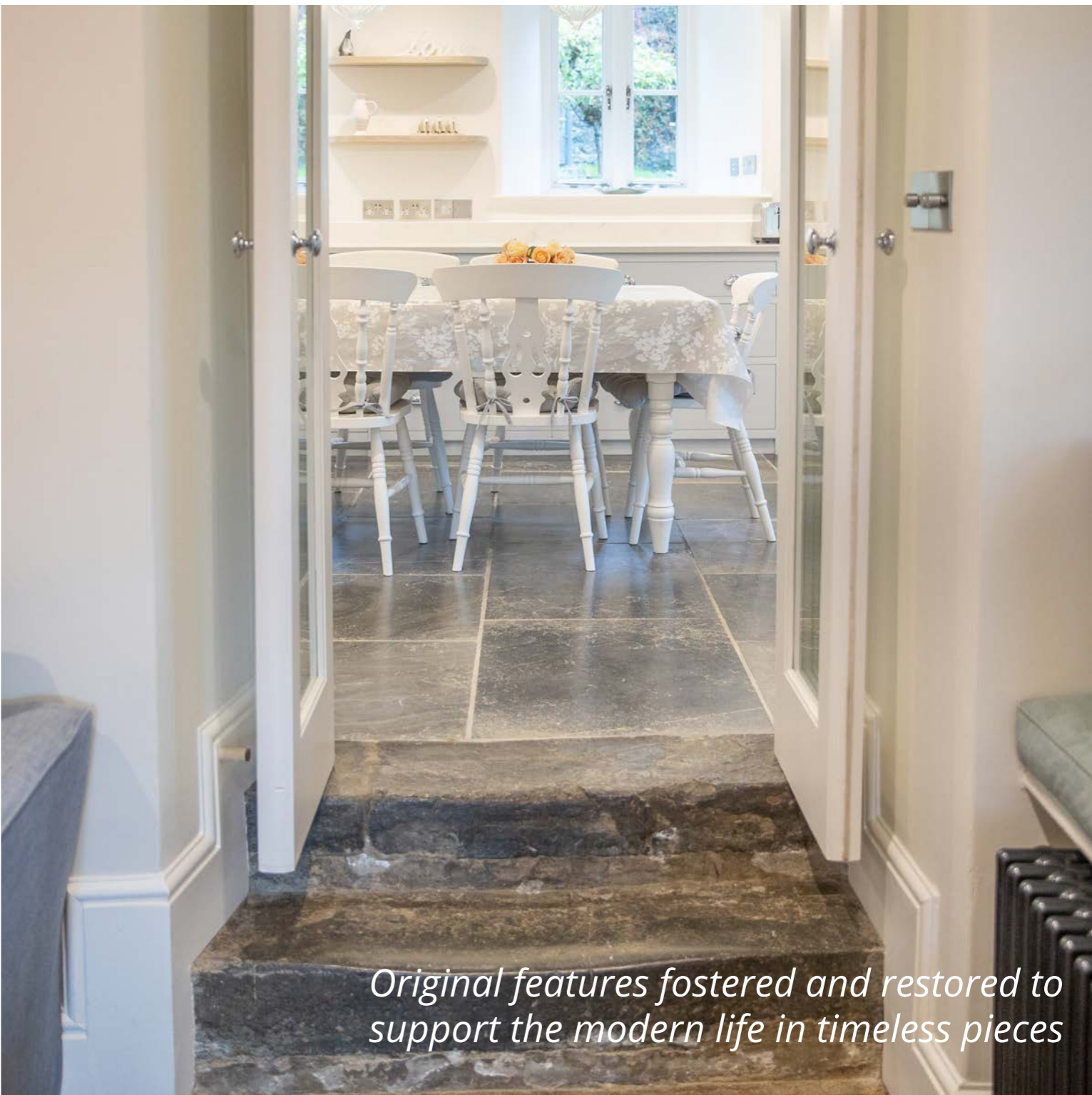

Original features fostered and restored to support the modern life in timeless pieces





Babington House 0.1 miles



London 100 miles

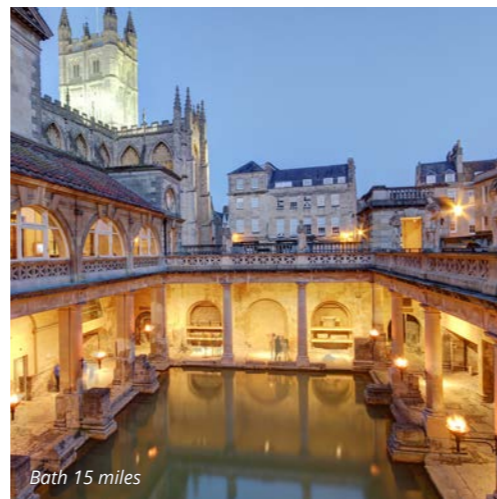

Bath 15 miles



Cheddar Gorge 15 miles



Longleat Safari Park 9 miles

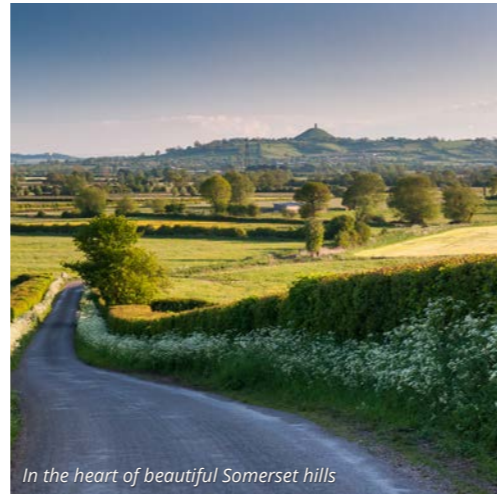

In the heart of beautiful Somerset hills



Glastonbury 19 miles



Stonehenge 27 miles



Private Airfields from 18 miles away



LOCATION

All distances are approximate and straight line, as the crow flies

- Babington House: 0.1 Miles
- Frome: 7 Miles
- Longleat Safari Park: 9 Miles
- Bath: 15 Miles
- Cheddar Gorge: 15 Miles
- Glastonbury: 19 Miles
- Bristol: 25 Miles
- Stonehenge: 27 Miles
- London: 100 Miles
- Bristol Airport: 25 Miles
- London Heathrow: 85 Miles
- London Gatwick: 100 Miles



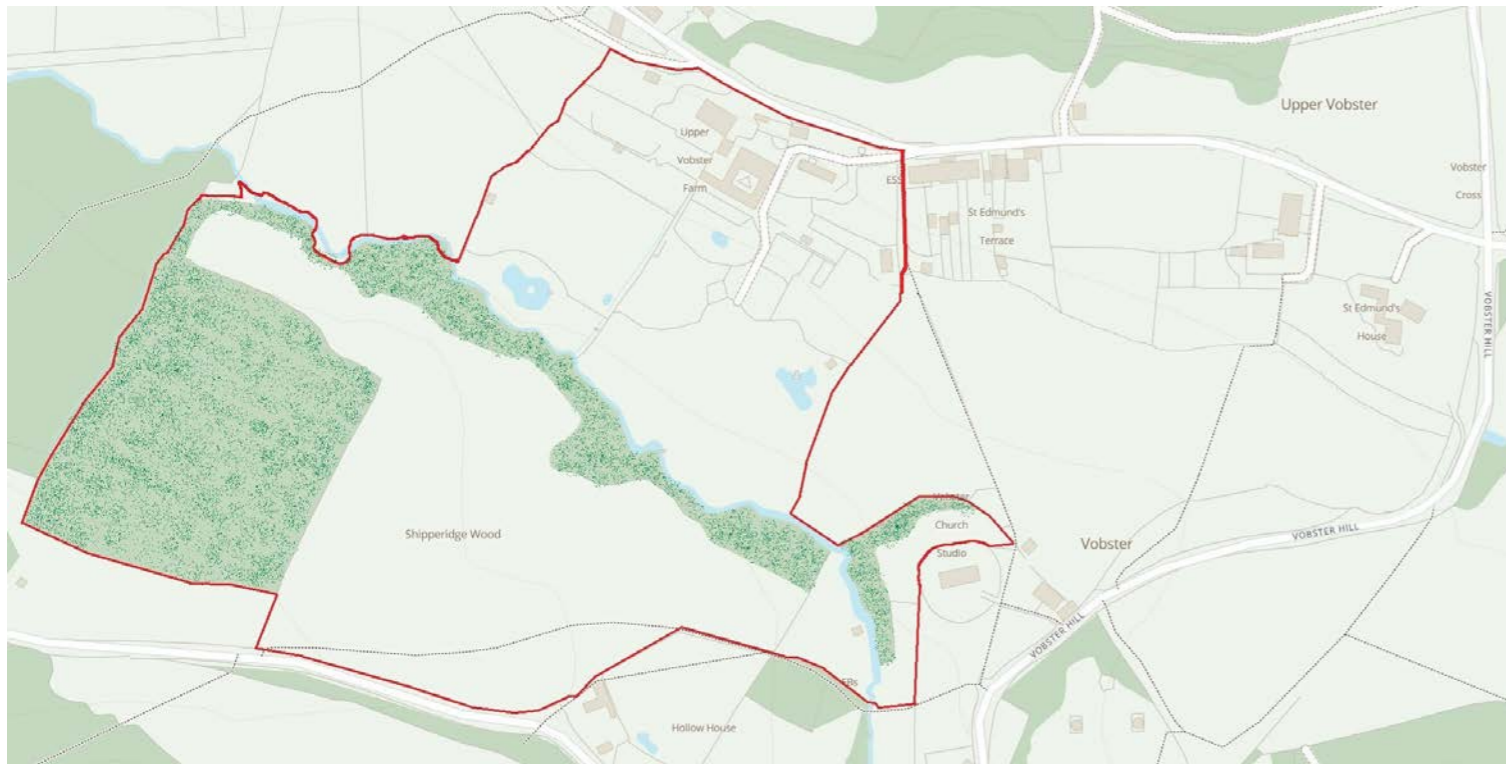

KEY POINTS

- A rare and very private luxury Country Estate
- Set on circa 36 Acres* (circa 14.5 Hectares*)
- Offering over 14,000 Sq Ft
- 13 bedrooms to sleep more than 26 people
- Possibility to acquire an additional 2 bedroom terraced cottage currently available for staff accommodation
- A versatile, residential & successful commercial/ business space
- Luxury Private Spa facilities (Steam room, heated outdoor pool, and lounge area)
- Ample space for Helicopter landing*

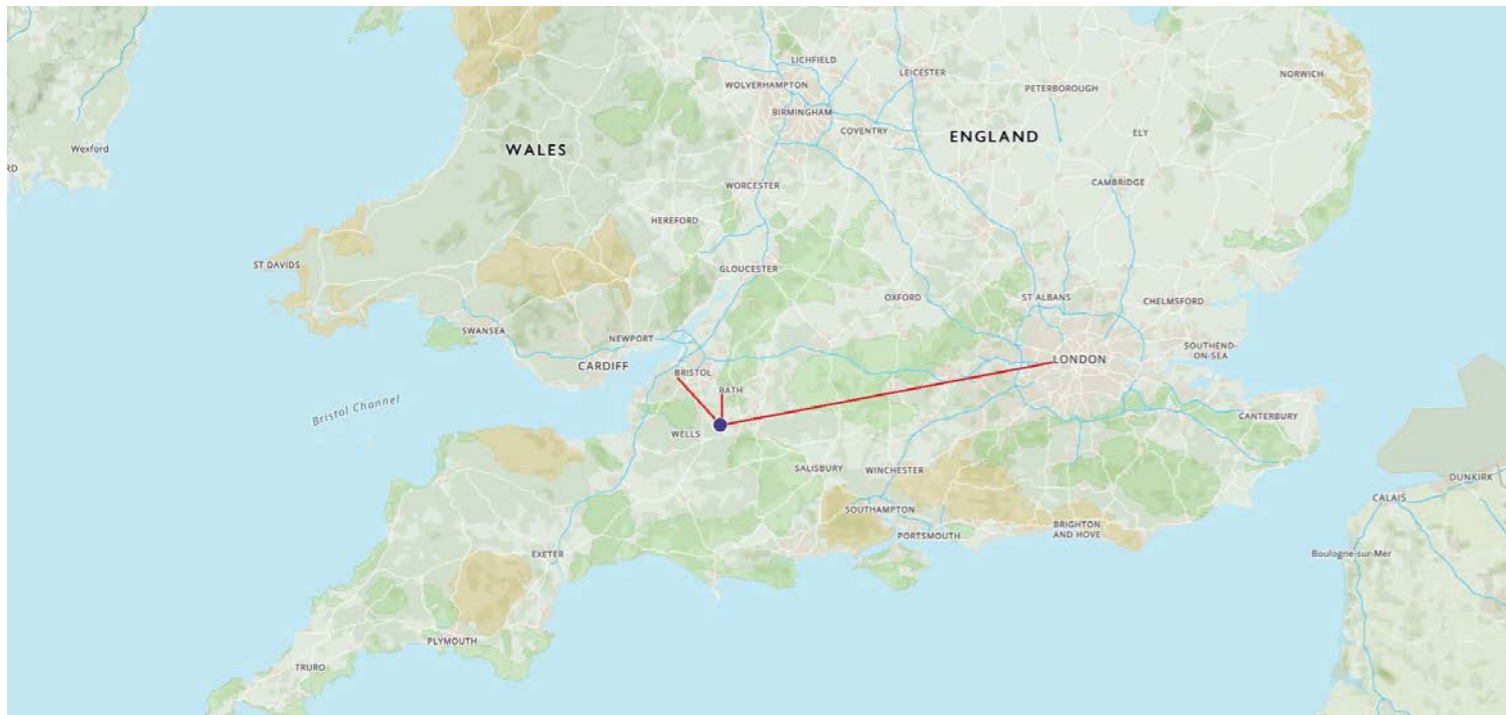

FLOOR PLANS

The Farmhouse, Upper Vobster Farm



Cherry Tree Cottage, Upper Vobster Farm



Machinery Barn - Upper Vobster Farm



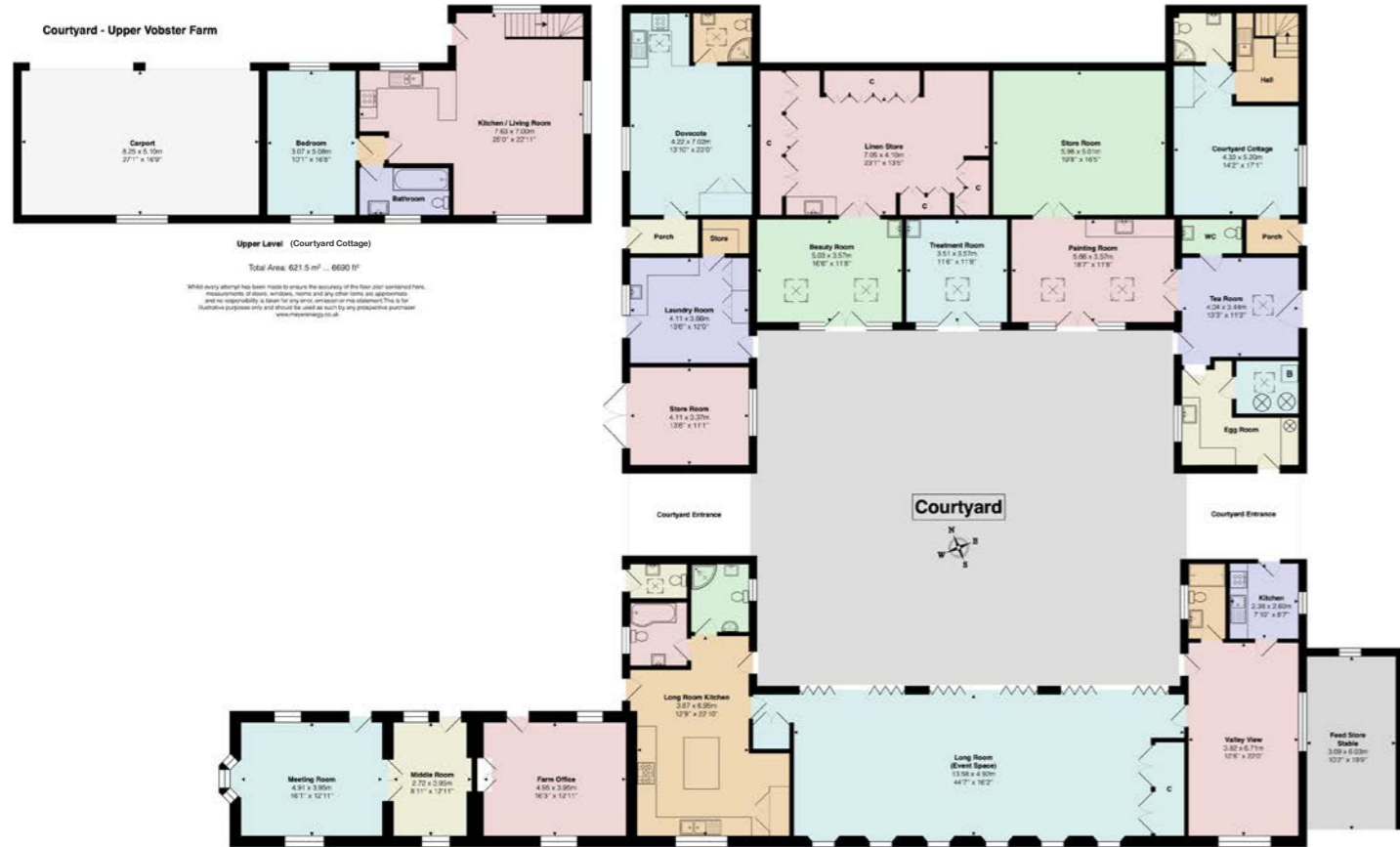

5 Self Catering Cottages - Upper Vobster



The Dovecote Area: 32.7 m² ... 352 ft²



Valley View Area: 36.1 m² ... 389 ft²

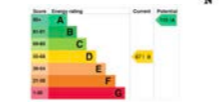

Courtyard Cottage - Upper Level Area: 64.5 m² ... 695 ft²

Whilst every attempt has been made to ensure the accuracy of the floor plan contained here, measurements of doors, windows, rooms and any other items are approximate and no responsibility is taken for any error, omission or mis-statement. This is for illustrative purposes only and should be used as such by any prospective purchaser.
www.meyerenergy.co.uk

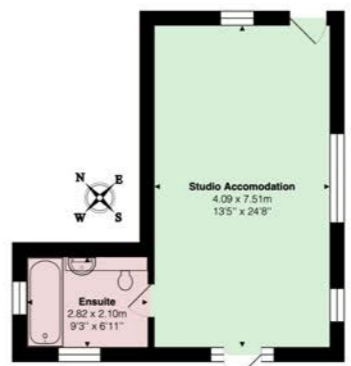

The Dairy Area: 37.0 m² ... 398 ft²



The Stone Barn - Ground Floor Area: 40.4 m² ... 435 ft²



The Stone Barn - 1st Floor Area: 41.0 m² ... 441 ft²

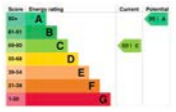

Courtyard Cottage - Lower Level Area: 33.8 m² ... 364 ft²



Mat Weiland

MARLA | ANAEA

Founder & Managing Director | Rivendell Estates
Advisory Panel Member (board) | ARLA Propertymark

M: **07540 587 005**

T: **01225 939 888** (Bath)

E: **mat@rivendell-estates.co.uk**



*Important Notice

1. Privacy: Rivendell Estates have been instructed as the sole selling agents of Upper Vobster Farm. The current owners have requested that all marketing is carried out on a strictly discreet basis, no Internet, web portals and mainstream or social media. Please treat any marketing received for this property confidentially. When forwarding to prospective purchasers, we would ask that you inform them of the current owner's privacy preferences so that an appropriate level of discretion is applied.
2. Particulars: These particulars are not an offer or contract, nor part of one. You should not rely on statements by Rivendell Estates in the particulars or by word of mouth or in writing ("information") as being factually accurate about the property, its condition or its value. Neither Rivendell Estates nor any joint agent has any authority to make any representations about the property. Accordingly, any information given is entirely without responsibility on the part of the agents, seller(s) or lessor(s).
3. Photos etc: The photographs show only certain parts of the property as they appeared at the time they were taken. Areas, measurements, maps, site plans, floor plans and distances given are approximate only.
4. Regulations etc: Any reference to alterations to, or use of, any part of the property does not mean that any necessary planning, building regulations or other consent have been obtained. A buyer or lessee must find out by inspection or in other ways that these matters have been properly dealt with and that all information is correct.
5. VAT: The VAT position relating to the property may change without notice. Rivendell Estates is a limited company registered in England with registered number 11442183. Our registered office is Rivendell Estates, Frome Business Park, Manor Road, Frome, BA11 4FN, where you may look at a list of directors' names.



