



Guide Price
£425,000

Freehold

3x  1x  1x 

**Lucerne Walk, Shotgate,
Wickford, Essex, SS11**

OVER 60?

Secure this property
for up to **59% less!**

 **DOUGLAS
ALLEN**
Helping you move forwards



Main features

- Extended semi-detached bungalow in a popular location
- Beautifully fitted kitchen with breakfast bar area
- Separate dining area
- Large family bathroom
- Off street parking

Accommodation

GROUND FLOOR

Hallway

- Lounge: 13'10 x 10'11 (4.22m x 3.33m)
- Dining Area: 12'6 x 8'0 (3.81m x 2.44m)
- Kitchen: 11'7 x 9'11 (3.53m x 3.02m)
- Bedroom 1: 12'2 x 10'9 (3.71m x 3.28m)
- Bedroom 2: 11'6 x 10'11 (3.51m x 3.33m)
- Bedroom 3: 8'9 x 7'11 (2.67m x 2.41m)
- Bathroom

OUTSIDE

- Rear Garden
- Driveway

Ground Floor

Approx. 80.0 sq. metres (861.0 sq. feet)

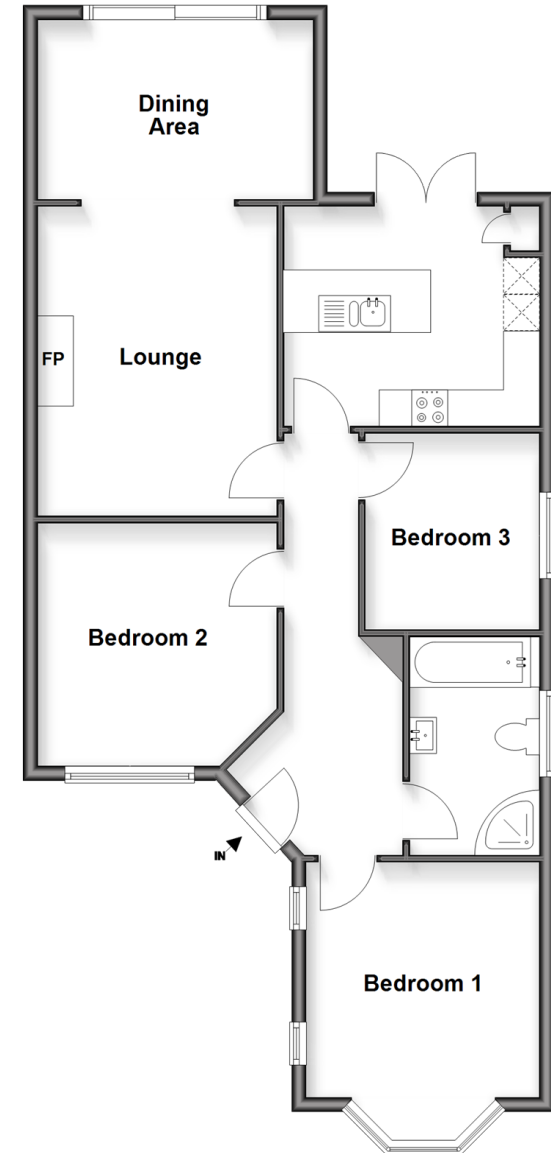

Unable to display material information. Please check with the branch for material information details for this property



53413348/20260418/RP/AH