



Ardonan Farm Ardonan Lane, Ramsey, Isle Of Man, IM7 3HN  
Asking Price £795,000

- Exciting renovation or re-development opportunity
- Consented development opportunity offers detailed planning approval for a unique and substantial residential property
- Traditional farmhouse set in approximately 15 acres of land including pasture and natural boundaries
- Peaceful and private rural location, yet within easy reach of nearby villages and local amenities
- Stunning elevated position offering uninterrupted mountain and countryside views



A rare and exciting opportunity to acquire a traditional farmhouse offering huge potential for renovation or complete re-development in one of the most picturesque and peaceful locations on the Island.

Set within approximately 15 acres of surrounding land, this unique property enjoys an elevated position boasting spectacular panoramic views of the surrounding mountains and countryside. The farmhouse sits within a generous plot, with ample scope to create a truly special rural retreat, family home, or equestrian property.

The existing structure offers a charming layout full of character and traditional features, ready to be restored to its former glory or completely reimagined to suit modern rural living.

The surrounding land, made up of rolling pasture and natural hedgerow boundaries, offers incredible potential for a range of lifestyle uses — including small-scale farming, equestrian facilities, or extended gardens and recreational areas. The land also provides a natural buffer of privacy, enhancing the sense of seclusion and space.

Benefitting from easy access to local amenities and just a short drive to nearby villages and transport links, this location offers the best of both worlds: rural charm with convenient accessibility.

Whether you're seeking a forever family home in the countryside, a high-end self-build project, or an investment opportunity with huge upside, this property is brimming with potential.

Opportunities like this are few and far between — early viewing is highly recommended to appreciate the full scope of what's on offer.







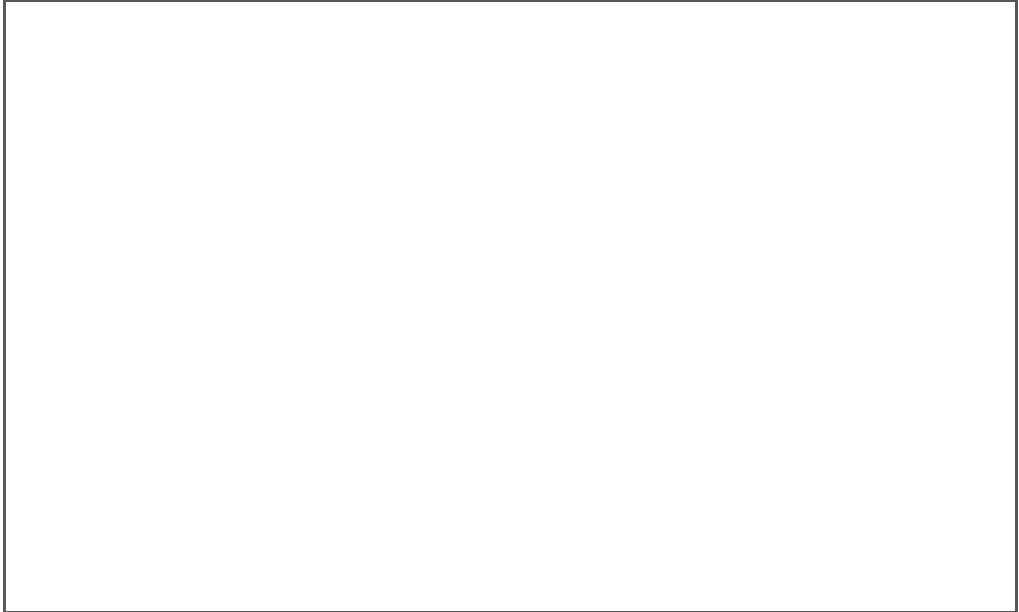
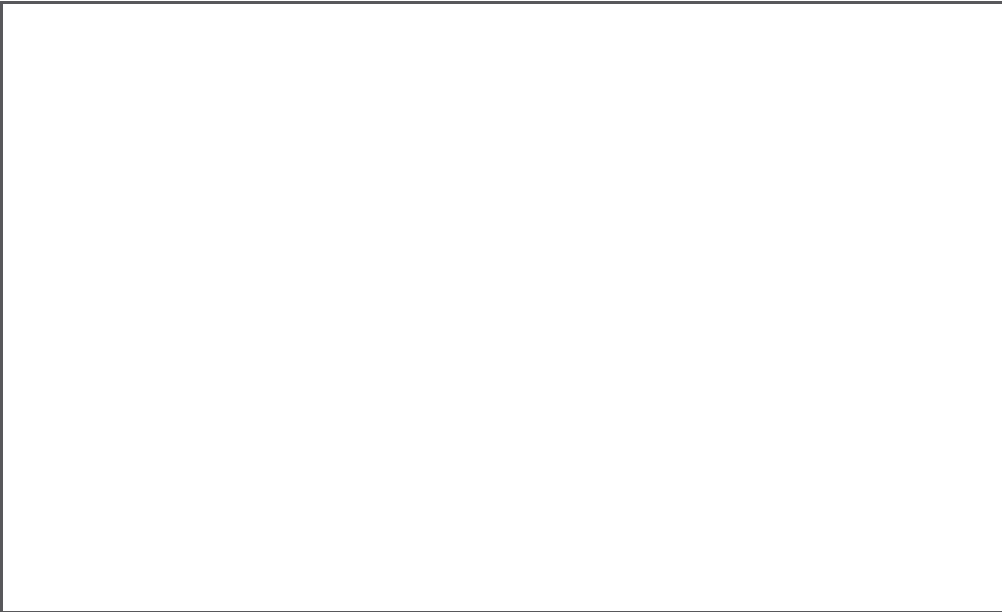
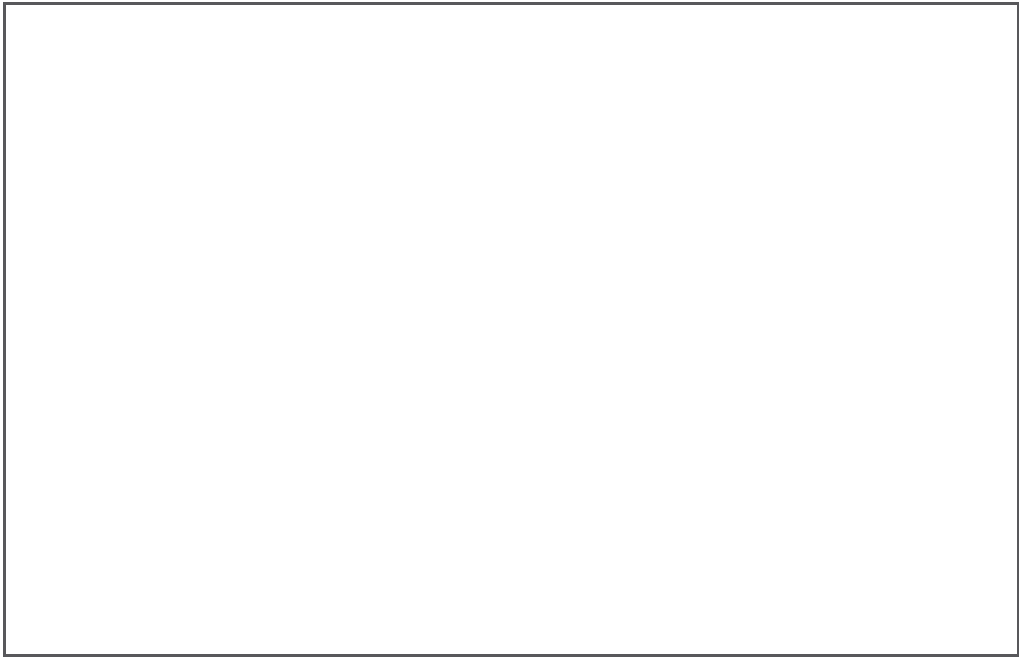



Ardonan Farm Ardonan Lane, Ramsey, Isle Of Man, IM7 3HN

---



Ardonan Farm Ardonan Lane, Ramsey, Isle Of Man, IM7 3HN

---



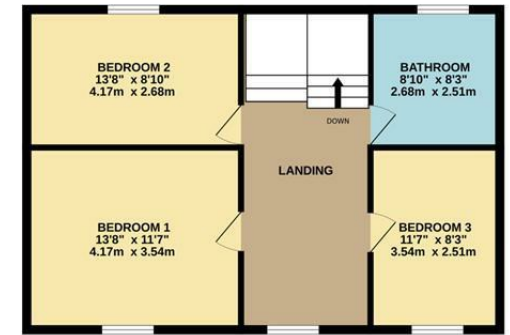

TOTAL FLOOR AREA: 2012 sq.ft. (187.0 sq.m.) approx.  
Not to scale for identification purposes only  
Made with Metropix ©2025

**DOUGLAS**

37 VICTORIA STREET  
DOUGLAS  
ISLE OF MAN IM1 2LF

T 01624 620606

F 01624 677363

E info@deanwood.co.im

**CASTLETOWN**

COMPTON HOUSE  
9 CASTLE STREET CASTLETOWN  
ISLE OF MAN IM9 1LF

T 01624 825995

F 01624 825996

E castletown@deanwood.co.im

**RAMSEY**

LEZAYRE HOUSE  
87 PARLIAMENT STREET  
RAMSEY ISLE OF MAN IM8 1AQ

T 01624 816111

F 01624 816588

E ramsey@deanwood.co.im

These particulars are for information purposes only. They do not constitute or form any contract nor should any statement contained herein be relied upon as a representation of fact. Neither the vendor nor DeanWood Agencies Limited ('the firm'), nor any officer or employee of the firm accept liability or responsibility for any statement contained herein. The vendor does not by these particulars, nor does the firm, nor does any officer or any employee of the firm have any authority to make or give any representation or warranty whatsoever as regards the property or otherwise. It is the sole responsibility of any person interested in the property described in these particulars to make all proper enquiries and searches to verify the description of the property and all other particulars herein.

FOR MORE PROPERTIES VISIT OUR WEBSITE @ [deanwood.im](http://deanwood.im)