



## 59 Harvey Road

Willesborough Ashford, TN24 0AJ

Price £275,000

A pleasantly appointed semi-detached house in the popular Willesborough area, offered for sale with no onward chain. The property would benefit from some modernisation and comprises an inviting hallway, sitting room, dining room, kitchen, three bedrooms and bathroom/WC. A shared driveway leads to a detached garage with an enclosed rear garden. Local schools, shops and transport links are all readily accessible.

### Viewing

Please contact our Ashford Office on 01233 646411 if you wish to arrange a viewing appointment for this property or require further information.

- SEMI DETACHED HOUSE
- THREE BEDROOMS
- TWO RECEPTION ROOMS
- GENEROUS REAR GARDEN
- GARAGE & SHARED DRIVEWAY
- DOUBLE GLAZING & GAS CENTRAL HEATING
- EXCELLENT ACCESS FOR LOCAL SCHOOLS & SHOPS
- NO ONWARD CHAIN



# Floor Plan

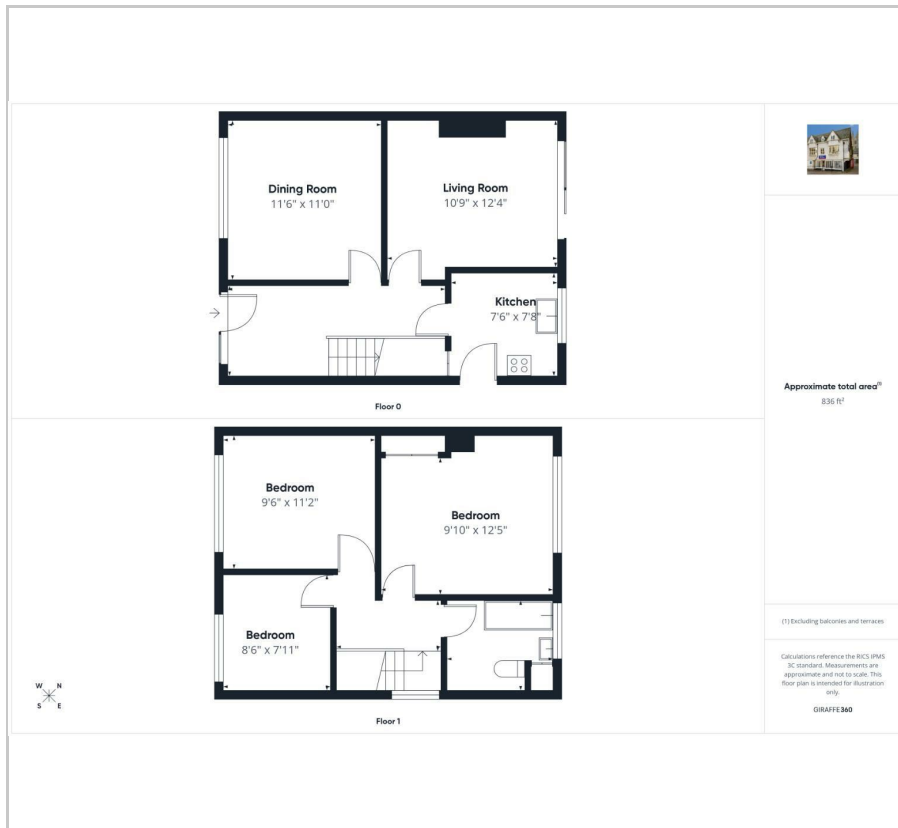

# Area Map



# Energy Efficiency Graph

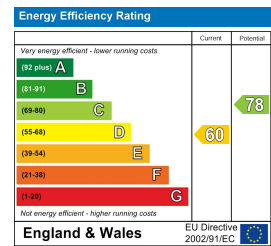

These particulars, whilst believed to be accurate are set out as a general outline only for guidance and do not constitute any part of an offer or contract. Intending purchasers should not rely on them as statements of representation of fact, but must satisfy themselves by inspection or otherwise as to their accuracy. No person in this firm's employment has the authority to make or give any representation or warranty in respect of the property.