



PERFECT PILLARS  
Supporting You



## Flat 404, 18 Dock Street, London, E1 8QW

Asking price £530,000

- Fourth floor one bedroom apartment
- Residents 24 hour concierge and gym and sauna
- Rapid access to the City of London and Canary Wharf
- Fantastic location in vibrant London E1
- Internal area of approximately 498 square feet
- Substantial 250 year lease
- Secure building with Closed Circuit Television and fob access
- High specification kitchen with Siemens appliances
- Excellent links to Tower Hill and the Docklands Light Railway
- Wooden flooring and excellent natural light

400 Thames Valley Park Drive, Reading, Berkshire, RG6 1PT  
01183 048821

info@perfectpillars.co.uk  
<https://www.perfectpillars.co.uk/>

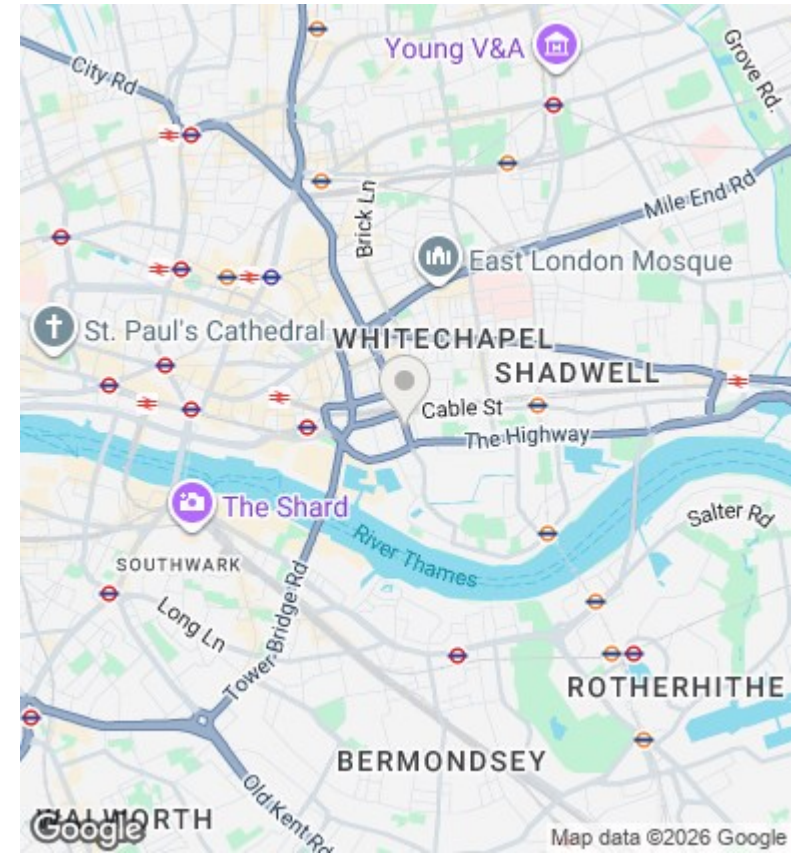
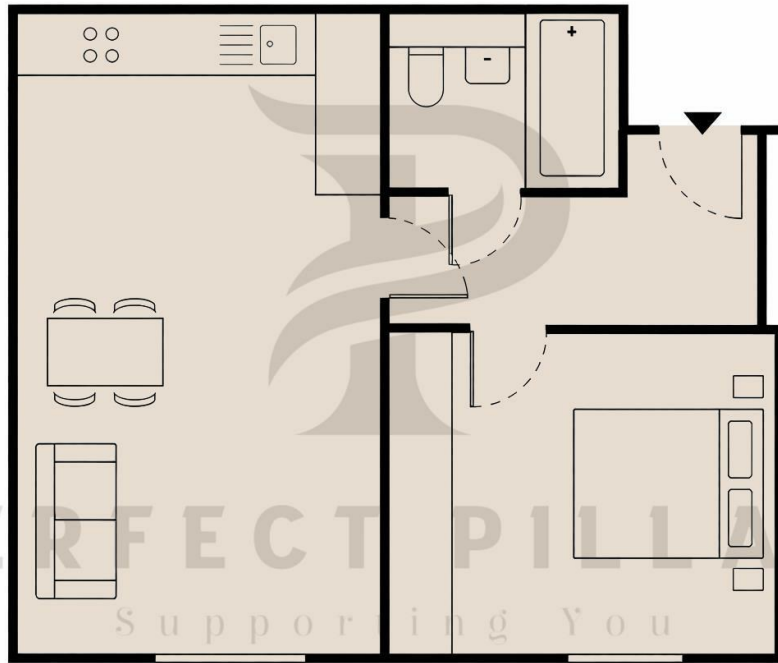

## Directions

## Viewings

Viewings by arrangement only. Call 01183 048821 to make an appointment.

## Council Tax Band

E

## EPC Rating:

B

Energy Efficiency Rating		
	Current	Potential
<i>Very energy efficient - lower running costs</i>		
(92 plus) <b>A</b>		
(81-91) <b>B</b>	<b>81</b>	<b>81</b>
(69-80) <b>C</b>		
(55-68) <b>D</b>		
(39-54) <b>E</b>		
(21-38) <b>F</b>		
(1-20) <b>G</b>		
<i>Not energy efficient - higher running costs</i>		
<b>England &amp; Wales</b>	EU Directive 2002/91/EC	