



 3  1  2

**Abernathan House Heol Laethog, Bryncethin Bridgend**

**£600,000**

 **peter  
alan**

01656 657201  
bridgend@peteralan.co.uk



# About the property

Situated within approximately 1.5 acres of beautifully maintained grounds, with the added benefit of an additional 2.5-acre agricultural field located opposite the property,

Abernathan House is a charming three double-bedroom detached period home offering an excellent blend of character, space and equestrian facilities in a sought-after semi-rural setting.

The accommodation comprises an entrance hall, two spacious reception rooms with feature fireplaces, including a lounge with log-burning stove, a generous kitchen/diner, utility room and side porch.

To the first floor are three double bedrooms and a stylish family bathroom fitted with a contemporary four-piece suite.

Externally, the property benefits from substantial gardens, a gated driveway providing ample off-road parking, and a range of useful outbuildings. Equestrian facilities include a livery yard, storage area, two stables, a foaling box and a tack room.

The additional 2.5-acre field offers further grazing or lifestyle potential, bringing the total land included to approximately 4 acres.

Combining character, versatility and excellent outdoor space, Abernathan House presents a rare opportunity to acquire a unique family home with outstanding equestrian and countryside appeal.

# Accommodation

## Entrance Hall

## Reception Room

13' 9" x 12' 10" ( 4.19m x 3.91m )

A bright and inviting front-facing reception room, full of character and charm. A large sash-style window floods the space with natural light, creating a warm and welcoming atmosphere. The room features attractive wood-effect flooring, high ceilings with decorative coving, and a recessed fireplace housing a wood-burning stove, providing a cosy focal point. There is ample space for a range of lounge furniture, while built-in shelving enhances both practicality and display opportunities. An ideal space for relaxing or entertaining guests.

## Reception/Dining Room

13' 9" x 6' 6" ( 4.19m x 1.98m )

A charming and versatile front-facing reception room, currently utilised as a comfortable sitting room but equally suited as a formal dining room. The room enjoys excellent natural light from a large sash-style window overlooking the front aspect and features high ceilings with decorative coving, dado rail detailing and attractive wood-effect flooring. A feature fireplace provides a focal point to the room, creating a warm and inviting atmosphere, while generous proportions allow ample space for a dining suite or additional lounge furniture. An elegant room ideal for formal entertaining, family gatherings or flexible day-to-day living.

## Kitchen/Diner

14' 9" x 10' 2" ( 4.50m x 3.10m )

A spacious and well-appointed kitchen/breakfast room fitted with an





extensive range of matching wall and base units complemented by ample work surface space. The room provides excellent space for informal dining and family gatherings, with a large window allowing plenty of natural light to fill the space. The kitchen benefits from tiled flooring, recessed ceiling lighting and designated spaces for appliances, together with a range-style cooker set within a feature recess. An additional door provides convenient access to the side porch and side of the property.

### Utility Room

9' 10" x 8' 2" ( 3.00m x 2.49m )

Conveniently positioned directly off the kitchen, this practical utility room continues the tiled flooring and complementary cabinetry, creating a seamless flow between the two spaces. Fitted with matching wall and base units together with additional worktop space, the room housing the wall mounted combi boiler and offers excellent storage and laundry facilities with space for further appliances. A window provides natural light, while the generous proportions allow for a variety of household uses, making this a highly functional and valuable extension of the kitchen area.

### Side Porch



### First Floor

#### Landing

#### Bedroom One

16' 5" max x 14' 1" max ( 5.00m max x 4.29m max )

A spacious and elegant principal bedroom enjoying a bright front-facing aspect through two large sash-style windows, which flood the room with natural light and provide attractive views. The room offers ample space to accommodate a king-size bed and a range of freestanding bedroom furniture, whilst high ceilings with decorative coving enhance the sense of space and character. Finished with fitted carpeting for added comfort.

#### Bedroom Two

13' 1" max x 11' 6" max plus wardrobe recess ( 3.99m max x 3.51m max plus wardrobe recess )

A generously sized double bedroom enjoying a pleasant side-facing aspect through a large window, allowing plenty of natural light to enter the room. Well-proportioned throughout, the room offers ample space for a double or king-size bed together with a range of additional bedroom furniture. Further benefits include fitted carpeting, decorative coving and built-in wardrobes providing excellent storage. A bright and



comfortable bedroom, ideal for family members or guests.

#### Bedroom Three

13' 9" x 8' 6" ( 4.19m x 2.59m )

A spacious double bedroom benefiting from a front-facing window that fills the room with natural light and provides pleasant outlooks. Well-proportioned throughout, the room offers ample space for a double bed alongside a range of additional bedroom furniture. Further features include fitted carpeting and neutral décor, creating a bright and comfortable space suitable for a variety of needs. A generously sized bedroom ideal for family members, guests or as a flexible home-working space if required.

#### Bathroom

A beautifully appointed and generously proportioned family bathroom fitted with a contemporary white suite comprising a panelled bath, low-level WC, vanity wash hand basin and a large walk-in shower enclosure with glazed screen. The room is enhanced by modern wall finishes and stylish flooring, creating a bright and modern feel throughout. A window allows for natural light and ventilation, while the spacious layout provides both comfort and practicality.





01656 657201

bridgend@peteralan.co.uk

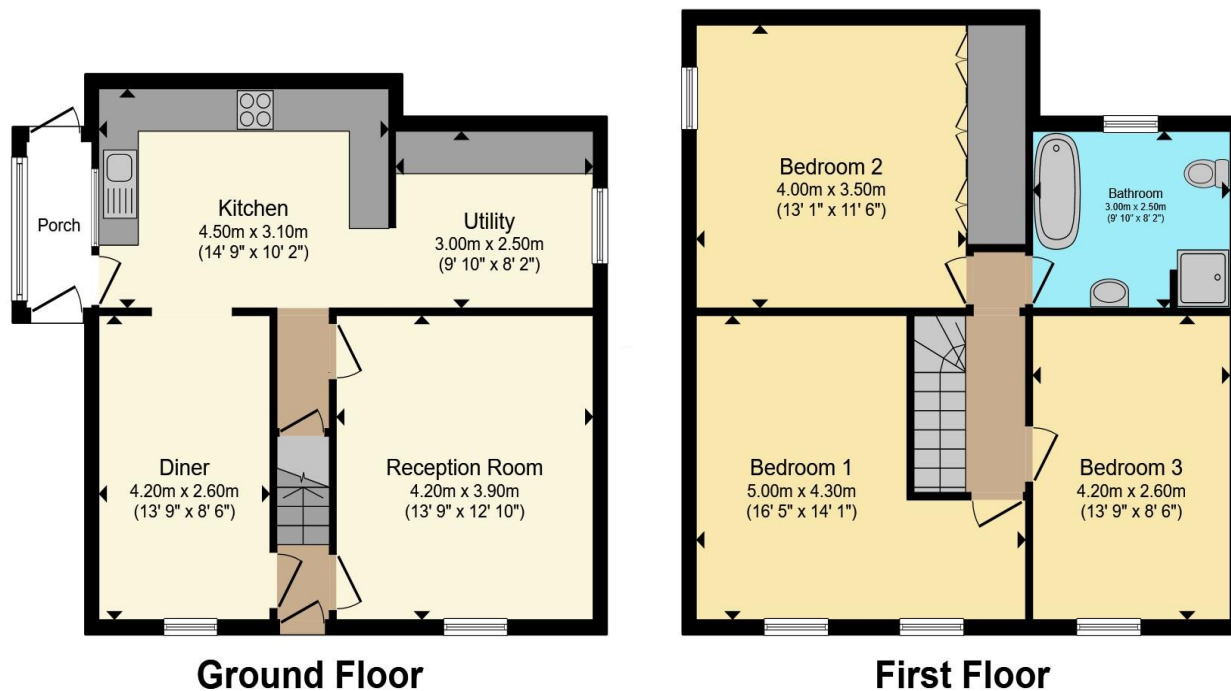

Total floor area 117.8 m<sup>2</sup> (1,268 sq.ft.) approx

This floor plan is for illustrative purposes only. It is not drawn to scale. Any measurements, floor areas (including any total floor area), openings and orientation are approximate. No details are guaranteed, they cannot be relied upon for any purpose and they do not form part of any agreement. No liability is taken for any error, omission or misstatement. A party must rely upon its own inspection(s). Powered by [www.propertybox.io](http://www.propertybox.io)



## Important Information

Note while we endeavour to make our sales details accurate and reliable, if there is any point which is of particular interest to you, please contact the office and we will be pleased to confirm the position for you. We have not personally tested any apparatus, equipment, fixtures, fittings or services and cannot verify they are in working order or fit for their purposes. Nothing in these particulars is intended to indicate that carpets or curtains, furnishings or fittings, electrical goods (whether wired or not), Gas fires or light fittings or any other fixtures not expressly included form part of the property offered for sale. This computer generated Floorplan, if applicable, is intended as a general guide to the layout and design of the property. It is not to scale and should not be relied upon for dimensions. Tenure: We cannot confirm the tenure of the property as we have not had access to the legal documents. The buyer is advised to obtain verification from their solicitor or surveyor.

Peter Alan Limited is registered in England and Wales under company number 2073153, Registered Office is Cumbria House, 16-20 Hockliffe Street, Leighton Buzzard, Bedfordshire, LU7 1GN. VAT Registration Number is 500 2481 05. For activities relating to regulated mortgages and non-investment insurance contracts, Peter Alan Limited is an appointed representative of Connells Limited which is authorised and regulated by the Financial Conduct Authority. Connells Limited's Financial Services Register number is 302221. Most buy-to-let mortgages are not regulated.

