



# 143 Cusworth Lane

Cusworth, Doncaster, DN5 8JN

## Asking Price £225,000

Situated on the desirable Cusworth Lane in Doncaster, this charming semi-detached house presents an excellent opportunity for families and professionals alike. With three well-proportioned bedrooms, this property offers ample space for comfortable living. The inviting open plan lounge/dining room serves as a perfect gathering space, ideal for both relaxation and entertaining guests. One of the standout features of this property is the generous parking space, accommodating up to three vehicles, which is a rare find in such a sought-after location.

Offered for sale with NO ONWARD CHAIN and Situated close to a variety of amenities, motorway connections and reputable schools this property is an ideal choice for families, early viewing is highly recommended.

- Semi detached house
- Three bedrooms
- Open plan lounge/dining room
- Modern fitted kitchen
- Family bathroom with white suite
- Ample off road parking and detached garage
- Front and rear enclosed gardens
- Close to local amenities, reputable schools and motorway connections
- No onward chain
- Early viewing is highly recommended

### Viewing

Please contact our Office on 01302 751616 if you wish to arrange a viewing appointment for this property or require further information.





Floor Plan

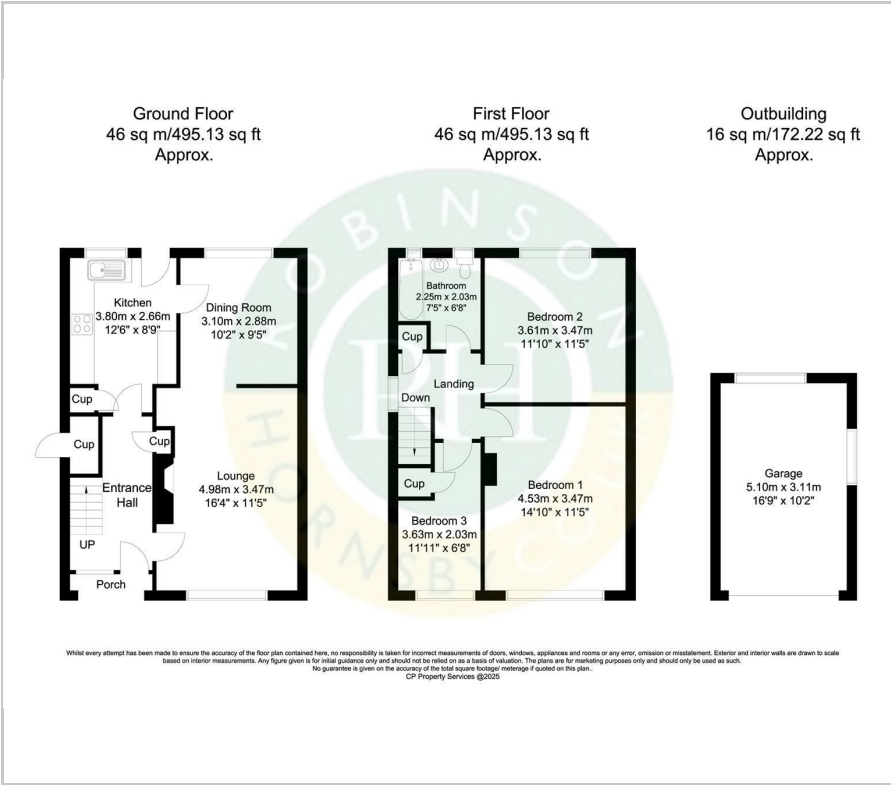

Area Map



Energy Efficiency Graph

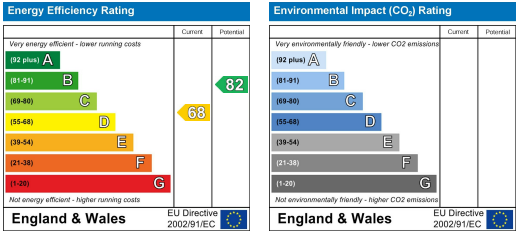

These particulars, whilst believed to be accurate are set out as a general outline only for guidance and do not constitute any part of an offer or contract. Intending purchasers should not rely on them as statements of representation of fact, but must satisfy themselves by inspection or otherwise as to their accuracy. No person in this firms employment has the authority to make or give any representation or warranty in respect of the property.