



Elizabeth Avenue, North Hykeham

£995 Per Month

MARTIN&CO

Elizabeth Avenue, North
Hykeham

House - Mid Terrace
3 Bedrooms, 3 Bathroom

£995 Per Month

Date Available: 14th September
2026

Deposit: £1,440

- Popular Location
- Close to Local Amenities
- Recently Refurbished
- Spacious Accommodation
- Plentiful Storage
- Rear Garden
- Parking Available
- Long Term Tenancy Available
- EPC Rating - C
- Council Tax Band - A

Three bedroom terraced home recently refurbished, situated just off Lincoln Road in North Hykeham being close to local amenities to include schooling. Comprising internally of an entrance porch, lounge, modern kitchen diner, cloakroom and store room, three good sized bedrooms and a family bathroom.



Three bedroom terraced home situated just off Lincoln Road in North Hykeham being close to local amenities to include schooling. Comprising internally of an entrance porch, lounge, modern kitchen diner, cloakroom and rear store room, three good sized bedrooms and a family bathroom. Enclosed rear garden and parking available to the front and rear.

Council Tax - North Kesteven District Council - A
 EPC - C

Mobile (based on calls indoors)
 O2 EE Three Vodafone

Broadband (estimated speeds)
 Standard 5 mbps
 Superfast 52 mbps
 Ultrafast 1000 mbps

Satellite & Cable TV Availability
 BT Sky Virgin Media



Energy Efficiency Rating		
	Current	Potential
Very energy efficient - lower running costs		
(92 plus) A		
(81-91) B		
(69-80) C		
(55-68) D		
(39-54) E		
(21-38) F		
(1-20) G		
Not energy efficient - higher running costs		
		87
	73	
England & Wales	EU Directive 2002/91/EC	

Environmental Impact (CO ₂) Rating		
	Current	Potential
Very environmentally friendly - lower CO ₂ emissions		
(92 plus) A		
(81-91) B		
(69-80) C		
(55-68) D		
(39-54) E		
(21-38) F		
(1-20) G		
Not environmentally friendly - higher CO ₂ emissions		
England & Wales	EU Directive 2002/91/EC	

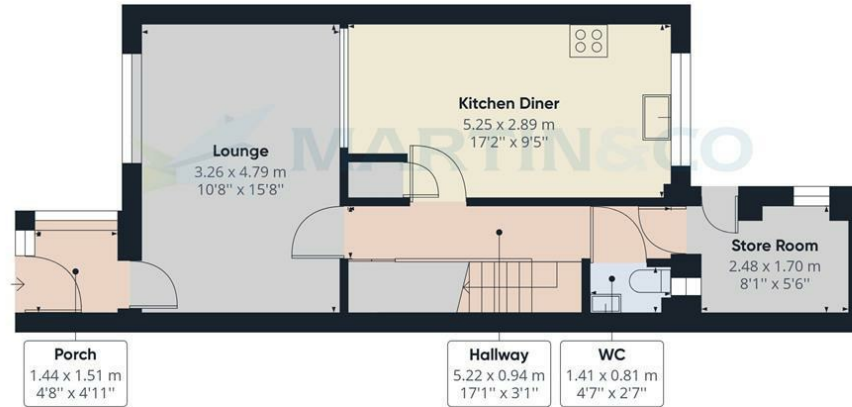

Floor 0

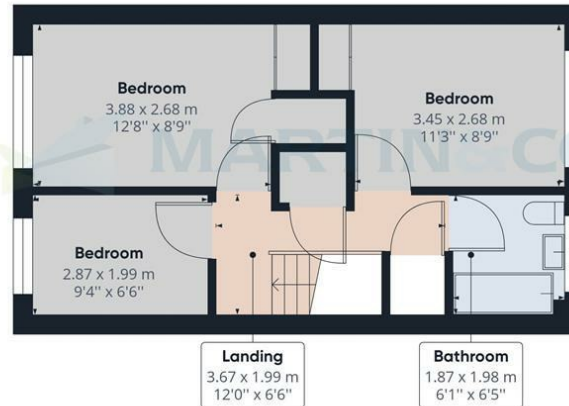

Floor 1

Approximate total area⁽¹⁾
83.77 m²
901.68 ft²

(1) Excluding balconies and terraces

While every attempt has been made to ensure accuracy, all measurements are approximate, not to scale. This floor plan is for illustrative purposes only.

GIRAFFE 360

Martin & Co Lincoln Lettings
33 The Forum, North Hykeham, Lincoln, Lincolnshire, LN6
8HW
01522 503727 . lincoln@martinco.com

01522 503727
<http://www.martinco.com>



Accuracy: References to the Tenure of a Property are based on information supplied by the Seller. The Agent has not had sight of the title documents. A Buyer is advised to obtain verification from their Solicitor. Items shown in photographs including but not limited to carpets, fixtures and fittings are not included unless specifically mentioned within the sales particulars. They may however be available by separate negotiation. Buyers must check the availability of any property and make an appointment to view before embarking on any journey to see a property. No person in the employment of the agent has any authority to make any representation about the property, and accordingly any information given is entirely without responsibility on the part of the agents, sellers(s) or lessors(s). Any property particulars are not an offer or contract, nor form part of one. **Sonic / laser Tape:** Measurements taken using a sonic / laser tape measure may be subject to a small margin of error. **All**

Measurements: All Measurements are Approximate. **Services Not tested:** The Agent has not tested any apparatus, equipment, Fixtures and Fittings or services and so cannot verify that they are in working order or fit for the purpose. A Buyer is advised to obtain verification from their Solicitor or Surveyor.