



Tintern Street, SW4

£2,400 Per calendar month

This ground floor, two bedroom garden flat offers a reception room with wooden flooring, a separate kitchen, original features throughout and a private patio garden to the rear of the property.

Tintern Street is well placed within the Clapham North Triangle giving you fantastic access to both Clapham High Street and Brixton's transport links.

Features

- Two Double Bedrooms
- Private Patio Garden
- Separate Kitchen
- Modern Bathroom
- Large Reception
- Prime Location

Tintern Street, London, SW4

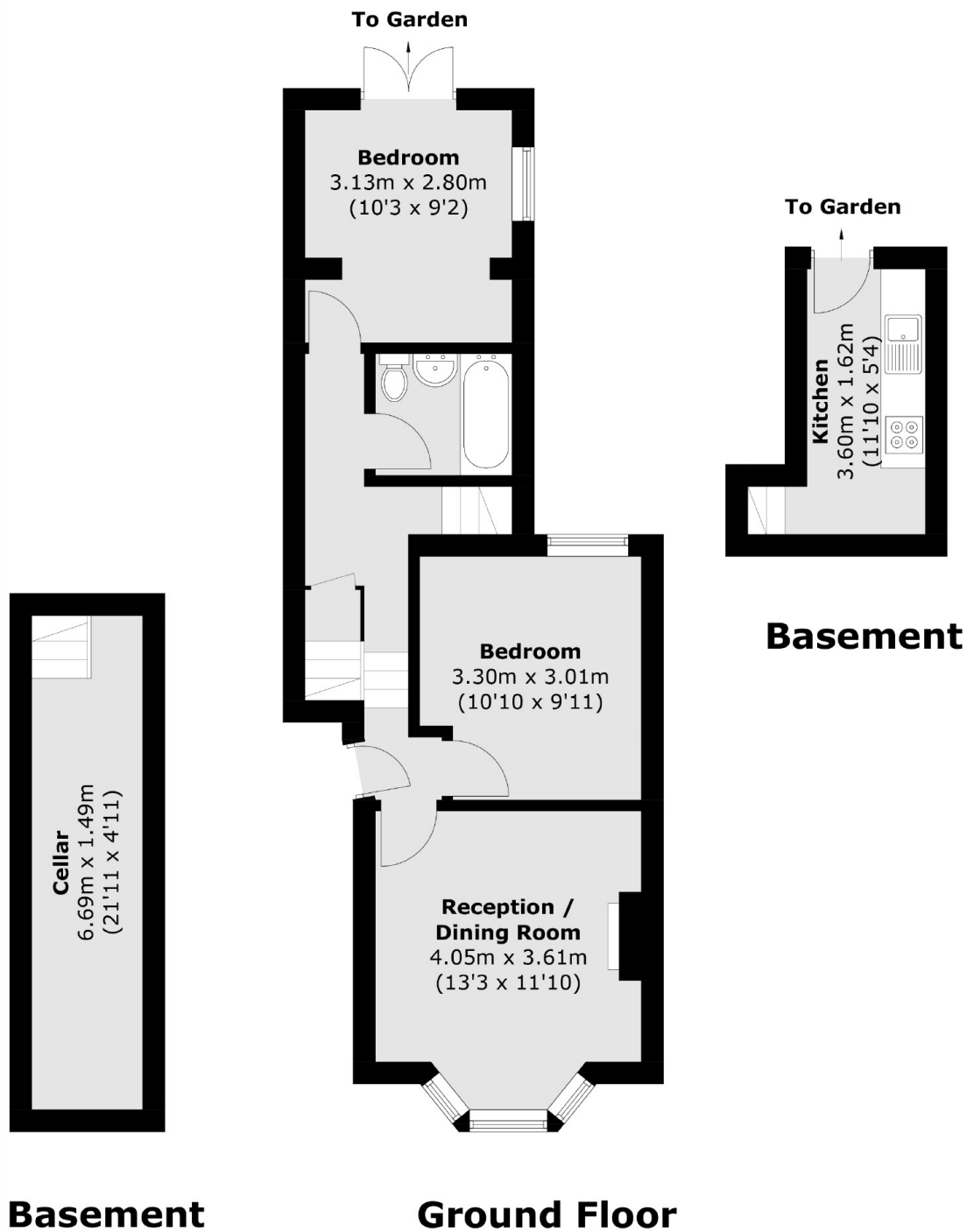

Total area (approx.): 61.3 sq. m (659.8 sq. ft)

Dexters

Clapham High Street
55 Clapham High Street
London
SW4 7TG
Lettings
020 7483 6364

Energy Rating: D. We aim to make our particulars both accurate and reliable. However they are not guaranteed; nor do they form part of an offer or contract. If you require clarification on any points then please contact us, especially if you're traveling some distance to view. Please note that appliances and heating systems have not been tested and therefore no warranties can be given as to their good working order.

 **RICS** | Regulated
Estate Agent
and Letting Agent

dexters.co.uk