



12 Cornhill Grove, Kenilworth, CV8 2QP

£650 PCM

- Ground Floor Studio Apartment
- EPC Rating D
- Bathroom with Shower
- Available 22nd May 2026
- Open Plan Lounge/Studio
- Electric Heating & Double Glazing
- Cul De Sac Location
- Fitted Kitchen with Appliances
- Allocated Parking Bay
- Furnished

Ground Floor

Approx. 26.0 sq. metres

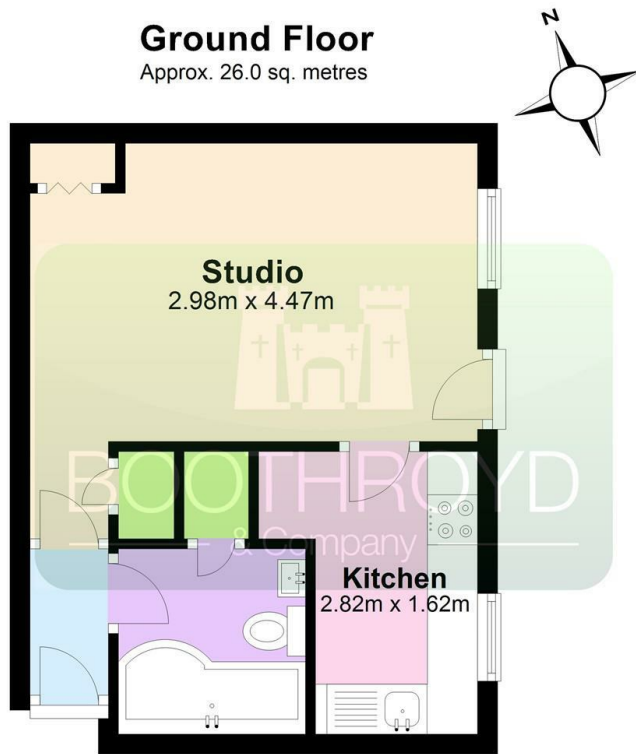

Total area: approx. 26.0 sq. metres

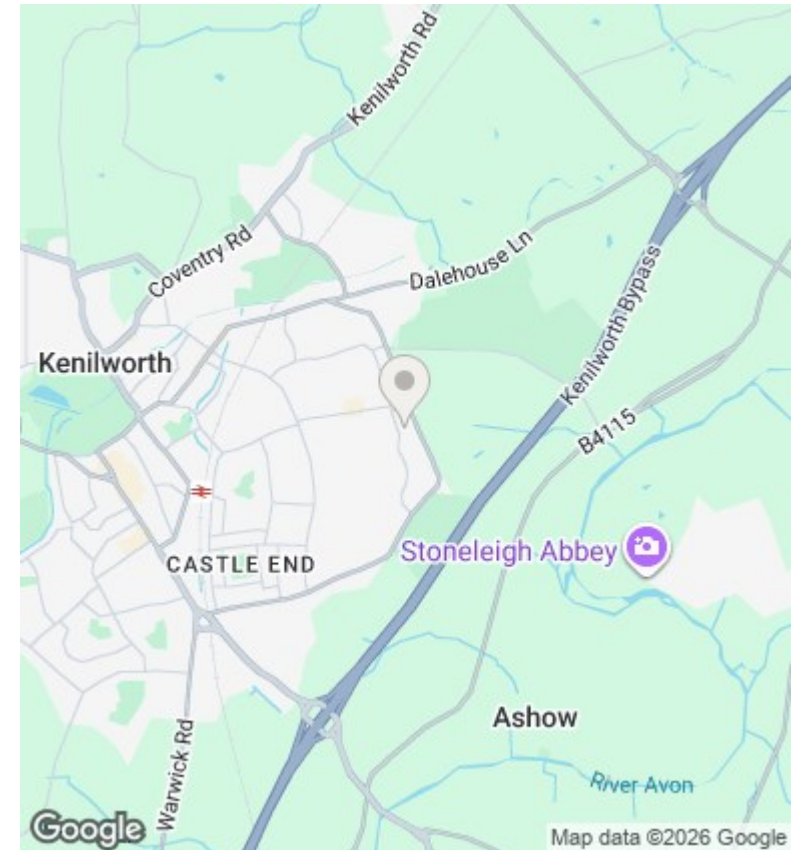

Directions

Viewings

Viewings by arrangement only. Call 01926 857244 to make an appointment.

Council Tax Band

A

EPC Rating:

D

Energy Efficiency Rating		Current	Potential
<i>Very energy efficient - lower running costs</i>			
(92 plus) A			
(81-91) B			81
(69-80) C			
(55-68) D		68	
(39-54) E			
(21-38) F			
(1-20) G			
<i>Not energy efficient - higher running costs</i>			
England & Wales		EU Directive 2002/91/EC	