



237 Covert Close, Axminster EX13 5GU



welcome to

237 Covert Close, Axminster

Discover the perfect blend of modern luxury & peaceful countryside living with this exceptional brand-new four-bedroom detached home, proudly offered to the market by Fox & Sons & located on the outskirts of the historic market town of Axminster.

Front Garden

Fully timber fence enclosed with timber front gate, paved path leading to front door with outside light and bordered by laid to lawn areas, flowerbeds

Entrance Hallway

Entered via uPVC front door with opaque double glazed panel, uPVC double glazed window to front aspect, built in storage cupboard, doors leading to subsequent rooms, stairs rising to first floor and descending to ground floor, radiator, ceiling light point

Lounge

uPVC double glazed double doors with windows either side to rear aspect leading to balcony with beautiful views to countryside beyond, radiator, ceiling light point

Master Bedroom

uPVC double glazed window to rear aspect with beautiful views to countryside beyond, built in wardrobes, radiator, ceiling light point

En-Suite

uPVC opaque double glazed window to front aspect, shower set within tiled surround, hand wash basin with tiled splashback, low level WC, radiator, spotlights, door to hallway also

Downstairs Inner Hallway

uPVC double glazed window to side aspect on stairs, uPVC door with opaque double glazed panel to front aspect leading to paved path providing access to rear of property from both sides, doors leading to subsequent rooms, radiator, ceiling light point

Kitchen/Dining/Living Area

kitchen area:

Range of contemporary wall and base units with worktop over, integrated electric oven with gas hob and cooker hood over, stainless steel drainer sink, space for dishwasher and fridge/freezer, breakfast bar section with space for bar stools, spotlights

Dining area:

uPVC double glazed double doors to rear aspect leading to garden, uPVC double glazed window to side aspect, radiator, ceiling light points

Living area:

uPVC double glazed double doors to side aspect leading to garden, uPVC double glazed window to rear aspect, radiator, spotlights

Utility

uPVC opaque double glazed window to front aspect, range of base units with worktop over, stainless steel drainer sink, space for washing machine, wall mounted boiler and fuseboard, radiator, ceiling light point

Downstairs WC

uPVC opaque double glazed window to front aspect, hand wash basin with tiled splashback, low level WC, radiator, spotlights

Second Floor Landing

uPVC double glazed window to side aspect on stairs, uPVC double glazed window to front aspect, doors leading to subsequent rooms, loft hatch, radiator, ceiling light point





Bedroom 2

uPVC double glazed double doors with Juliet balcony to rear aspect with beautiful views to countryside beyond, radiator, ceiling light point

Bedroom 3

uPVC double glazed window to rear aspect with beautiful views to countryside beyond, radiator, ceiling light point

Bedroom 4

uPVC double glazed window to front aspect, radiator, ceiling light point

Bathroom

Panel bath with shower over set within tiled surround, hand wash basin with tiled splashback, low level WC, radiator, spotlights

Rear Garden

Fully timber fence enclosed, patio area with paths leading to front of property (ground floor level) - paved one side and gravel the other side, laid to gravel, outside tap

Parking

Three allocated parking spaces to the front of the property and garden



view this property online fox-and-sons.co.uk/Property/AXM105046



welcome to

237 Covert Close, Axminster

- BRAND NEW FOUR BEDROOM DETACHED HOME
- SPACIOUS THREE STORY ACCOMMODATION
- MODERN OPEN PLAN KITCHEN, DINING & LIVING AREA
- SEPARATE LOUNGE WITH BALCONY
- MASTER BEDROOM WITH EN-SUITE & ADDITIONAL BEDROOM WITH JULIET BALCONY

Tenure: Freehold EPC Rating: Exempt

Council Tax Band: Deleted

£375,000

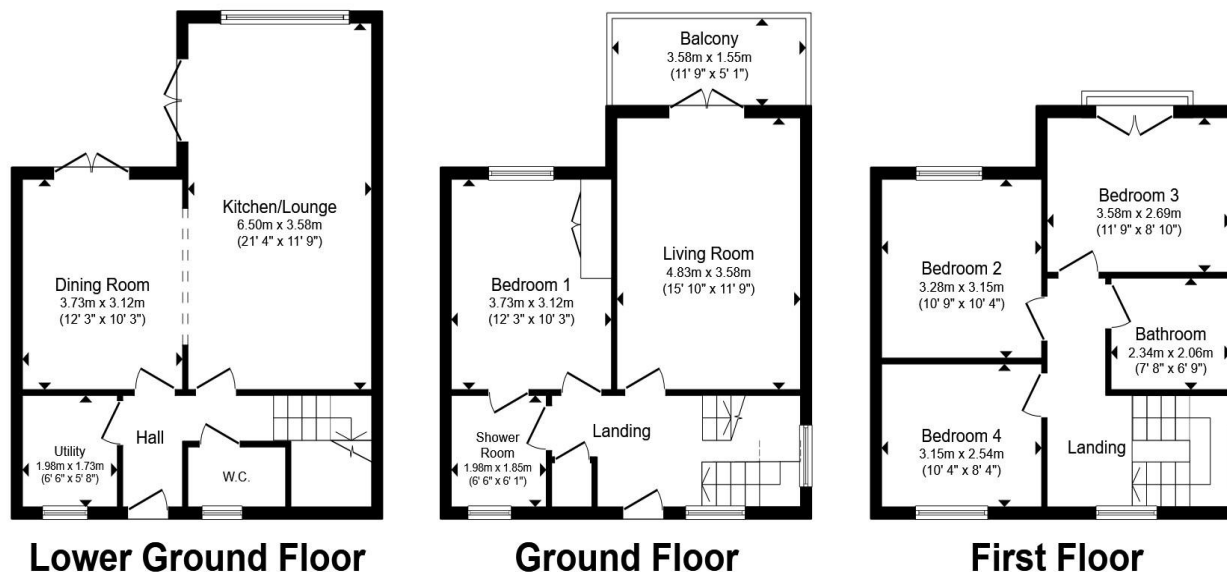

Total floor area 136.4 m² (1,469 sq.ft.) approx

This floor plan is for illustrative purposes only. It is not drawn to scale. Any measurements, floor areas (including any total floor area), openings and orientation are approximate. No details are guaranteed, they cannot be relied upon for any purpose and they do not form part of any agreement. No liability is taken for any error, omission or misstatement. A party must rely upon its own inspection(s). Powered by www.propertybox.io

fox & sons

view this property online fox-and-sons.co.uk/Property/AXM105046



Property Ref:
AXM105046 - 0003

1. MONEY LAUNDERING REGULATIONS Intending purchasers will be asked to produce identification documentation at a later stage and we would ask for your co-operation in order that there is no delay in agreeing the sale. 2. These particulars do not constitute part or all of an offer or contract. 3. The measurements indicated are supplied for guidance only and as such must be considered incorrect. Potential buyers are advised to recheck measurements before committing to any expense. 4. We have not tested any apparatus, equipment, fixtures or services and it is in the buyers interest to check the working condition of any appliances. 5. Where an EPC, or a Home Report (Scotland only) is held for this property, it is available for inspection at the branch by appointment. If you require a printed version of a Home Report, you will need to pay a reasonable production charge reflecting printing and other costs. 6. We are not able to offer an opinion either written or verbal on the content of these reports and this must be obtained from your legal representative. 7. Whilst we take care in preparing these reports, a buyer should ensure that his/her legal representative confirms as soon as possible all matters relating to title including the extent and boundaries of the property and other important matters before exchange of contracts.

fox & sons



01297 32323



axminster@fox-and-sons.co.uk



West Street, AXMINSTER, Devon, EX13 5NU



fox-and-sons.co.uk