



Falmouth Avenue, London, E4 9QS

£1,800 pcm

arley
property

Bedrooms: 2 | **Bathrooms:** 1 | **Receptions:** 1

Date First Available: 20/02/2026

Council Tax Band: C

Deposit: £2,077

Furnishing: Unfurnished

- Two double bedrooms
- Small balcony
- Communal gardens
- Close to Highams park station and lake
- Unfurnished
- Available mid-February

A well-presented top-floor apartment offering two double bedrooms, ideally positioned on Falmouth Avenue in the heart of Highams Park.

A well-presented top-floor apartment offering two double bedrooms, ideally positioned on Falmouth Avenue in the heart of Highams Park.

The property features a bright and spacious reception room, providing an excellent space for relaxing or entertaining, with the added benefit of a small balcony accessed directly from the living area.

The kitchen has been thoughtfully designed with both practicality and style in mind, offering generous worktop space along with a range of wall and base units. A modern bathroom suite completes the accommodation.

Ideally located, the apartment is approximately a 9-minute walk from Highams Park Station, providing direct links to central London.

Highams Park Lake is just a 10-minute walk away, making it perfect for outdoor walks and leisure activities.

Excellent road connections via the A406 and M11 northbound further enhance accessibility.

Available mid-February 2026





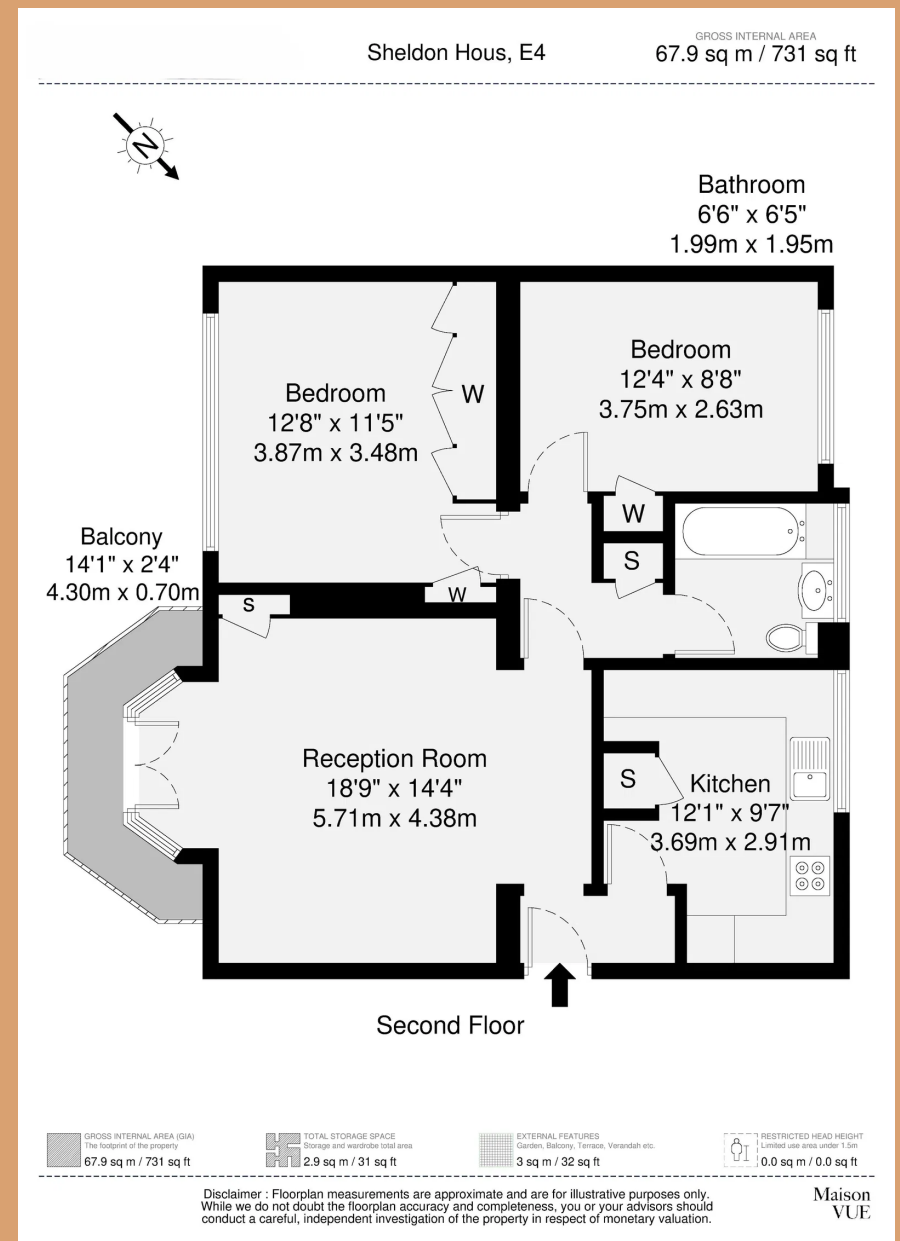
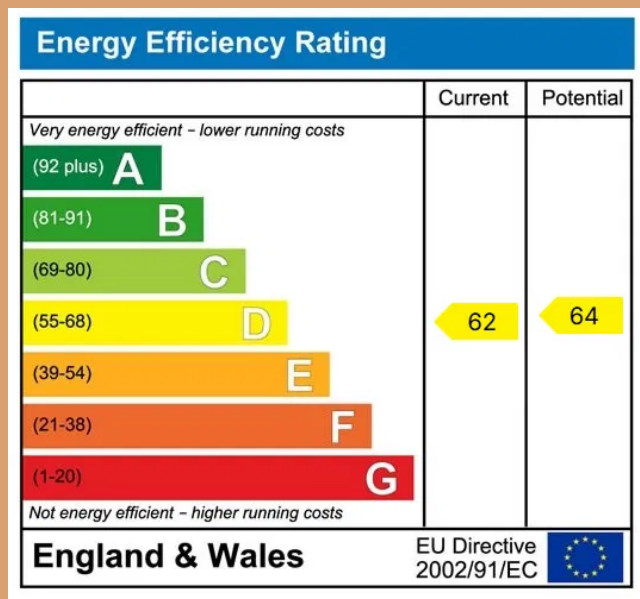

James Marshall

James@arleyproperty.com
07515 448 385

www.arleyproperty.com

arley
property