



## St. Margarets Road, St. Leonards-On-Sea TN37 6FB

Offers in excess of £650,000



This exceptional four storey family home sits elevated above the coastline with UNINTERRUPTED SEA VIEWS and a private balcony which provides an idyllic setting for al fresco dining with the English Channel as a STUNNING COASTAL BACKDROP. Occupying a truly unrivalled position, equidistant between Hastings town centre and the vibrant hub of St Leonards, the property is within easy walking distance of two mainline railway stations, artisan shops, antique stores, independent restaurants and the beach. The accommodation is beautifully presented with a SUBTLE NAUTICAL THEME throughout, enhanced by distinctive porthole-style windows. The VERSATILE LAYOUT places the main living space on the upper floor to maximise the spectacular outlook, featuring a dramatic DOUBLE HEIGHT CEILING and a mezzanine level currently arranged as a sun room or dining area, with BI-FOLDING DOORS OPENING DIRECTLY ON TO THE DECK. The well-proportioned eat-in kitchen offers ample storage and generous worktop space, with room for a full dining table, making it ideal for family life. FOUR DOUBLE BEDROOMS are arranged across the

LOWER FLOOR  
553 sq.ft. (51.2 sq.m.) approx.

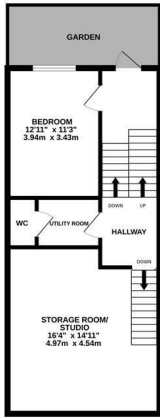

LOWER HALL FLOOR  
266 sq.ft. (24.5 sq.m.) approx.



HALL FLOOR  
470 sq.ft. (43.7 sq.m.) approx.

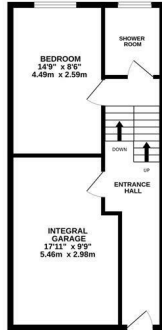

1ST FLOOR  
442 sq.ft. (40.8 sq.m.) approx.



2ND FLOOR  
320 sq.ft. (29.6 sq.m.) approx.



TOTAL FLOOR AREA: 1992 sq.ft. (185.0 sq.m.) approx.

Whilst every attempt has been made to ensure the accuracy of the floorplan contained here, measurements of doors, windows, rooms and any other items are approximate and no responsibility is taken for any error, omission or mis-statement. This plan is for illustrative purposes only and should be used as such by any prospective purchaser. The services, systems and appliances shown have not been tested and no guarantee as to their operability or efficiency can be given.  
Made with Metropix ©2026

