



Victoria Avenue, Market Harborough

Market Harborough

£1,500 pcm

Deposit: £1,730

"An Address and Proportions to Impress"

Situated on the highly sought after road, Victoria Avenue, within close walking distance of the town centre, local canal basin and train station, is this fantastic three bedroom period residence boasts generous proportions, and benefits from being recently decorated throughout.

Prestigious residential location within walking distance of the town centre, local canal basin, the train station and other local amenities. The property also offers convenient access to the A6 and A14.

This fantastic property offers a wealth of charm with features to include timber panelled doors, deep skirting boards, high ceilings, picture rails and sash windows.

Entrance is gained through a charming timber panelled door into an inviting entrance hall featuring quarry tiled flooring, a traditional archway, and stairs rise to the first floor.

Beautifully appointed living room offering a wealth of character with a bay sash window injecting an abundance of natural light, a picture rail and a cast iron fireplace with a quarry tiled hearth and a timber mantle.

Well portioned dining room benefitting from laminate flooring, a feature picture rail, a sash window overlooking the rear garden and a feature fireplace with a quarry tiled hearth and a timber mantle.

The kitchen boasts an array of eye and base level units, a roll top work surface, ceramic wall tiles, a stainless steel one and a half bowl sink, a single oven, a four ring gas hob and space for three under counter appliances. A door leads out to the rear garden and a further door provides access to the utility/boot room.

Off the kitchen is an inner hallway with tiled flooring and access to a store room and a separate guest WC to include a pedestal wash hand basin and a low level WC.

Stairs rise to a generous first floor landing with access to a storage cupboard, three bedrooms and a family bathroom.

Three bedrooms all of which benefit from being double in size all with sash windows and feature fireplaces.





Ground Floor

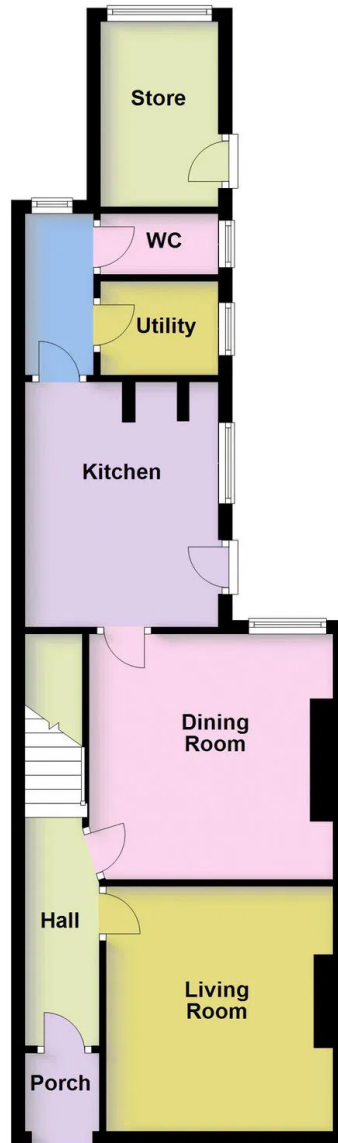

First Floor

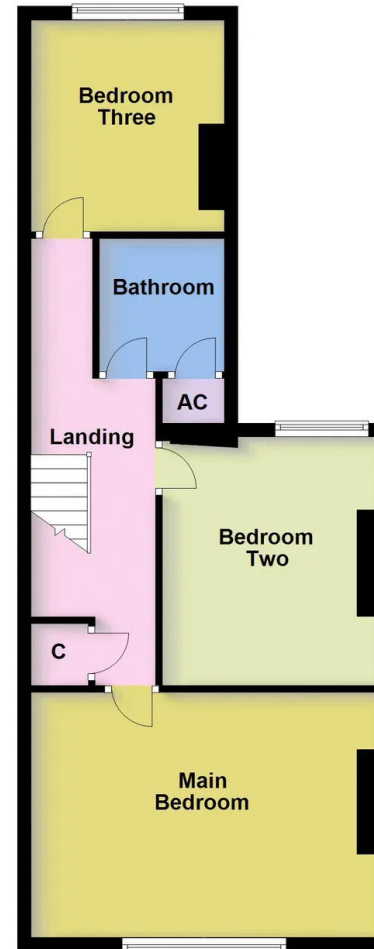

Henderson Connellan Market Harborough office 01858 410 400 | 63 High Street, Market Harborough, Leicestershire, LE16 7AF
marketharboroughsales@hendersonconnellan.co.uk | marketharboroughlettings@hendersonconnellan.co.uk

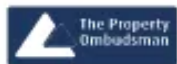

Disclaimer: These particulars do not form part of any offer or contract and should not be relied upon as statements or representations of fact. Any areas, measurements of distances are approximate. The text, photographs and plans are for guidance only and are not necessarily comprehensive.

