



**West Grove, HULL, HU4 6RQ**

**Welcome to**

**West Grove, HULL**

Lovely Home On West Grove with - Entrance Porch, Entrance Hall, Lounge, Fitted Kitchen, Conservatory, 3 Bedrooms (Master With En Suite), Family Bathroom & Ground Floor Cloakroom, Gardens, Off Street Parking & Garage! Book your viewing today!





**Ground Floor**

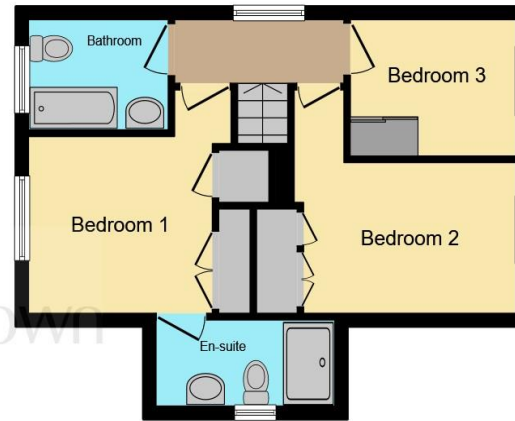

**First Floor**

This floor plan is for illustrative purposes only. It is not drawn to scale. Any measurements, floor areas (including any total floor area), openings and orientation are approximate. No details are guaranteed, they cannot be relied upon for any purpose and they do not form part of any agreement. No liability is taken for any error, omission or misstatement. A party must rely upon its own inspection(s). Powered by [www.focalagent.com](http://www.focalagent.com)

**Entrance Porch**

With double glazed door to the front.

**Entrance Hall**

With door to the front.

**Cloakroom**

With low level wc, wash hand basin and radiator.

**Lounge**

14' 4" x 11' 6" ( 4.37m x 3.51m )

With double glazed window to the front, radiator, television point and double glazed french style doors leading to the Conservatory.

**Kitchen**

9' 9" x 14' ( 2.97m x 4.27m )

Fitted kitchen with a range of wall and base units, work surfaces, sink and drainer unit, central island, gas hob, electric oven, cooker-hood, space for a fridge freezer, plumbing for an automatic washing machine, plumbing for a dishwasher, spot light points, radiator, double glazed window to the front and double glazed french style doors leading to the Garden.

**Conservatory**

11' 2" x 10' 1" ( 3.40m x 3.07m )

With double glazed windows to the front, side and rear, radiator and double glazed door to the side

**First Floor**

**Landing**

With double glazed window to the rear, radiator and loft access.

**Bedroom 1**

11' 3" x 10' 1" ( 3.43m x 3.07m )

With double glazed window to the side, radiator and 2 built in wardrobes.

**En Suite**

En Suite with shower cubicle, low level wc, wash hand basin, chrome effect towel style radiator and double glazed window to the side.

**Bedroom 2**

11' 5" x 11' 1" ( 3.48m x 3.38m )

With double glazed windows to the front and side, radiator and built in wardrobe.

**Bedroom 3**

7' 7" x 6' 3" ( 2.31m x 1.91m )

With double glazed window to the side, radiator and built in wardrobe.

**Bathroom**

Bathroom with bath, vanity wash hand basin, low level wc, chrome effect towel style radiator and double glazed window to the side.

**Outside**

**Front Garden**

With lawned area and hedging and private side driveway providing off street parking.

**Rear Garden**

With lawned area, wall, side access gate and fencing.

**Garage**

Garage with power and up and over door.

## Welcome to

## West Grove, HULL

- Lovely, Detached Home On West Grove
- 3 Bedrooms (Master With En Suite)
- Family Bathroom & Ground Floor Cloakroom
- Off Street Parking & Garage
- 

Tenure: Freehold EPC Rating: C  
Council Tax Band: C

# £220,000



Please note the marker reflects the  
postcode not the actual property

**view this property online** [williamhbrown.co.uk/Property/WBY110962](http://williamhbrown.co.uk/Property/WBY110962)



Property Ref:  
WBY110962 - 0006

1. MONEY LAUNDERING REGULATIONS Intending purchasers will be asked to produce identification documentation at a later stage and we would ask for your co-operation in order that there is no delay in agreeing the sale. 2. These particulars do not constitute part or all of an offer or contract. 3. The measurements indicated are supplied for guidance only and as such must be considered incorrect. Potential buyers are advised to recheck measurements before committing to any expense. 4. We have not tested any apparatus, equipment, fixtures or services and it is in the buyers interest to check the working condition of any appliances. 5. Where an EPC, or a Home Report (Scotland only) is held for this property, it is available for inspection at the branch by appointment. If you require a printed version of a Home Report, you will need to pay a reasonable production charge reflecting printing and other costs. 6. We are not able to offer an opinion either written or verbal on the content of these reports and this must be obtained from your legal representative. 7. Whilst we take care in preparing these reports, a buyer should ensure that his/her legal representative confirms as soon as possible all matters relating to title including the extent and boundaries of the property and other important matters before exchange of contracts.

William H Brown is a trading name of Sequence (UK) Limited which is registered in England and Wales under company number 4268443, Registered Office is Cumbria House, 16-20 Hockliffe Street, Leighton Buzzard, Bedfordshire, LU7 1GN. VAT Registration Number is 500 2481 05.

## Directions to this property:

See below map for property location, for further information on the local area please contact the residential sales team on 01482 653111.



william h brown



**01482 653111**



[Willerby@williamhbrown.co.uk](mailto:Willerby@williamhbrown.co.uk)



10 Kingston Road, Willerby, HULL, East  
Yorkshire, HU10 6BN



[williamhbrown.co.uk](http://williamhbrown.co.uk)