



 paulwallace

● Huntingdon Close, Turnford, EN10 6DR |
£549,995 | Freehold

Huntingdon Close, Turnford, EN10 6DR

This THREE BEDROOM SEMI DETACHED property in the heart of SOUGHT AFTER TURNFORD benefits from multiple reception rooms, a DOWNSTAIRS SHOWER ROOM with an upstairs bathroom. With a family kitchen/breakfast room to the rear with separate utility room opening to a lovely secluded rear garden. With off street parking for several vehicles in addition to the garage and ideally located for transport links and local amenities. Gas central heating and double glazed windows throughout.

Key features

- Three Bedrooms
- Utility Room
- Garage
- Off-Street Parking
- Semi Detached
- Multiple Reception Rooms
- Kitchen/Breakfast Room
- Gas Central Heating

Property Information

Tenure

Freehold

Council Tax

E

EPC Rating

C

Local Authority

Broxbourne Borough Council



Paul Wallace Estate Agents
Brookfield Centre
Cheshunt
Hertfordshire
EN8 0NN

01992 781100

cheshunt@paulwallace.co.uk

www.paulwallace.co.uk

Opening Times

Mon - Fri	9 am to 6:30 pm
Sat	9 am to 5:30 pm
Sun	Closed
Bank Hols	Closed

paulwallace
estate agents

Cheshunts leading estate agent.
Please get in touch for your free
property valuation.



paulwallace





GROUND FLOOR
791 sq.ft. (73.5 sq.m.) approx.

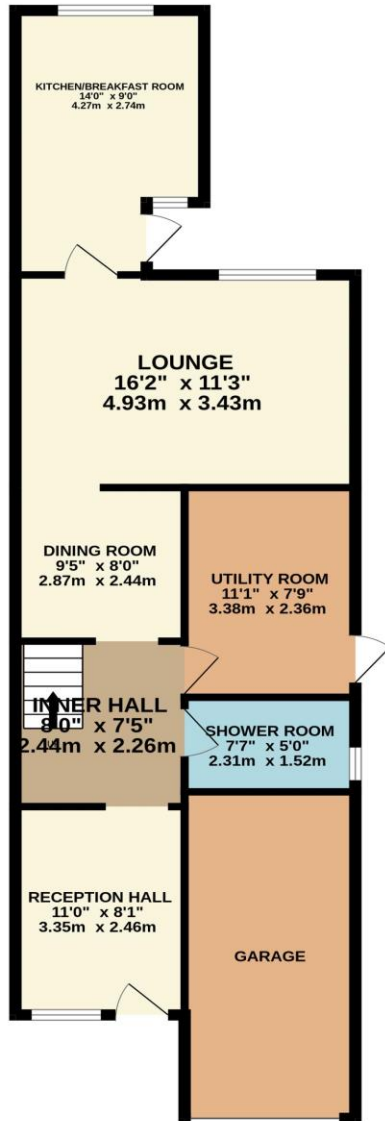

1ST FLOOR
444 sq.ft. (41.2 sq.m.) approx.

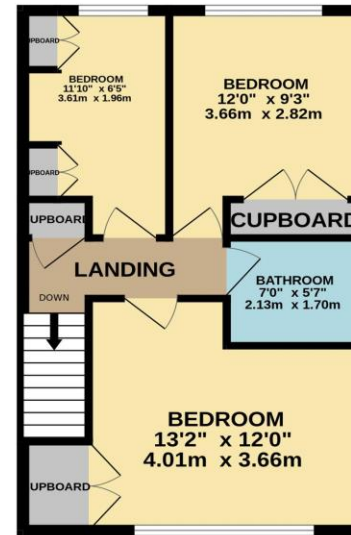

TOTAL FLOOR AREA : 1235 sq.ft. (114.8 sq.m.) approx.

Whilst every attempt has been made to ensure the accuracy of the floorplan contained here, measurements of doors, windows, rooms and any other items are approximate and no responsibility is taken for any error, omission or mis-statement. This plan is for illustrative purposes only and should be used as such by any prospective purchaser. The services, systems and appliances shown have not been tested and no guarantee as to their operability or efficiency can be given.
Made with Metropix ©2023



 paulwallace



 paulwallace



 paulwallace



 paulwallace





Registered Address: Unit 3 The Brookfield Centre, Cheshunt, Herts, EN8 0NN Company Registration Number: OC414280 | VAT Number: 276958046©2022 Paul Wallace Group LLP trading as Paul Wallace Estate Agents



Paul Wallace Estate Agents
 Brookfield Centre
 Cheshunt
 Hertfordshire
 EN8 0NN



01992 781100



cheshunt@paulwallace.co.uk



www.paulwallace.co.uk



Opening Times

Mon - Fri	9 am to 6:30 pm
Sat	9 am to 5:30 pm
Sun	Closed
Bank Hols	Closed



Agents note: Whilst every care has been taken to prepare these sales particulars, they are for guidance purposes only. All measurements are approximate and are for general guidance purposes only and whilst every care has been taken to ensure their accuracy, they should not be relied upon. Potential buyers are advised to recheck measurements.