

Lexham Gardens, W8

£7,500 Per calendar month

A recently refurbished split level three double bedroom apartment, set within a well maintained period building with wood flooring throughout and access to a private garden.

Located between Gloucester Road and Kensington High Street with a wide choice of shops and restaurants including Waitrose, Starbucks and Marks and Spencer's.

Features

- Three Double Bedrooms
- Two Bathrooms
- Private Garden
- Summer House
- Wood Floors
- Recently Refurbished

Lexham Gardens, London, W8

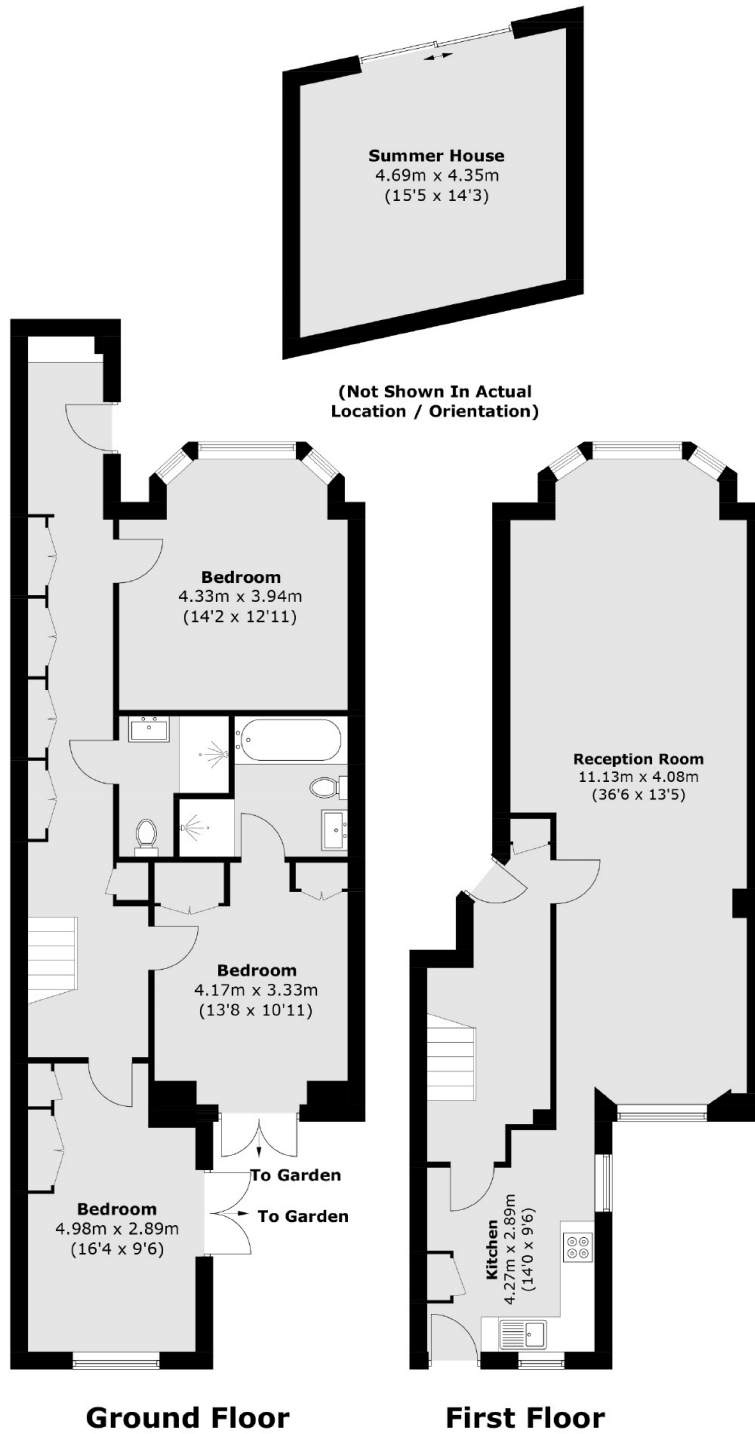

Total area (approx.): 136.1 sq. m (1,464.9 sq. ft)
Summer House: 20.3 sq. m (218.5 sq. ft)