



NESBITT & SONS
ESTATE AGENTS



Park Court Castle Road, Southsea, PO5 3DF
Offers in excess of £175,000

Located in the extremely sought-after Castle Road area of Southsea, this impressive top-floor apartment offers bright and spacious accommodation throughout. The property features an open-plan lounge, dining, and kitchen area, creating a modern and versatile living space that is flooded with natural light. Both the living area and the generously sized bedroom benefit from excellent proportions, enhancing the sense of space and comfort. The apartment is further complemented by a contemporary, modern-fitted bathroom. Additional benefits include an allocated parking space, making this an ideal home for those seeking convenience, style, and a prime Southsea location.

Entrance Hall

Master Bedroom 13'1 x 10'2 (3.99m x 3.10m)



Bathroom 6'7 x 6'3 (2.01m x 1.91m)



Open Plan Living Area 19'8 x 13'1 (5.99m x 3.99m)



Kitchen Area 7'10 x 6'11 (2.39m x 2.11m)



Outside

Allocated Parking Space



Floor Plan

SECOND FLOOR

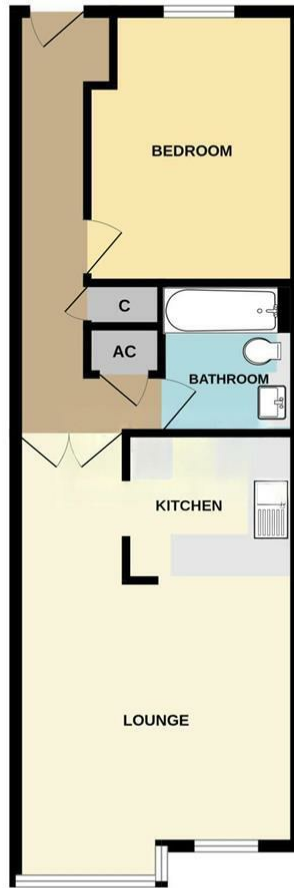

Whilst every attempt has been made to ensure the accuracy of the floorplan contained here, measurements of doors, windows, rooms and any other items are approximate and no responsibility is taken for any error, omission or mis-statement. This plan is for illustrative purposes only and should be used as such by any prospective purchaser. The services, systems and appliances shown have not been tested and no guarantee as to their operability or efficiency can be given.
Made with Metropix ©2024

Area Map

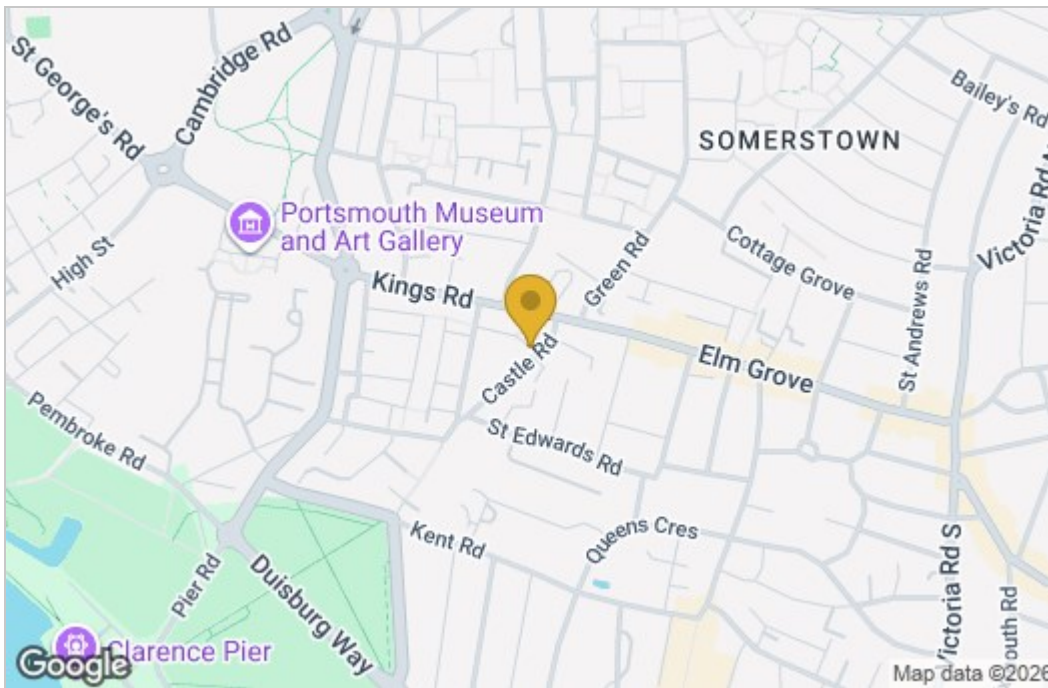

Energy Efficiency Graph

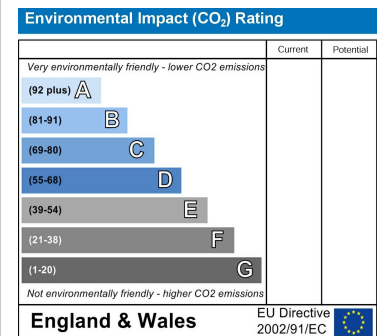
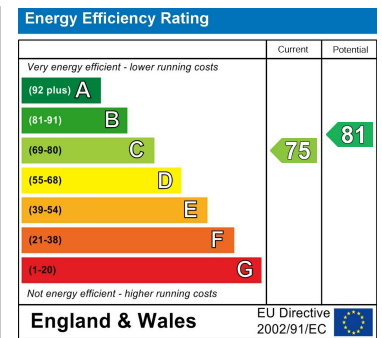

These particulars, whilst believed to be accurate are set out as a general outline only for guidance and do not constitute any part of an offer or contract. Intending purchasers should not rely on them as statements of representation of fact, but must satisfy themselves by inspection or otherwise as to their accuracy. No person in this firm's employment has the authority to make or give any representation or warranty in respect of the property.