



**13 CRICKETERS CLOSE  
CHESSINGTON  
KT9 1NL  
£400,000**

**TERRACED HOUSE**

**THREE BEDROOMS**

**16'2 X 12'9 LIVING ROOM**

**15'9 X 7' KITCHEN DINING ROOM**

**15'9 X 10'1 CONSERVATORY**

**PART DOUBLE GLAZED**

**GAS CENTRAL HEATING**

**24' SOUTH EASTERLY FACING GARDEN**

**GARAGE IN BLOCK**

**UPDATING REQUIRED**

**CUL DE SAC LOCATION**

**NO FORWARD CHAIN**

Ground Floor  
48.6 sq.m. (523 sq.ft.) approx.

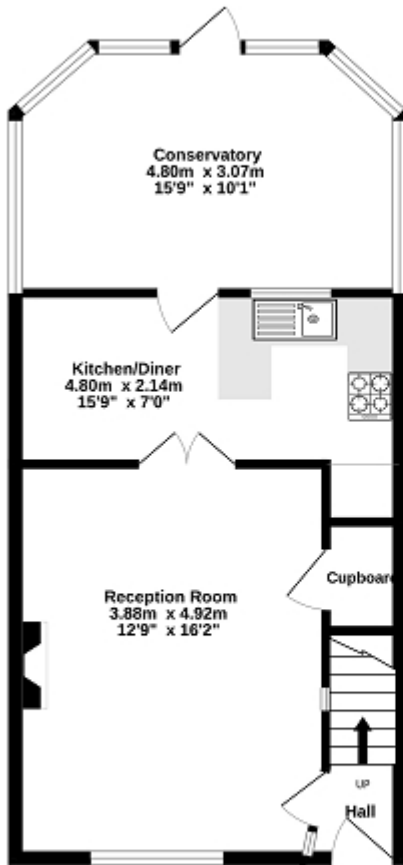

1st Floor  
34.9 sq.m. (376 sq.ft.) approx.

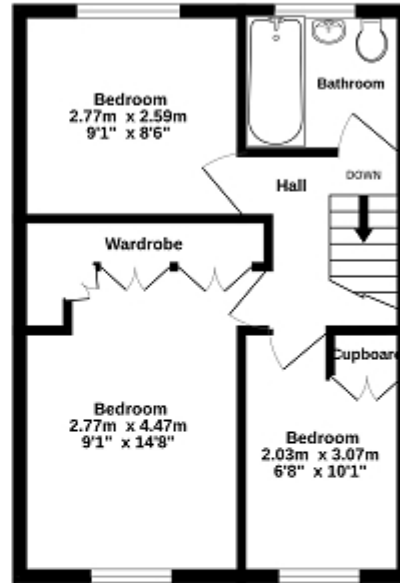

TOTAL FLOOR AREA: 83.5 sq.m. (899 sq.ft.) approx.

Whilst every attempt has been made to ensure the accuracy of the footprints contained here, measurements of doors, windows, stairs and any other items are approximate and no responsibility is taken for any error, omission or mis-statement. This plan is for illustrative purposes only and should be used as such by any prospective purchaser. The services, systems and appliances shown have not been tested and no guarantee as to their operability or efficiency can be given.  
Made with Intropic 02/23

