



Apartment (EPC Rating: D)

CRAVEN HALL SACKVILLE STREET, SKIPTON, BD23 2PB

£625 PCM



Spacious one bedroom apartment located at third floor level with long distance views from most windows and modern kitchen and bathroom. Situated close to Skipton town centre and only a short walk to the bus and train station.

LOCATION

Located on Sackville Street, Craven Hall is only a short walk to the town's amenities. Known as "The Gateway to the Dales", the historic market town of Skipton provides extensive shopping and recreational facilities together with excellent primary and secondary schooling. Within 10 minutes drive of the Yorkshire Dales National Park, the town is close to the popular holiday destinations of Malham, Grassington and Bolton Abbey. The town's railway station has regular services to Leeds, Bradford & Lancaster/Carlisle and a daily service direct to London Kings Cross. The major towns of East Lancashire and West Yorkshire are all within easy commutable distance.

DESCRIPTION

In brief the property comprises a top floor flat with good sized living room with feature fireplace, modern kitchen and bathroom and good sized double bedroom.

LIVING ROOM

5.7m (max) x 4.8m (max) (18'8" (max) x 15'8" (max))

Accessed from the lobby area, a large living room with two windows offering superb roof top views of Skipton and the hills beyond. Doors lead into the kitchen, bedroom and inner lobby

KITCHEN

2.7 x 3.38 (8'10" x 11'1")

Good sized kitchen with recently fitted white wall and base units with wood grain effect work surfaces. Integrated electric fan oven and four ring electric hob, fridge, freezer, washing machine with dryer and wall mounted gas combination boiler.

BEDROOM

4 x 3.8 (13'1" x 12'6")

Well proportioned double bedroom with sloping roof to one side, with window offering superb views.

BATHROOM

Accessed from the inner lobby and including a new white three piece suite comprising a pedestal wash hand basin, WC and panel bath with electric shower over

LARGE STORE ROOM

3.75 x 1.5 (12'4" x 4'11")

Handy store room with potential for an occasional home office or other uses

VIEWING

Strictly by appointment through the agents Carling Jones - contact a member of the team at the Skipton Office on 01756 799163

TENANCY INFORMATION

HOLDING DEPOSITS: A holding deposit, equal to



1 weeks rent, is payable upon the start of the application. Successful Applications - any holding deposit will be offset against the initial rent and Deposit, with the agreement of the payee.

DEPOSIT: A deposit equal to 5 weeks rent (6 weeks rent, where the annual rent is great than £50,000) will be payable plus the first months rent once the references have been passed and before the tenancy begins.

OTHER INFORMATION: Carling Jones Ltd is a member of the RICS Client Money Protection Scheme. Carling Jones Ltd is a member of The Property Ombudsman Redress Scheme.

AGENT'S NOTE AND DISCLAIMER

These details do not form part of an offer or contract. They are intended to give a fair description of the property, but neither the vendor nor Carling Jones accept responsibility for any errors it may contain. Purchasers or prospective tenants should satisfy themselves by inspecting the property



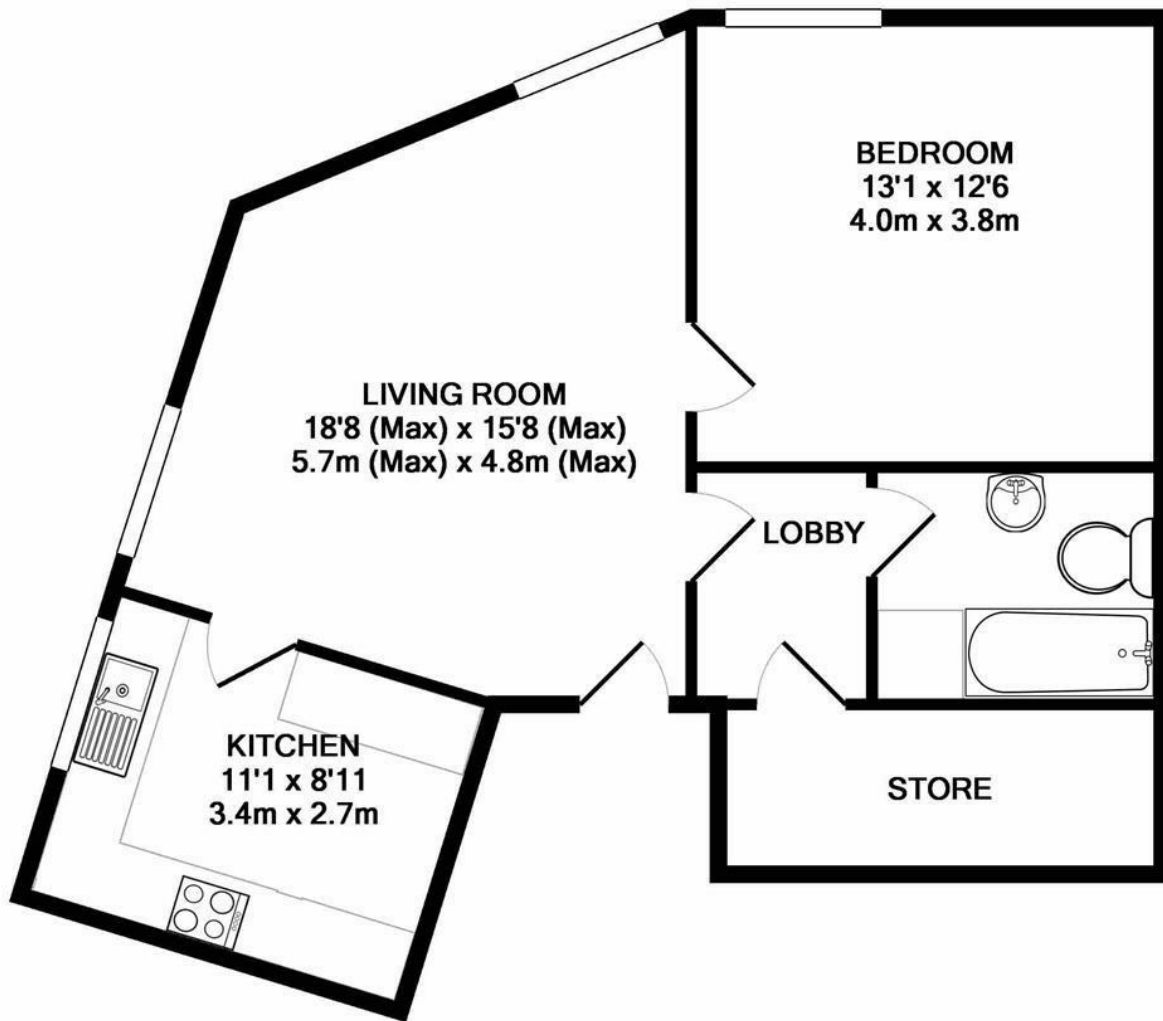

Whilst every attempt has been made to ensure the accuracy of the floor plan contained here, measurements of doors, windows, rooms and any other items are approximate and no responsibility is taken for any error, omission, or mis-statement. This plan is for illustrative purposes only and should be used as such by any prospective purchaser. The services, systems and appliances shown have not been tested and no guarantee as to their operability or efficiency can be given
Made with Metropix ©2017

Council Tax Band

A

Energy Performance Graph

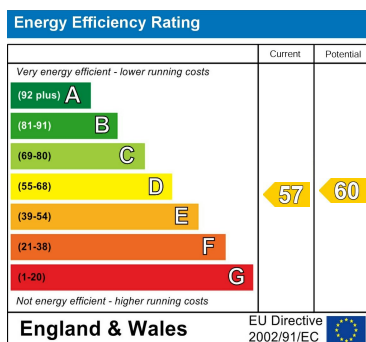

Call us on

01756 799163

sales@carlingjones.co.uk

https://carlingjones.co.uk/



Agents Note: Whilst every care has been taken to prepare these particulars, they are for guidance purposes only. All measurements are approximate and are for general guidance purposes only and whilst every care has been taken to ensure their accuracy, they should not be relied upon and potential buyers are advised to recheck the measurements.