

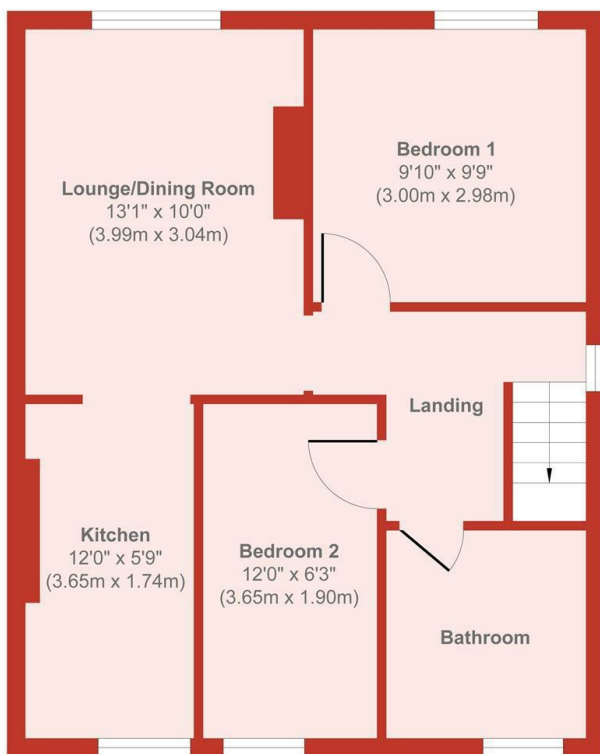

Cynthia Road, Poole, BH12 3JE

£225,000

- Two Bedrooms
- Good Size Private Rear Garden
- Share Of Freehold
- No Forward Chain
- First Floor Maisonette
- UPVC Double Glazing
- Allocated Off Road Parking
- Well Presented
- Gas Central Heating
- Ideal First Time Buy



Floor Plan
 Approx. Gross Internal Floor Area 509 sq. ft / 47.36 sq. m
 Produced by Elements Property

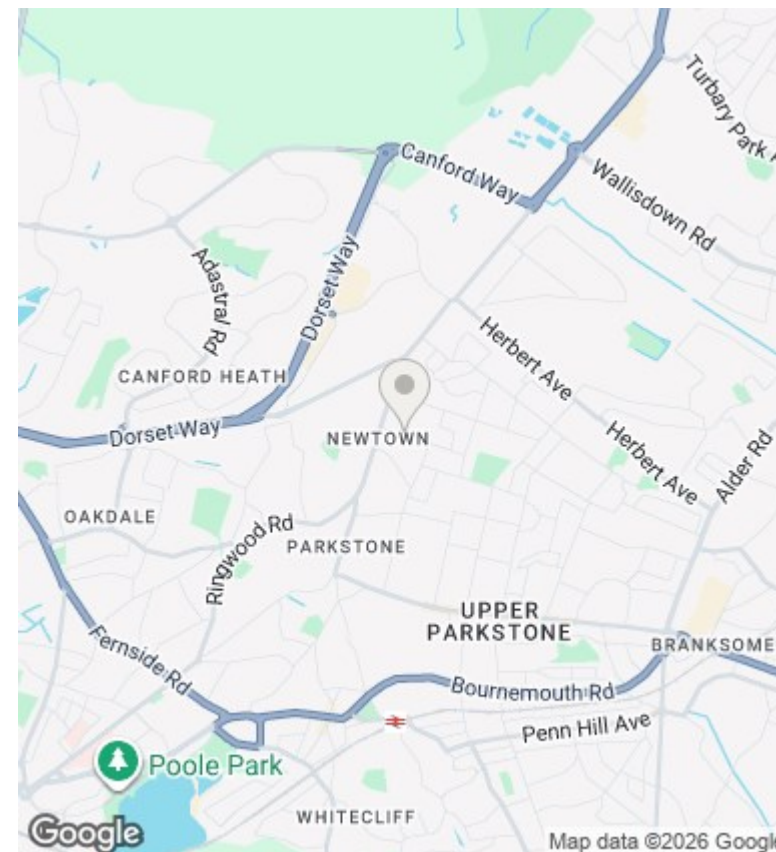

Directions

Viewings

Viewings by arrangement only. Call 01202 749390 to make an appointment.

Council Tax Band

A

EPC Rating:

| Energy Efficiency Rating | | |
|--|----------------------------|-----------|
| | Current | Potential |
| <i>Very energy efficient - lower running costs</i> | | |
| (92 plus) A | | |
| (81-91) B | | |
| (69-80) C | | |
| (55-68) D | | |
| (39-54) E | | |
| (21-38) F | | |
| (1-20) G | | |
| <i>Not energy efficient - higher running costs</i> | | |
| England & Wales | EU Directive 2002/91/EC | |