

Ground Floor
Approx. 27.6 sq. metres (296.6 sq. feet)

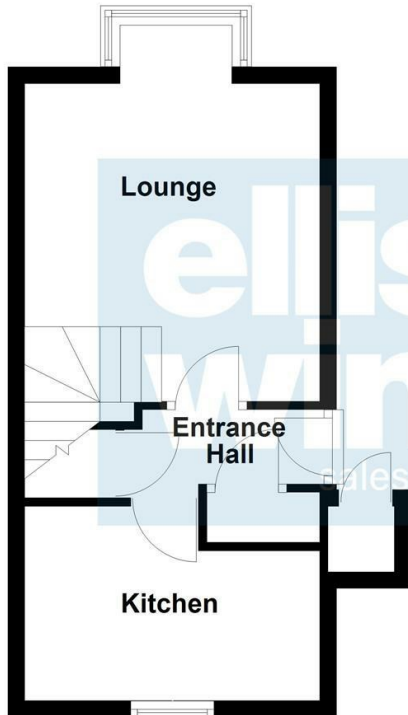

First Floor
Approx. 27.1 sq. metres (292.2 sq. feet)

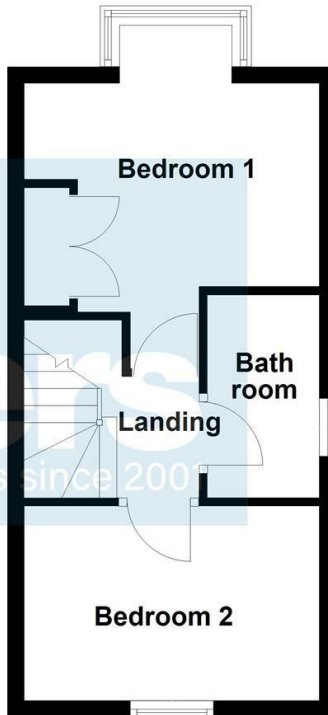

Total area: approx. 54.7 sq. metres (588.7 sq. feet)

Ground Floor

Entrance Hall

Refitted Kitchen
3.55m (11'8") x 2.34m (7'8") max

Lounge
4.07m (13'4") x 3.55m (11'8")

First Floor

Landing

Bedroom 1
3.55m (11'8") x 3.43m (11'3")

Bedroom 2
3.55m (11'8") x 2.34m (7'8")

Refitted Bathroom

Outside

To the front and rear of the property are gardens, that are both laid to lawn. There is an allocated parking space for one vehicle.

Further Information

Tenure: Freehold
Council Tax Band: B
EPC Rating: E
Heating: Electric

Buyer ID Checks

To meet legal requirements, we must verify the identity of all buyers. Our partner, Simplify, will handle this process and will contact you directly once your offer is accepted, subject

to contract, to collect the necessary details and payment. The cost is £40 + VAT (£48) per transaction, payable upon offer acceptance. A memorandum of sale can only be issued once these checks are complete. Our team will guide you through the process when you make an offer on a property.

Disclaimer

All property details, photographs, floorplans, and other marketing materials produced by Ellis Winters are for general guidance only and do not form part of any contract. While we strive for accuracy, measurements, descriptions, and other information are provided in good faith but should be independently verified. We recommend that prospective buyers conduct their own due diligence before making any decisions.



OFFICE ADDRESS

14 Market Hill
St Ives
Cambridgeshire
PE27 5AL

OFFICE DETAILS

01480 388888
infostives@elliswinters.co.uk



£220,000
Tamar Close
St. Ives, , PE27 3JE

PROPERTY SUMMARY

A very well-presented, T Type Cluster home, with a stunning refitted, Nicholas Hythe kitchen, a refitted bathroom, a lounge with bay window, and two generous bedrooms. There are open plan gardens, and an allocated off-road parking space. Offered with no onward chain.

2



1



1

