

Property ref: 178509

**Regent Street,  
Reading, RG1 3NN****£1,400 PCM****HASLAM'S**  
Lettings

A very well presented two bedroom terraced home located to the East of Reading town centre. The property is situated in a popular location close to amenities, public transport links and is within walking distance of the town centre.

Reading Borough Council tax band B.

**Available Now**

- Two double bedrooms
- Modern kitchen with appliances
- Ground floor bathroom with shower over bath
- Gas central heating; EPC rating D
- Permit parking available; Private rear garden
- Unfurnished; Managed by HASLAM'S

\*Fees For Assured Shorthold Tenancies: when you rent a property from us you will be required to pay a sum equivalent to one weeks' rent for a holding deposit. Upon successful application, this amount will be off set against your first months' rent. You will also be required to pay a security deposit equivalent to 5 weeks' rent which will be held and protected in line with Deposit legislation. For more information about our fees please visit: [www.haslams.net](http://www.haslams.net)  
Fees for all other tenancies (Non Housing Act Tenancies / Company Lets): when you rent a property from us we will charge you a one-off fee per property. This charge is the equivalent of 15 days of the monthly rental charge (+VAT) with a minimum fee of £450 (inc.VAT) up to a maximum of £650 (inc.VAT). Other fees may apply depending on your circumstances.

**0118 960 1055****[lettings@haslams.net](mailto:lettings@haslams.net) [www.haslams.net](http://www.haslams.net)****Haslams Estate Agents Ltd, 159 Friar Street, Reading, Berkshire, RG1 1HE**

Water supply: Mains

Drainage info: Mains

Electricity supply: Mains

Gas supply: Mains

Broadband/Mobile Info: Connections available. For an indication of specific speeds and supply of Broadband and Mobile, we advise applicants go to the Ofcom website Broadband and Mobile Coverage Checker.

Please note - the Landlord is related to a current employee of Haslams.







## Regent Street, Reading, RG1

Approximate Area = 649 sq ft / 60.2 sq m

For identification only - Not to scale

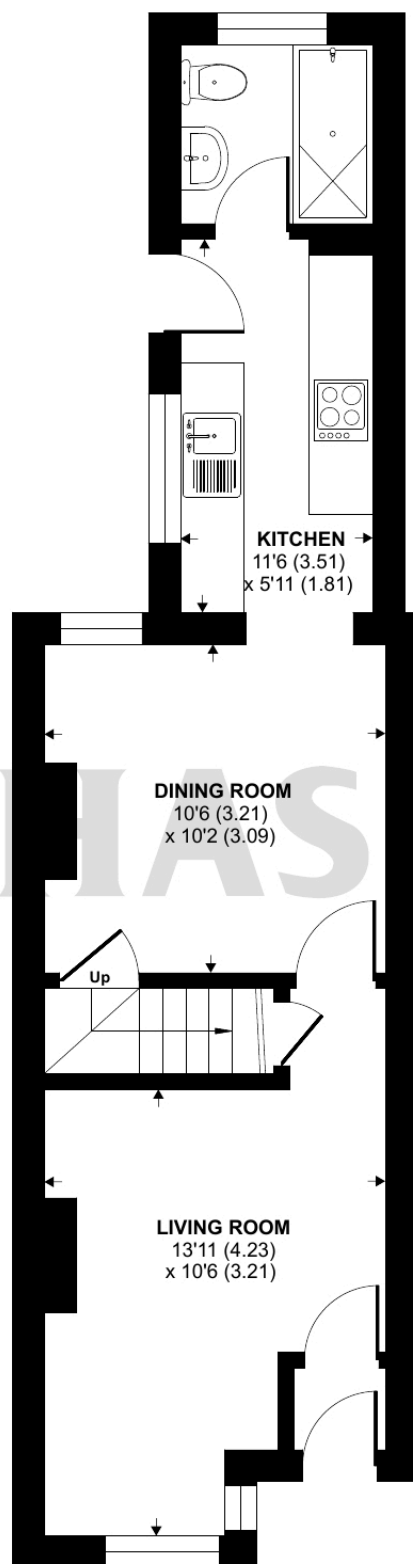

**GROUND FLOOR**

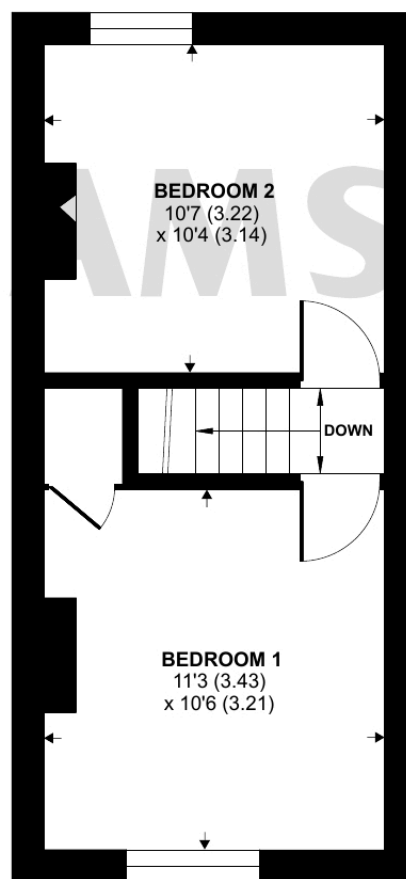

**FIRST FLOOR**



Floor plan produced in accordance with RICS Property Measurement 2nd Edition, Incorporating International Property Measurement Standards (IPMS2 Residential). © n̄cheom 2026. Produced for Haslams. REF: 1409539