

Estate Agents



Auctioneers



## Douglas Mews, Southbourne, Bournemouth, BH6 5BE Guide Price £165,000 - Leasehold

One Bedroom Ground Floor Flat | Private Entrance | Reception Room | Kitchen | Bathroom  
Bedroom | Allocated Parking Space | Long Lease | No Chain

# Douglas Mews, Southbourne, Bournemouth, BH6 5BE

## Guide Price £165,000 - Leasehold

**Spacious One-Bedroom Ground Floor Flat in Prime Southbourne Location – No Chain.** A generously sized one-bedroom ground floor flat, ideally located just a few minutes' walk from the vibrant Southbourne Grove, renowned for its wide range of independent shops, bars, and restaurants. The glorious sandy beaches are also less than a mile away, making this a highly desirable location.

Built in 1993 on the historic site of the original Stourfield House, the property benefits from its own private entrance and an allocated parking space situated directly outside the front door. Inside, the accommodation includes a 14ft reception room, a separate fitted kitchen, a 12ft double bedroom, and a three-piece bathroom suite. The flat also features double glazing and electric heating throughout.

**While some internal redecoration is required, this property presents an excellent opportunity for first-time buyers or investors looking to add value in a sought-after area.**

Offered with no forward chain, early viewing is highly recommended.

Tenure: Leasehold – 996 years remaining on lease

Service Charge: £80.00 per month / Ground Rent: £50.00 per annum

Council Tax Banding: B

EPC Rating: 70 | C

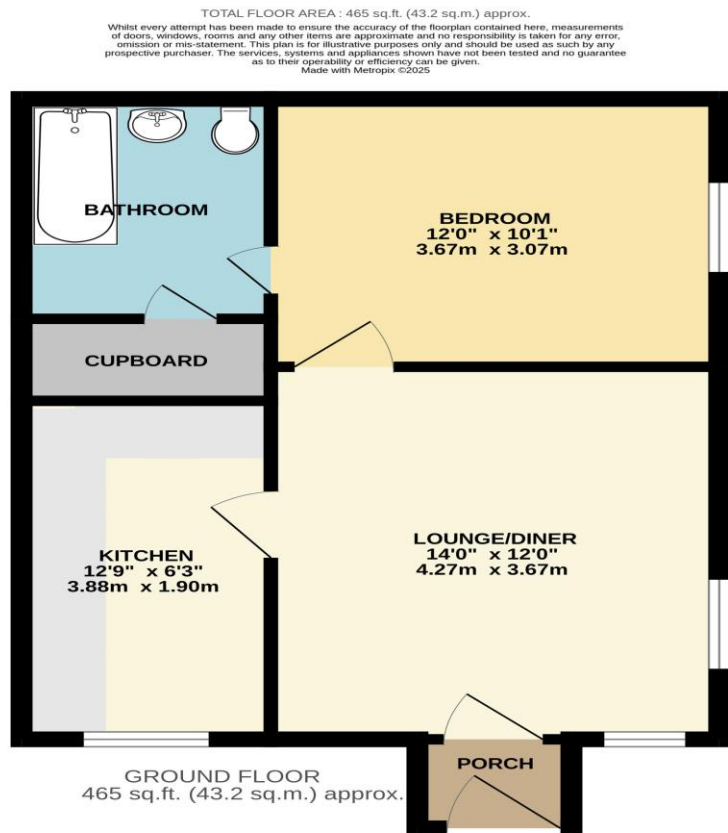
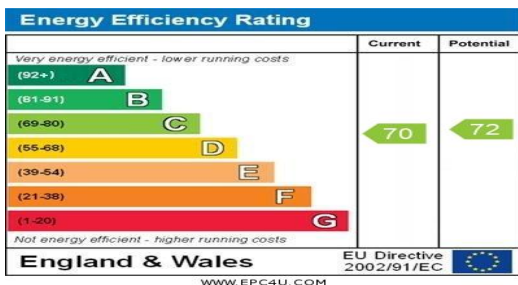

These particulars, whilst believed to be accurate are set out as a general outline only for guidance and do not constitute any part of an offer or contract. Intending purchasers should not rely on them as statements of representation of fact, but must satisfy themselves by inspection or otherwise as to their accuracy. We have not carried out a detailed survey nor tested the services, appliances and specific fittings. Room sizes should not be relied upon for carpets and furnishings. The measurements given are approximate. No person in this firm's employment has the authority to make or give any representation or warranty in respect of the property.