



22 Whiteway Close, Whimble, Exeter, EX5 2TL

Guide Price £260,000

🛏️ 2 🪑 1 🚗 1



- Desirable East Devon village location with excellent amenities
- Principal bedroom with en-suite WC
- Driveway providing off-road parking and attached garage with light and power
- Two bedrooms, both with built-in wardrobes
- Useful downstairs storage cupboard
- LPG central heating and uPVC double glazing throughout
- Fully enclosed rear garden with decking area, lawn, and flowerbeds



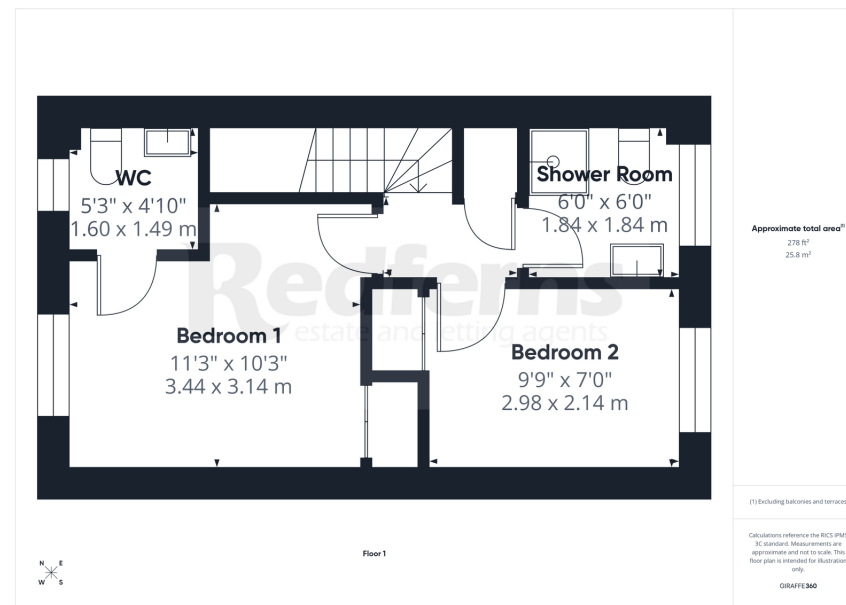

A well-presented two-bedroom home in a highly desirable East Devon village, offering comfortable accommodation, a kitchen/dining space, enclosed rear garden, driveway and garage, with excellent local amenities and no onward chain.



Ottery St. Mary | **01404 814 306**
Exeter | **01392 984 511**
Sidmouth | **01395 512 544**

www.redfernsproperty.co.uk | sales@redfernsproperty.co.uk



Redferns is a trading name of Redferns Ottery St Mary Limited. Registered in England and Wales 48170778. Registered office 8 Mill Street, Ottery St Mary, EX11 1AD