



## Quex Road

West Hampstead, NW6

£1,750 per month  
(£403.85 per week)

A delightful 2nd floor apartment with balcony and wood floors. The property is situated in this desirable road within close proximity to the amenities of West End Lane and Kilburn High Road (Jubilee Line & Thameslink). Accommodation comprises reception room, open plan kitchen with direct access to the balcony, double bedroom with fitted wardrobes, shower room.

**CHESTERTONS**



# Quex Road

## West Hampstead, NW6

- A Lovely 2nd Floor Apartment
- 1 Bedroom, 1 Bathroom, Reception, Open Plan Kitchen
- Balcony, Wood Floors
- Situated in this Desirable Road, Close Proximity to the Amenities of West End Lane and Kilburn High Road (Jubilee Line & Metropolitan)



**Deposit Required:** £2,019.23  
**Local Authority:** London Borough Of Camden  
**Council Tax Band:** A  
**EPC Rating:** D  
**Part Furnished**

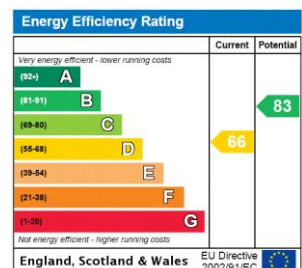

### *Chestertons Hampstead Lettings*

55-56 Hampstead High Street  
Hampstead  
London  
NW3 1QH  
hampsteadlettingsusers@chestertons.co.uk  
02077941125  
chestertons.co.uk

Additional tenant charges apply (fees apply to non-AST tenancies only)  
Tenancy Agreement Fee: £300  
References per Tenant/Guarantor: £60  
Inventory check (approx. £100 – £250 inc. VAT)  
chestertons.co.uk/property-to-rent/applicable-fees

# Quex Road, West Hampstead, NW6

 - Ceiling Height

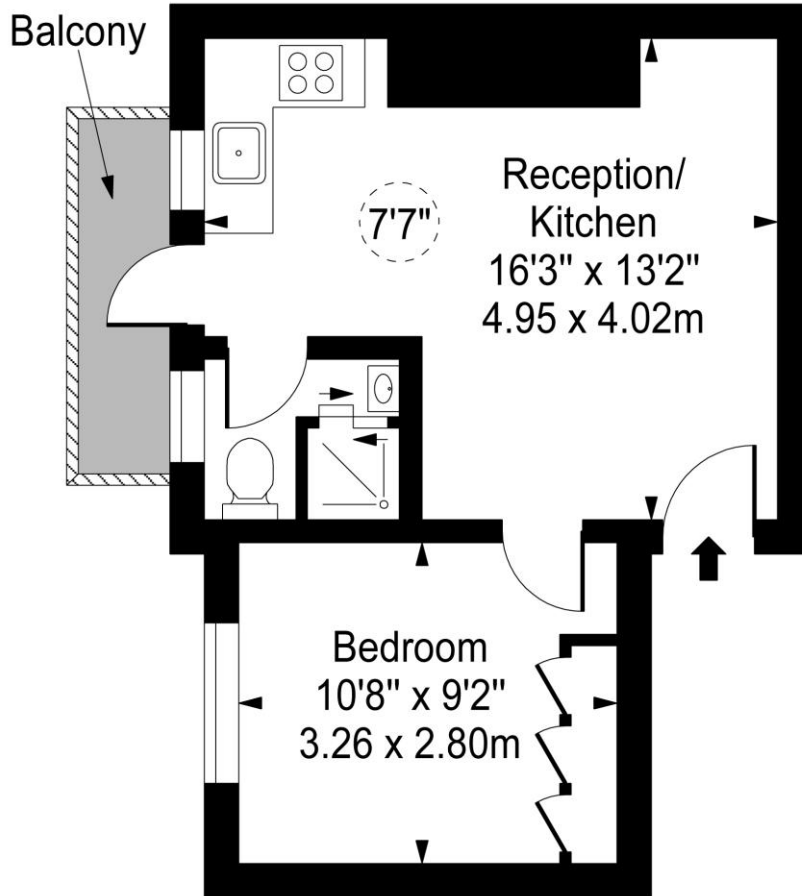
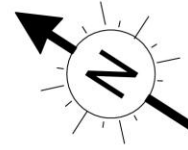

Third Floor

Approx Gross Internal Area **334 Sq Ft - 31.02 Sq M**

For Illustration Purposes Only - Not To Scale

[www.goldlens.co.uk](http://www.goldlens.co.uk)

Prepared for Chestertons

Ref. No. 012987MiV