

£279,995

TATTERSHALL CRESCENT, PORTCHESTER, PO16 9YD



- Two Double Bedrooms
- Entrance Porch & Lobby
- 17' Lounge/Diner
- Fitted Kitchen With Built-In Appliances
- First Floor Modern Shower Room
- Gas Central Heating
- Double Glazing
- Good Decorative Order
- Allocated Parking Space
- Established South Facing Rear Garden

Portchester Office

92 West Street Portchester Hampshire PO16 9UQ

Tel: 02392 327 070 | E: tiffany.porchester@fenwicks-estates.co.uk

www.fenwicks-estates.co.uk

Property Reference: P2909

Council Tax Band: B

Awaiting EPC

Floor Plans (For illustrative purposes and not drawn exactly to scale)

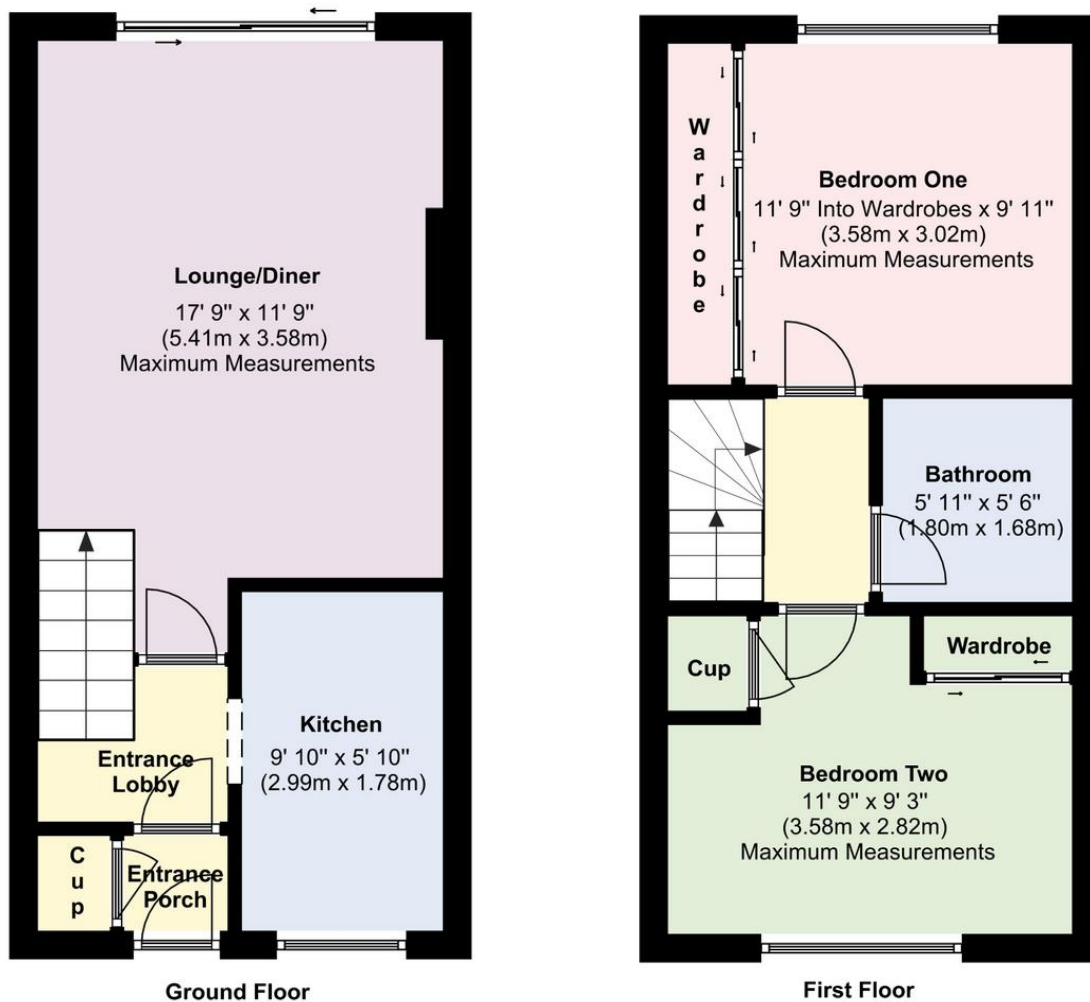

Portchester Office

92 West Street Portchester Hampshire PO16 9UQ

Tel: 02392 327 070 | E: tiffany.porchester@fenwicks-estates.co.uk

www.fenwicks-estates.co.uk



The Accommodation Comprises:-

UPVC part double glazed front door into:

Entrance Porch:-

Built-in storage cupboard housing the meters and part glazed wooden internal door to:

Entrance Lobby:-

Stairs leading to first floor, heating controls/thermostat, radiator, textured ceiling. Walkway to kitchen and door to:

Lounge/Diner:-

17' 9" x 11' 9" (5.41m x 3.58m) Maximum Measurements

Feature brick fireplace with tiled hearth and remote control living flame gas fire inset, TV aerial point, radiator, space for table and chairs if required, textured ceiling. UPVC double glazed sliding patio door overlooking and accessing the south facing rear garden.



Portchester Office

92 West Street Portchester Hampshire PO16 9UQ

Tel: 02392 327 070 | E: tiffany.porchester@fenwicks-estates.co.uk

www.fenwicks-estates.co.uk



Kitchen:-
9' 10" x 5' 10" (2.99m x 1.78m)

UPVC double glazed window to front elevation, the kitchen is with a fitted range of bespoke modern base and eye level soft close units with granite worktops, built-in one and a half bowl sink unit with mixer tap and part tiled walls, built-in Bosch appliances including oven and grill, ceramic hob with pull out concealed extractor above, integrated slimline dishwasher and washer/dryer, built-in fridge/freezer, chrome heated towel rail, tiled flooring and textured ceiling.



First Floor Landing:-

Textured ceiling and access to loft via fitted ladder. Doors to:

Bedroom One:-

11' 9" Into Wardrobes x 9' 11" (3.58m x 3.02m) Maximum Measurements

UPVC double glazed window to rear elevation overlooking the garden, radiator, sliding mirror fronted built-in wardrobes with hanging space, shelving and central dresser unit, TV aerial point, additional wall mounted cabin cupboards for storage and air conditioning unit.



Bedroom Two:-

11' 9" x 9' 3" (3.58m x 2.82m) Maximum Measurements

UPVC double glazed window to front elevation with views towards Portsdown Hill, radiator, sliding mirror fronted built-in wardrobe with hanging space and shelving space, built-in airing cupboard housing Valliant Eco Tech combination boiler, TV aerial point and textured ceiling.

Portchester Office

92 West Street Portchester Hampshire PO16 9UQ

Tel: 02392 327 070 | E: tiffany.porchester@fenwicks-estates.co.uk

www.fenwicks-estates.co.uk





Shower Room:-

5' 11" x 5' 6" (1.80m x 1.68m)

Modern white suite comprising double walk in shower cubicle with water proof panelling to the walls, pedestal wash hand basin with mixer tap, close coupled WC, part tiled walls, dual feed chrome heated towel rail, shaver socket, tiled flooring with under floor heating, Dimplex electric heater, extractor fan and textured ceiling.



Rear Garden:-

An enclosed well established South facing garden with a patio area for entertaining purposes with a remote control awning, shingle and shrubs inset, water tap, outside lighting, mature hedging, water feature and 13' 7" x 5' 7" (4.14m x 1.70m) insulated wooden workshop with power connected and a fridge and separate freezer to remain as part of the sale.



Outside:-

To the front of the property there is a low maintenance AstroTurf lawn with shingle and slate chipped borders and an allocated parking space available to rear. Side pedestrian access and wooden gate lead to:



Portchester Office

92 West Street Portchester Hampshire PO16 9UQ

Tel: 02392 327 070 | E: tiffany.porchester@fenwicks-estates.co.uk

www.fenwicks-estates.co.uk





Disclaimer: These particulars are set out as a general outline in accordance with the Consumer Protection from Unfair Trading Regulations 2008 (CPR's) and Business Protection from Misleading Marketing Regulations 2008 (BPR's) only for the guidance of intending purchasers or lessees, and do not constitute any part of an offer or contract. Details are given without any responsibility, and any intending purchasers, lessees or third parties should not rely on them as statements or representations of fact, but must satisfy themselves by inspection or otherwise as to the correctness of each of them.

We have not carried out a structural survey and the services, appliances and specific fittings have not been tested. All photographs, measurements, floor plans and distances referred to are given as a guide only and should not be relied upon for the purchase of carpets or any other fixtures or fittings. Gardens, roof terraces, balconies and communal gardens as well as tenure and lease details cannot have their accuracy guaranteed for intending purchasers. Lease details, service ground rent (where applicable) are given as a guide only and should be checked and confirmed by your solicitor prior to exchange of contracts.

No person in the employment of Fenwicks Estates Ltd has any authority to make any representation or warranty whatever in relation to this property. Purchase prices, rents or other prices quoted are correct at the date of publication and, unless otherwise stated, exclusive of VAT.

Data Protection: We retain the copyright in all advertising material used to market this Property.

Money Laundering Regulations 2017: Intending purchasers will be required to produce identification documentation once an offer is accepted

Your home is at risk if you do not keep up repayments on mortgage or other secured loans.

Portchester Office

92 West Street Portchester Hampshire PO16 9UQ

Tel: 02392 327 070 | E: tiffany.porchester@fenwicks-estates.co.uk

www.fenwicks-estates.co.uk

