



**MORGAN
BROOKES**
ESTATE AGENTS
HELPING YOU GROW



Markhams Chase, Basildon



Morgan Brookes believe - This spacious & well presented 3 bedroom semi detached home offers excellent family living. The property features a good size living room, kitchen/diner, utility room, ground floor cloakroom & 3 spacious bedrooms with en-suite to master. Ideally located within walking distance of Basildon Town Centre & Train Station.

Our Sellers love – That the rooms are large, airy & bright, having ample off street parking & its location backing onto playing fields, being close to local facilities, schools, shops & the station within easy reach.

Key Features

- Three Bedroom Semi Detached House.
- 18'10 Living Room.
- Ground Floor Cloakroom.
- Kitchen/Dining Room.
- Utility Room.
- En-Suite To Master.
- Close To Town Centre & Station
- Call Morgan Brookes Today!

£450,000



Markhams Chase, Basildon

Entrance

Double glazed panelled door to:

Entrance Hallway

17' 5" x 7' 2" nt 3'6" (5.30m x 2.18m nt 1.06m)

Walk in storage area, stairs to first floor, radiator, coving to ceiling, oak wood flooring, doors to:

Ground Floor Cloakroom

Obscure double glazed window to front aspect, vanity hand basin, low level WC, radiator, tiled walls & flooring.

Kitchen / Dining Room

14' 5" x 11' 2" (4.39m x 3.40m)

Double glazed window to front aspect, fitted with a range of base and wall mounted units, roll top work surface incorporating one and half stainless steel sink and drainer, Bosch four ring hob with stainless steel extractor over, integrated Bosch oven, integrated dishwasher, integrated fridge, splash back tiling, tiled flooring, door leading to:

Utility Room

11' 4" x 5' 1" (3.45m x 1.55m)

Fitted with a range of base and wall mounted units, roll top work surface incorporating stainless steel sink and drainer, cupboard housing Valiant combi boiler (untested), space and plumbing for fridge / freezer, washing machine, splash back tiling, tiled flooring, double glazed panelled door to side aspect leading to garden.

Living Room

18' 10" x 15' 8" nt 13'1" (5.74m x 4.77m nt 3.98m)

Two double glazed windows to rear aspect, large built in storage area, stone feature fire place, two radiators, coving to ceiling, oak wood flooring, double glazed French doors leading to garden.

First Floor Landing

10' 5" x 8' 5" (3.17m x 2.56m)

Heated airing cupboard, coving to ceiling incorporating loft access with ladder & is partially boarded, carpet flooring, doors leading to:

Bedroom 1

18' 10" nt 14'4" x 12' 10" (5.74m nt 4.36m x 3.91m)

Two double glazed windows to front aspect, coving to ceiling, two radiators, carpet flooring, door leading to:

En-Suite

Obscure double glazed window to side aspect, double shower cubicle, pedestal hand basin, low level WC, radiator, tiled walls and flooring.

Bedroom 2

12' 10" x 10' 0" (3.91m x 3.05m)

Double glazed window to front aspect, coving to ceiling, radiator, carpet flooring.

Bedroom 3

9' 5" x 8' 6" (2.87m x 2.59m)

Double glazed window to front aspect, coving to ceiling, radiator, carpet flooring.

Family Bathroom

10' 0" x 7' 1" (3.05m x 2.16m)

Obscure double glazed window to side aspect, coving to ceiling with inset downlights, panelled bath with thermostatic fitted shower, pedestal hand basin, low level WC, tiled walls and flooring.

Rear Garden

Paved seating area from property, remainder laid to lawn, path to rear leading to large brick built shed, wide gated side access. Gate & fencing replaced 18 months ago.

Front Of Property

Block paved driveway with established boarders, off street parking for up to 3 cars.

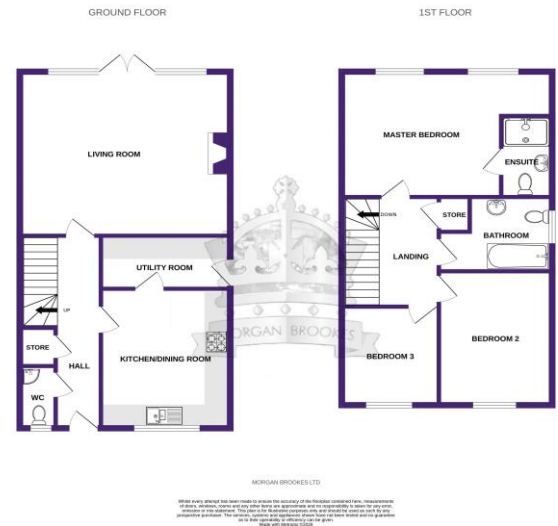

Local Authority Information
Basildon Borough Council
Council Tax Band: D

Sales | Lettings | Property Management
01268 755626 morganbrookes.co.uk

£450,000

MONEY LAUNDERING REGULATIONS 2003

Intending purchasers will be asked to produce identification and proof of financial status when an offer is received. We would ask for your co-operation in order that there will be no delay in agreeing the sale.

THE PROPERTY MISDESCRIPTIONS ACT 1991

The Agent has not tested any apparatus, equipment, fixtures and fittings or services and so cannot verify that they are in working order or fit for the purpose. A Buyer is advised to obtain verification from their Solicitor or Surveyor. References to the Tenure of a Property are based on information supplied by the Seller. The Agent has not had sight of the title documents. A Buyer is advised to obtain verification from their Solicitor. You are advised to check the availability of this property before travelling any distance to view. We have taken every precaution to ensure that these details are accurate and not misleading. If there is any point which is of particular importance to you, please contact us and we will provide any information you require. This is advisable, particularly if you intend to travel some distance to view the property. The mention of any appliances and services within these details does not imply that they are in full and efficient working order. These particulars are in draft form awaiting Vendors confirmation of their accuracy. These details must therefore be taken as a guide only and approved details should be requested from the agents.

We can refer sellers and buyers to our recommended panel of conveyancers. It is your decision whether you choose to deal with our recommended conveyancers. Should you decide to use our recommended conveyancers you should know that we receive a referral fee between £100.00 & £300.00 from them for recommending you to them.