



Hodder Drive, UB6

£761 Per week

A well presented, bright and spacious four-bedroom house featuring off-street parking, a private garden, separate studio office with bathroom, double reception, hallway, downstairs WC, modern kitchen, and two additional bathrooms.

Located in Perivale and is half a mile from Perivale tube station (Central Line) for access to Central London and under a quarter of a mile away from A40/A406 for drivers.

Features

- Four Bedrooms
- Double Reception
- Driveway Parking
- Rear Garden
- Underfloor Heating
- Outhouse

Hodder Drive, Greenford, UB6

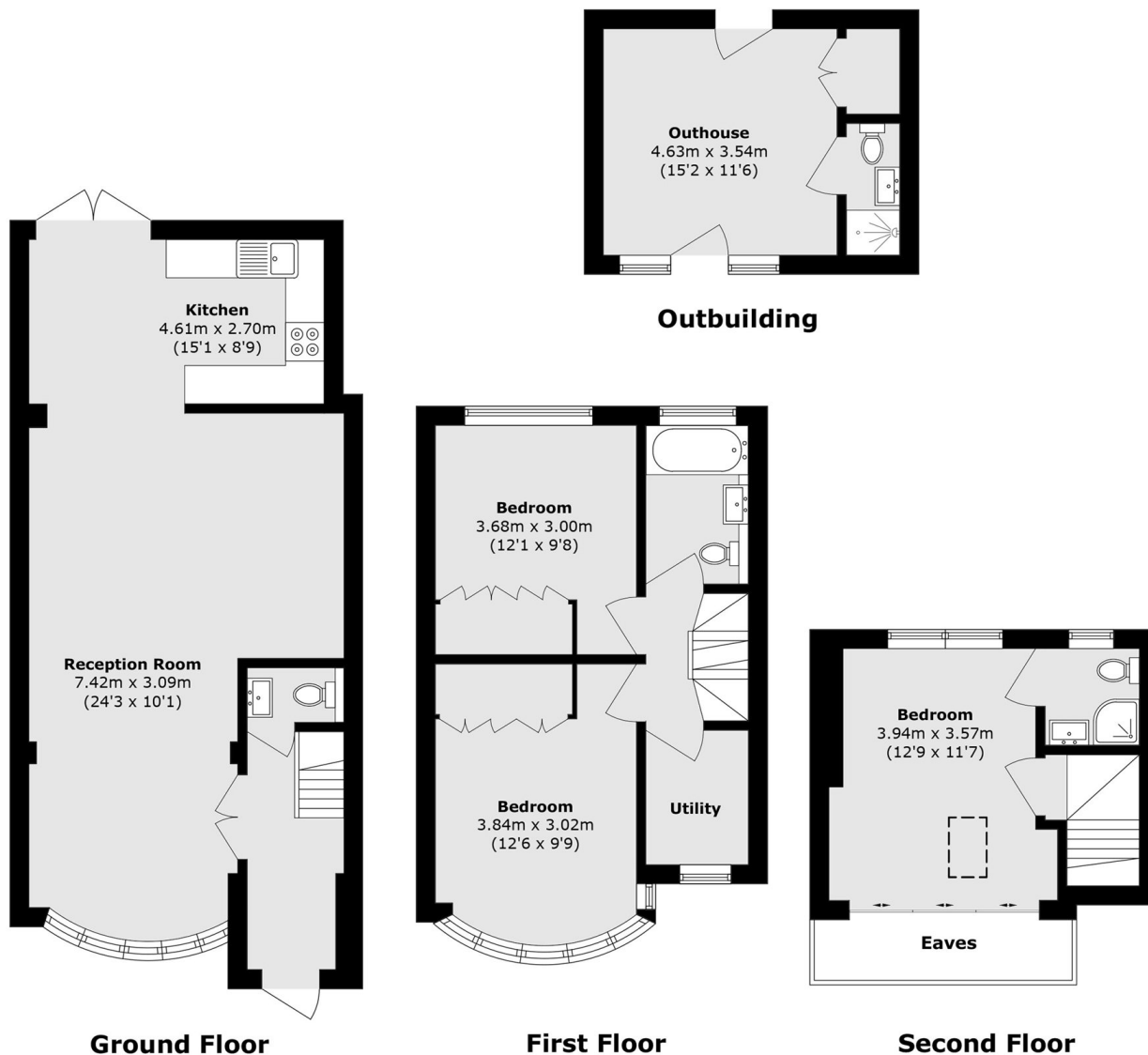

Total area (approx.): 108.7 sq. m (1170.0 sq. ft)
Outbuilding area (approx.): 16.4 sq. m (176.5 sq. ft)
(Excluding Eaves)