

14 Bridge Street, Thetford, Norfolk, IP24 3AA  
Tel: 01842 754161  
thetford@chilternsestateagents.co.uk  
www.shiresresidential.com

**chilterns**

Estate & Letting Agents



**Ely Way, Thetford, IP24 1DP**

**Rent - Offers In Excess Of £150,000**

**Deposit -**

Are you searching for a property to add to your investment portfolio? This three bedroom mid terraced home is being offered for sale with a tenant in situ.

- INVESTMENT BUYERS ONLY
- SITUATED ON THE ABBEY DEVELOPMENT
- CONVENIENT FOR TOWN ACCESS
- THREE BEDROOMS
- ENCLOSED FRONT AND REAR GARDENS
- TENANT CURRENTLY IN SITU
- WALKING DISTANCE OF THE TRAIN STATION
- MID TERRACED HOUSE
- DOWNSTAIRS CLOAKROOM
- NO ONWARD CHAIN!



Council Tax Band: A - EPC Rating: C 77

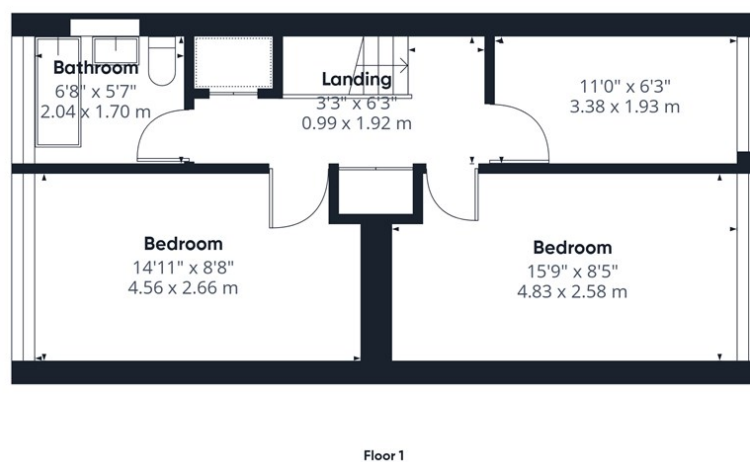
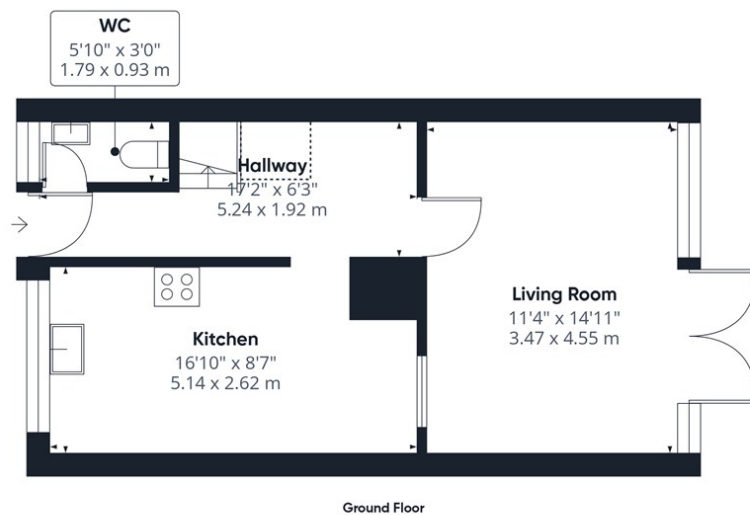

Approximate total area<sup>(3)</sup>843 ft<sup>2</sup>78.4 m<sup>2</sup>

Reduced headroom

8 ft<sup>2</sup>0,8 m<sup>2</sup>

(1) Excluding balconies and terraces

Reduced headroom

..... Below 5 ft/1.5 m

Calculations reference the RICS IPMS 3C standard. Measurements are approximate and not to scale. This floor plan is intended for illustration only.

GIRAFFE360

