



19 Aspen Road, High Wycombe, HP10 9FA



Asking Price | £600,000



## Property Features

---

- Modern Four Bedroom Town Home
- Located in the Abbey Barn Park Development
- High Standard Throughout
- Tranquil Countryside Setting
- Principle Bedroom with Juliet Balcony
- En-Suite Shower to Main Bedroom
- Kitchen with Dining Room/Family Room
- Carport and Allocated Parking for 3 Cars
- Within a Short distance to High Wycombe Town Centre
- EPC 85B / Council Tax Band E

## Full Description

---

Located within the prestigious Abbey Barn Park Development in High Wycombe, this stunning end-terraced townhouse epitomises contemporary living. Built to an exceptional standard, the property offers a thoughtfully designed layout across three spacious floors.

The ground floor features an inviting open-plan kitchen and family room, perfect for modern living and entertaining. The kitchen boasts a range of high-end integrated appliances and sleek finishes, complementing the large patio doors that open directly onto the landscaped garden, seamlessly blending indoor and outdoor spaces. A convenient downstairs WC completes the ground floor layout.

Moving to the first floor, you'll find a spacious and elegantly finished living room ideal for relaxation. The principal bedroom, also on this level, is a true highlight. It features a Juliet balcony offering charming views, built-in wardrobes for ample storage, and a luxurious en-suite shower room for added convenience.

The second floor houses three additional well-proportioned bedrooms, making it ideal for family living or guests. The main family bathroom is equally impressive, offering both a bathtub and a separate shower, ensuring style and practicality.

Externally, the property benefits from allocated parking and a carport accommodating two vehicles, ensuring convenience and security.

With its prime location, modern design, and superior finishes, this home offers an exceptional opportunity for families and professionals alike to enjoy the best of High Wycombe living.











Ground Floor

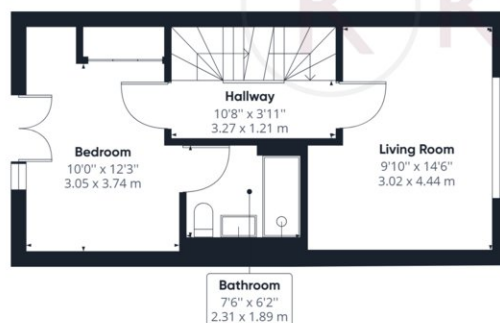

Floor 1



Floor 2

Approximate total area<sup>(1)</sup>

1273.45 ft<sup>2</sup>

118.31 m<sup>2</sup>

(1) Excluding balconies and terraces

While every attempt has been made to ensure accuracy, all measurements are approximate, not to scale. This floor plan is for illustrative purposes only.

GIRAFFE360