

Marlborough Road, Telford, TF1 5LN

£750

Council Tax Band: A



This beautifully presented one bedroom Coach House can be found less than 3 miles from Telford town centre.

The successful, fast-growing town of Telford lies in the heart of the beautiful Shropshire countryside. It offers an unrivalled location to explore some breathtaking scenery whilst making the most of excellent shops, schools and entertainment. Whether you crave a simple Sunday afternoon stroll, or a more adventurous hike, you couldn't be better located to take advantage of all the area has to offer. Telford is dominated by The Wrekin, a large hill of 407 metres – a popular choice for dog walkers and fitness fans. Closer to the heart of the town the 450-acre Telford Town Park is the perfect place for a fun-filled family day out.

Approximately only 15 miles from Shrewsbury and 28 miles from Birmingham, Telford is perfectly placed for a whole variety of locations and attractions. The town is connected to the M54 via junctions 4, 5 and 6, providing speedy links to Shrewsbury to the west and Wolverhampton, Birmingham and the M6 to the east. Regular direct rail services operate from three stations in the town to Wolverhampton, Shrewsbury and Birmingham New Street. There are also excellent bus services throughout the area and Birmingham airport is just over an hour away by car.

Set in the heart of Shropshire yet enjoying the best of urban life, Telford and the surrounding area could be the perfect place for you.

Please note that there is NO GARAGE included.



Open House Whitchurch

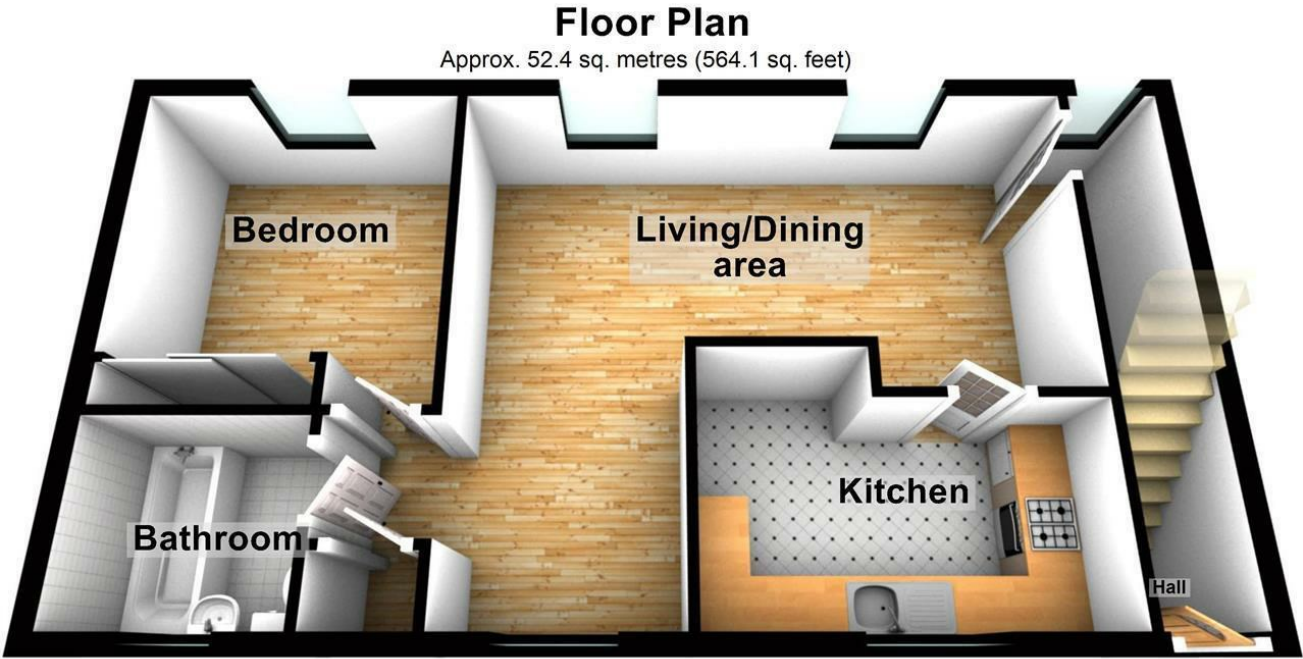

Total area: approx. 52.4 sq. metres (564.1 sq. feet)

All sizes are approximate and are not to be taken literally.
Plan produced using PlanUp.

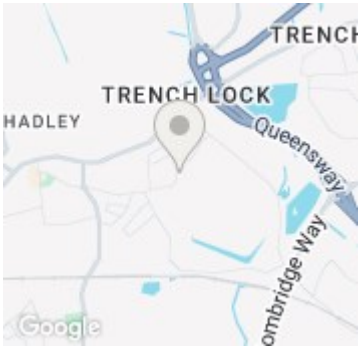

Energy Efficiency Rating		
	Current	Potential
Very energy efficient - lower running costs		
(92 plus) A		
(81-91) B		
(69-80) C	71	75
(55-68) D		
(39-54) E		
(21-38) F		
(1-20) G		
Not energy efficient - higher running costs		
England & Wales	EU Directive 2002/91/EC	