



## Downs Road, E5

£525,000

A one bedroom apartment in the RIBA award winning development with amazing views over the park. This larger than average one bedroom property measures over 670 sq ft and has an open plan kitchen/living area with floor to ceiling windows and doors leading to the private south facing terrace. High end finishes include engineered oak flooring and underfloor heating. The development has a concierge, wellness room, communal roof garden and bike storage.

The Otto Building is ideally located on Hackney Downs Park offering many opportunities for outdoor recreation including tennis. Rectory Road, Clapton, Hackney Downs and Hackney Central Overground stations are all half a mile away providing numerous transport links across London. The many shops, cafés and restaurants on Kingsland Road, Mare Street and Chatsworth Road are also within walking distance.

### Features

- One Double Bedroom
- South Facing Balcony
- Wellness Room
- Concierge
- City and Park Views
- Award-Winning Development

# Downs Road, London, E5

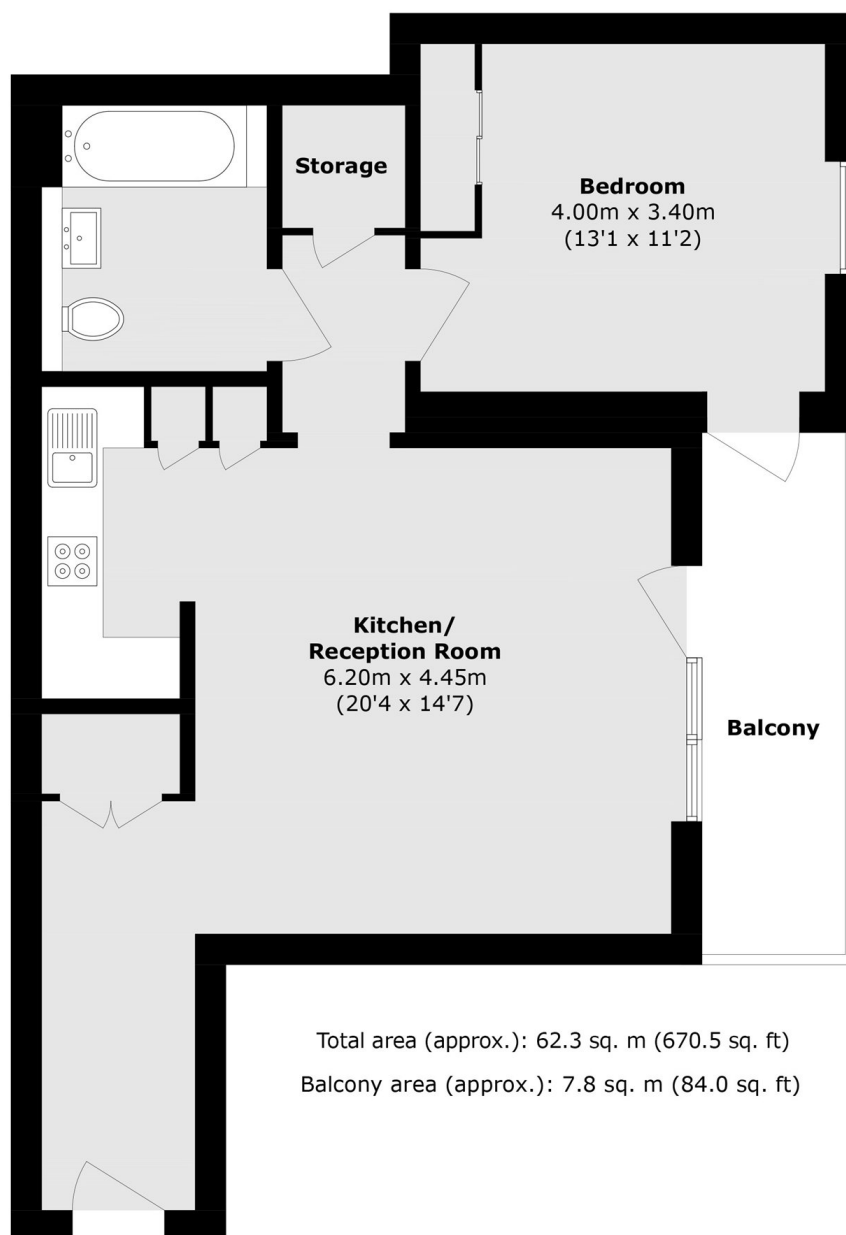

Total area (approx.): 62.3 sq. m (670.5 sq. ft)  
Balcony area (approx.): 7.8 sq. m (84.0 sq. ft)