

Vendace Road, Blythe Valley

£175,000

1 1 1



3 Union Road, Shirley, Solihull B90 3BT

sales • new homes • land • commercial • mortgages • auction

Registered Company in England and Wales. Company No 03591917
Registered Office: smart New Homes Ltd, 3 Union Road, Shirley, Solihull B90 3BT

- First floor one bedroom apartment
- Secure video intercom entry system
- Pets allowed
- Stylish bathroom with panelled bath and shower attachment
- Situated in Blythe Valley, with close amenities and a great community
- Ample storage space
- Allocated parking space
- Contemporary open plan kitchen with gloss-finish cupboards and integrated appliances
- Generous double bedroom
- Give us a call today to find out more!

30 Vendace Road, Blythe Valley, Solihull, West Midlands, b90 8dw

Approximate Gross Internal Area
463 sq ft - 43 sq m

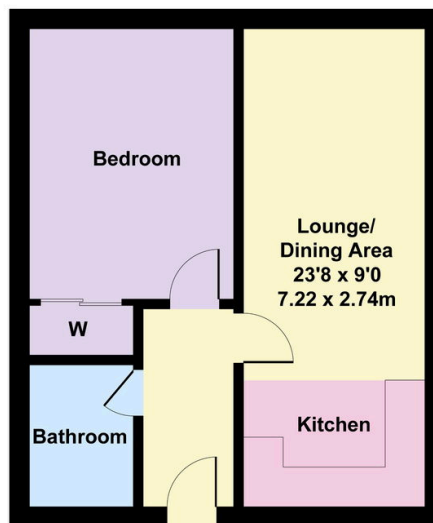

Not to Scale. Produced by The Plan Portal 2026
For Illustrative Purposes Only.

This well-presented first floor one-bedroom apartment is ideally situated in the popular Blythe Valley area of Solihull, offering modern living in a convenient and well-connected location. The property features a bright and spacious open-plan kitchen, dining, and lounge area, perfect for both everyday living and entertaining. The apartment benefits from plenty of storage space, helping to keep the space practical and clutter-free. The double bedroom is generously sized, while the contemporary bathroom is finished to a good standard. Additional benefits include one

3 Union Road, Shirley, Solihull B90 3BT

sales • new homes • land • commercial • mortgages • auction

allocated parking space, making this an excellent option for professionals or couples. Located close to local amenities, business parks, and transport links, this apartment combines comfort with convenience. Give us a call today to arrange a viewing!