

for sale

offers in excess of **£300,000**



Dummer Way Chippenham SN15 3UX

Semi detached house situated on the popular Pewsham development offering generous accommodation including a Lounge and Kitchen/Diner with French doors leading to the rear garden. Three bedrooms and a family bathroom complete the first floor accommodation.



Dummer Way Chippenham SN15 3UX

Description

A well-presented three-bedroom semi-detached home situated in a quiet cul-de-sac within the popular Pewsham development on Dummer Way, Chippenham. This property offers an ideal opportunity for first-time buyers, growing families, or investors seeking a well-located home with strong local amenities.

The ground floor comprises a welcoming entrance hall leading into a spacious living room, providing a comfortable space for relaxation and entertaining. To the rear, there is a fitted kitchen/dining area with a range of wall and base units, ample worktop space, and room for family dining. Patio doors open onto a private enclosed garden, ideal for outdoor enjoyment.

Upstairs, the property offers three well-proportioned bedrooms, including a generous principal bedroom, a second double bedroom, and a third bedroom suitable as a nursery, guest room, or home office. A family bathroom completes the first-floor accommodation.

Externally, the property benefits from off-road driveway parking leading to a single garage with personal door leading to fully enclosed rear garden, mainly laid to lawn with a patio area.



Ground Floor

Entrance Hall

Entrance door to front. Stairs to First Floor. Door to Lounge.

Lounge

Window to front. Feature fire. Door to Kitchen/Diner.

Kitchen/Diner

Fitted with a matching range of base and wall units with complementary work surfaces over with inset sink and drainer. Integrated double oven and hob with cooker hood over. Plumbing for washing machine. Window to rear. French doors to rear.

First Floor

Bedroom One

Window to rear.

Bedroom Two

Window to front.

Bedroom Three

Window to front.

Bathroom

Window to rear. Suite comprising low level WC and vanity wash hand basin. Walk in shower cubicle. Part tiled walls.

Outside

Front

Low maintenance and laid to block paving. Driveway parking leading to:

Single Garage

With roller door to front. Personal door to side leading to the Rear Garden.

Rear Garden

Fully enclosed. Mainly laid to lawn with large patio area. Workshop located to the rear of the Garage.



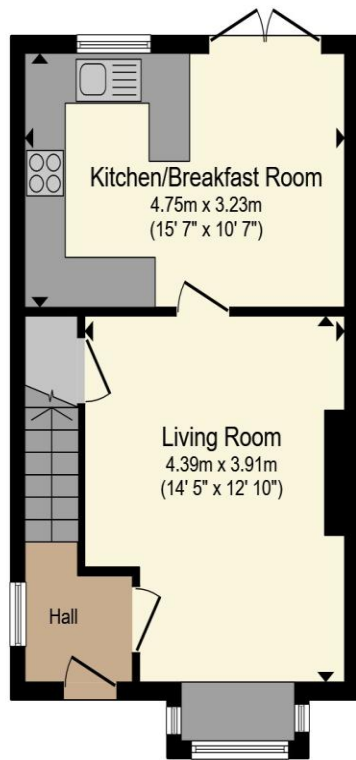

Ground Floor

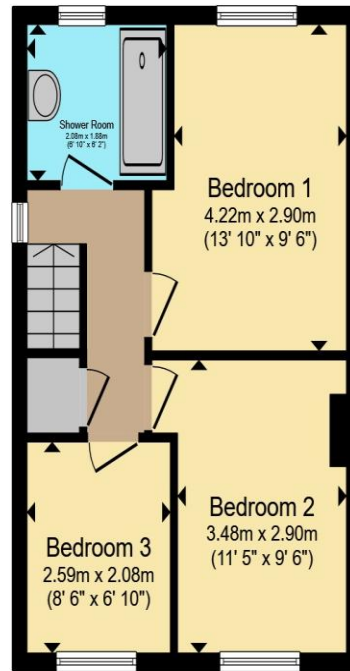

First Floor

Total floor area 72.8 m² (784 sq.ft.) approx

This floor plan is for illustrative purposes only. It is not drawn to scale. Any measurements, floor areas (including any total floor area), openings and orientation are approximate. No details are guaranteed, they cannot be relied upon for any purpose and they do not form part of any agreement. No liability is taken for any error, omission or misstatement. A party must rely upon its own inspection(s). Powered by www.propertybox.io



To view this property please contact Connells on

T 01249 652 476
E chippenham@connells.co.uk

59 Market Place
 CHIPPENHAM SN15 3HL

Property Ref: CHM306613 - 0004

Tenure:Freehold EPC Rating: D

Council Tax Band: C

view this property online
connells.co.uk/Property/CHM306613



1. MONEY LAUNDERING REGULATIONS Intending purchasers will be asked to produce identification documentation at a later stage and we would ask for your co-operation in order that there will be no delay in agreeing the sale. 2. These particulars do not constitute part or all of an offer or contract. 3. The measurements indicated are supplied for guidance only and as such must be considered incorrect. Potential buyers are advised to recheck measurements before committing to any expense. 4. We have not tested any apparatus, equipment, fixtures, fittings or services and it is in the buyers interest to check the working condition of any appliances.

Connells Residential is registered in England and Wales under company number 1489613, Registered Office is Cumbria House, 16-20 Hockliffe Street, Leighton Buzzard, Bedfordshire, LU7 1GN. VAT Registration Number is 500 2481 05.

see all our properties at www.connells.co.uk | www.rightmove.co.uk | www.zoopla.co.uk