



10, Weymouth Street,  
Marylebone, W1W

£1,100 Per Week,

NAPIER WATT

T: 0207 935 0011  
E: [enquiries@napierwatt.co.uk](mailto:enquiries@napierwatt.co.uk)  
W: [napierwatt.co.uk](http://napierwatt.co.uk)

35 Berkeley Square, Mayfair, London, W1J 5BF







## Description

A luxury two bedroom, two bathroom apartment extending to 702 sq ft situated in the heart of the West End. Interior designed in a contemporary style to a high standard the apartment offers bright and spacious accommodation, fully fitted kitchens, tiled bathrooms and 24 hour portorage. Air conditioning and parking by separate negotiation. Wifi, cleaning, laundry and parking available by separate negotiation.

: Entrance Hall : Reception Room : Kitchen : 2 Bedroom : Ensuite Bathroom : Shower Rooms : Balcony : Lifts : Concierge :

## Key Features

- LIFTS
- 24 PORTERAGE
- FURNISHED
- PARKING BY SEP NEG
- AIR CONDITIONING
- BALCONY
- MODERN BUILDING

## Terms

Fees & Charges: Tenancies exceeding £100,000 Per annum £480 inc VAT, Tenancies where a company is a tenant £480 Inc VAT.

## WEYMOUTH STREET

Approximate Gross Internal Area  
702 sq. ft. (65.2 sq. m.)

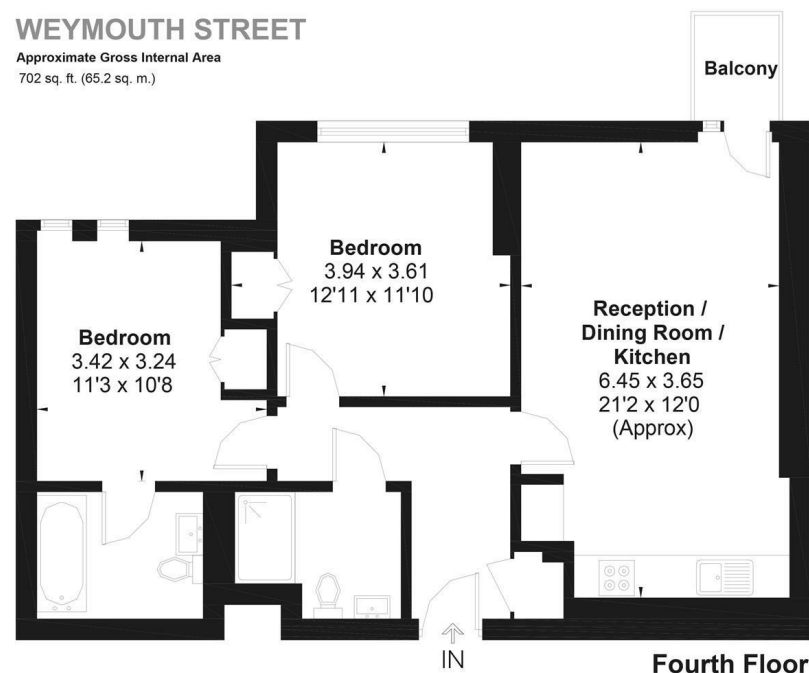

This plan is for layout guidance only. Not drawn to scale unless stated. Windows and door openings are approximate. Whilst every care is taken in the preparation of this plan, please check all dimensions, shapes and compass bearings before making any decisions reliant upon them. ID 749941

IMPORTANT: We would inform prospective purchasers that these sales particulars have been prepared as a general guide only. A detailed survey has not been carried out, nor the services, appliances and fittings tested. Room sizes should not be relied upon for furnishing purposes and are approximate. If floor plans are included, they are for guidance only and illustration purposes only and may not be to scale. If there are any important matters likely to affect your decision to buy, please contact us before viewing the property.