



GARDEN STIRLING BURNET

6 BEECHWOOD ROAD, HADDINGTON
EAST LOTHIAN, EH41 3AW



2



1

EPC
RATING

C

COUNCIL
TAX BAND

C



SUMMARY

Centrally located in the desirable market town of Haddington, this mid-terraced house offers a well-proportioned home with two double bedrooms, a bathroom, excellent built-in storage, and a bright living/dining room connected to a breakfasting kitchen with garden access. The interiors offer scope for modernisation, allowing the new owner to create a home tailored to their tastes.

A generous enclosed rear garden provides excellent outdoor space, whilst unrestricted on-street parking is available to the front, with potential to create a private driveway, subject to the necessary consents.

Extras: The property is sold as seen.

FEATURES

- Central location in desirable Haddington
- Mid-terraced house with scope for upgrades
- Entrance vestibule and hall
- Bright living/dining room, connected to:
- Breakfasting kitchen with garden access
- Two double bedrooms
- Bright bathroom with shower-over-bath
- Excellent built-in storage throughout
- Generous enclosed rear garden
- Low-maintenance front garden
- Unrestricted on-street parking
- Driveway potential, subject to consents
- Gas central heating and double glazing





OFFERS TO:
22 Hardgate
Haddington
EH41 3JS

Tel: 01620 825 368
Fax: 01620 824 671

DX540733 Haddington

espc

HOUSE SALES

If you have a house to sell, we provide free pre-sales advice, including valuation. We will visit your home and discuss in detail all aspects of selling and buying, including costs and marketing strategy, and will explain GSB Properties' comprehensive services.

1. While these Sales Particulars are believed to be correct, their accuracy is not warranted and they do not form any part of any contract. All sizes are approximate.
2. Interested parties are advised to note interest through their solicitor as soon as possible in order to be kept informed should a Closing Date be set. The seller will not be bound to accept the highest or any offer.

FLOORPLAN

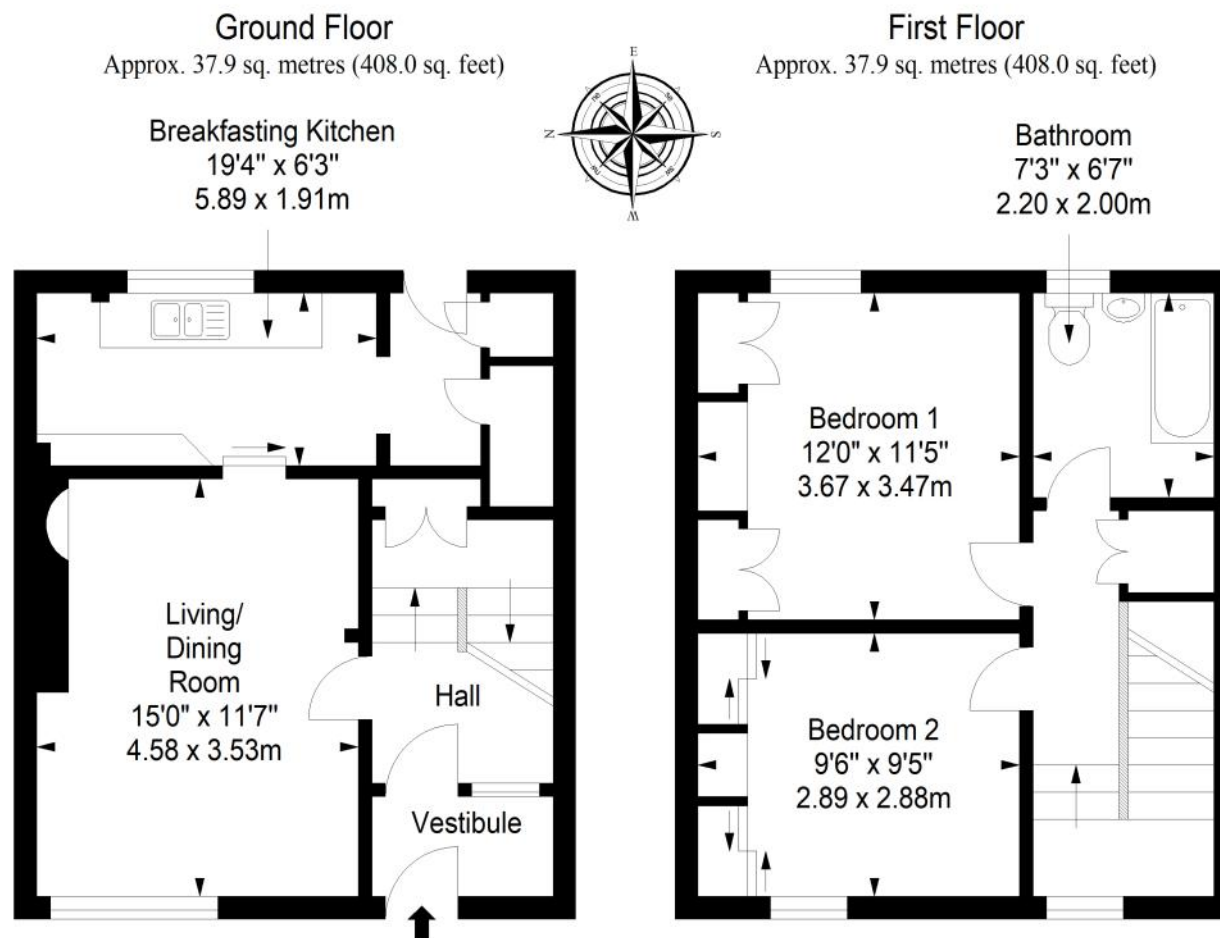

Total area: approx. 75.8 sq. metres (816.0 sq. feet)