



## Beaconsfield Road, N11

£395,000

An attractive red brick Edwardian ground floor garden flat with original features throughout. Equipped with two bedrooms, it has a bright and generously-sized reception room as well as an open kitchen and high ceilings throughout.

Beaconsfield Road is very well-placed for local transport links into the City via New Southgate (0.3 mile) and Arnos Grove (0.7 mile). Additionally, Friern Retail Park is close by, where you'll find a wide selection of shops, restaurants and other amenities.

### Features

- Garden Flat
- Generous Reception Room
- Original Features
- Edwardian Conversion
- High Ceilings
- Natural Light

# Beaconsfield Road, LONDON, N11

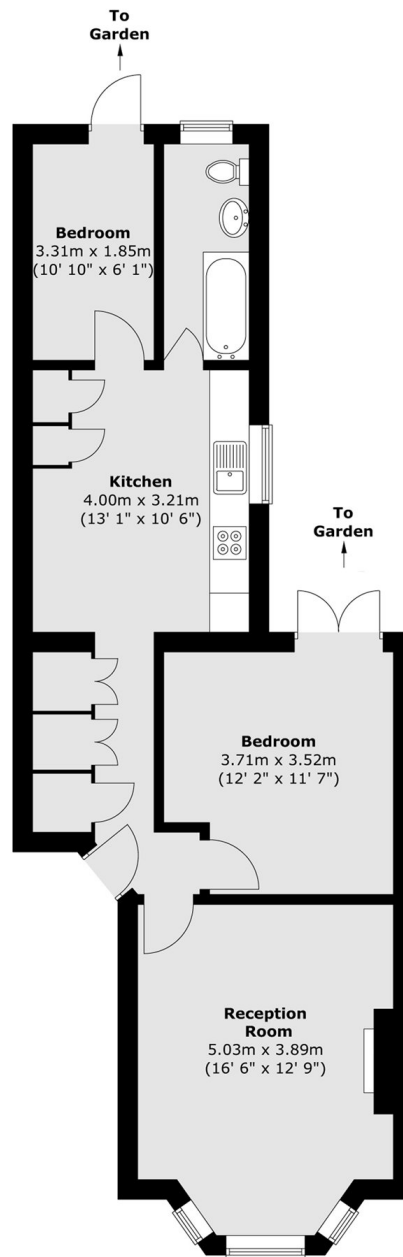

Total area (approx.) : 64.1 sq. m (690 sq. ft)