

For Sale



2b-4b Hucknall Road
Nottingham
NG5 1AB

T 0115 962 9770

E Nottingham@go-ps.co.uk

grangerandoaks.co.uk



Whitwell Road,
Strelley, Nottingham

Price: £210,000



Whitwell Road, Strelley, Nottingham, NG8 6JR

Price: £210,000



Information

STRELLEY: This three bedroom traditional semi-detached house sits on a popular street and has generous gardens, and off-road car-parking. Situated close to the bus network providing easy access into the city, the house has two receptions, three good sized bedrooms, and gardens front & rear. Coming to market chain-free the property would be perfect for a family or first-time buyer.

Summary of accommodation

- Excellent Presentation
- Three Double Bedrooms
- Gardens Front & Rear
- Ground Floor WC & Utility Room
- Newly Carpeted and Painted
- Close to Public Transport
- Off-Road Car Parking

Description

Entrance Hallway

UPVC Door. Carpeted. Central Heating Radiator. Stairs lead off. Doors lead off to ground floor rooms

Lounge

Carpeted. Double Glazed bay window. Central heating radiator. Glazed doors lead through to dining room.

Dining Room

Carpeted. Double Glazed bay window. Central heating radiator. Glazed doors lead through to living room.

Kitchen

Vinyl flooring. Central heating radiator. UPVC double glazed door out to garden. Fitted kitchen with roll-top work-surfaces. Integrated oven, hob & extractor (not tested) Space for other appliances.

Utility room

Gas Central heating boiler. Space for appliances. Double glazed window to rear.

WC

Tiled floor. Double glazed window to side. Low level flush toilet. Wash hand basin.

Stairs & Landing

Master Bedroom

At the front of the house. A good sized double bedroom. Carpeted. Central heating radiator. Airing cupboard.

Bedroom 2

At the front of the house. Central heating radiator. Carpeted

Bedroom 3

At the rear of the house. A large double bedroom. Central heating radiator. Carpeted.

Family Bathroom

Tiled floor & walls. Corner bath. Walk-in shower cubicle. WC & sink fitted into vanity unit below a large wall mirror. Opaque double glazed window. Chrome heated towel rail.

Outside

To the front the house sits behind a traditional lawned garden. To the side there is off-road car parking for two cars, leading through to a fenced garden and garage. At the rear a spacious low maintenance garden is paved and has a small storage shed situated behind the garage.

Disclaimer

These details are produced in good faith with the approval of the vendor/s and are given as a guide only. We have not tested any appliances or systems at this property and cannot verify them to be in working order. These details, descriptions and the measurements therein do not form part of any contract and whilst every effort is made to ensure accuracy, this cannot be guaranteed. Nothing herein contained shall be a warranty or condition and neither the vendor/s or ourselves will be liable to the purchaser in respect of any misrepresentations made at or before the date hereof by the vendor/s, agents or otherwise.

Whitwell Road, Strelley

Nottingham, NG8 6JR

Price: £210,000

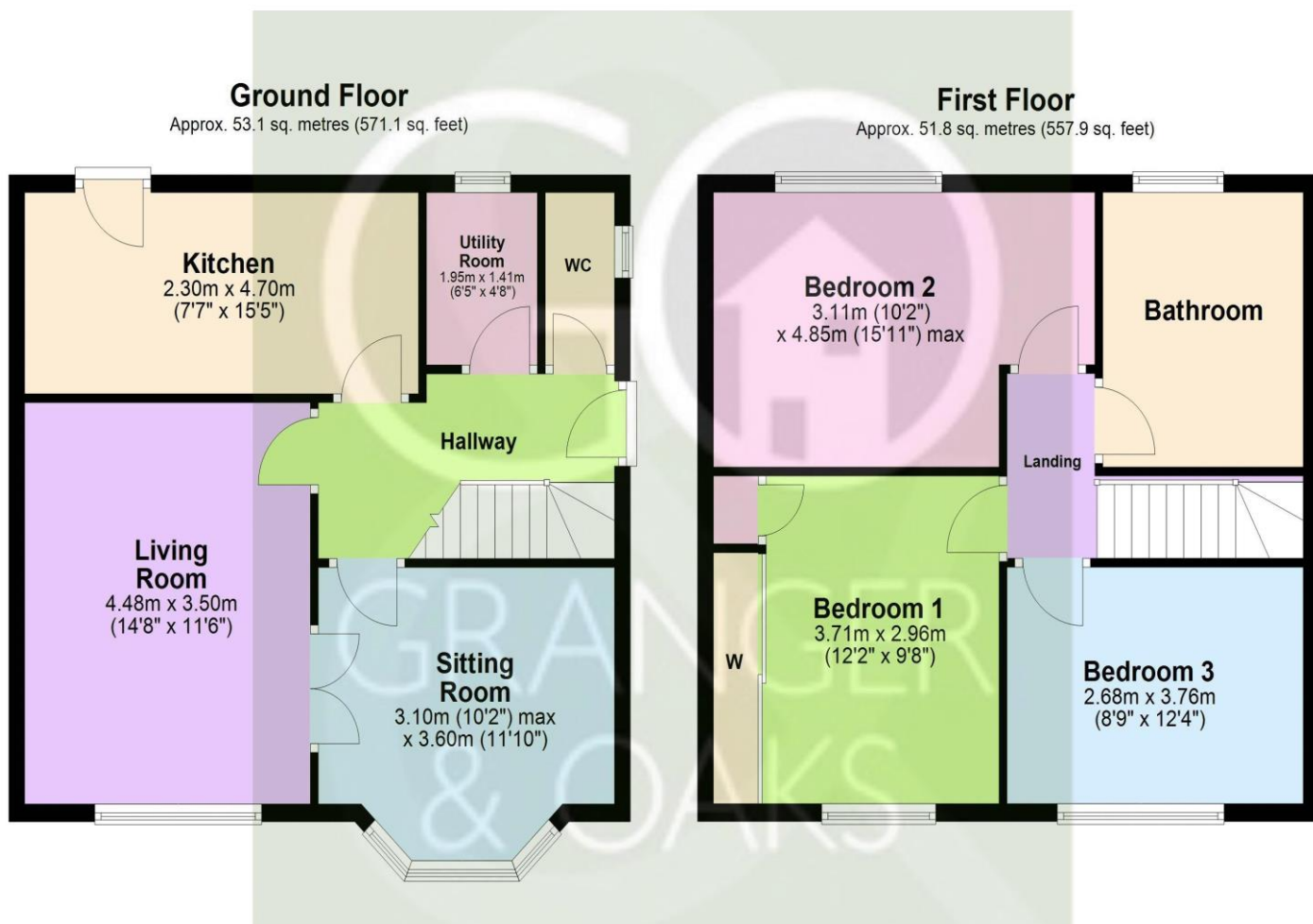

Total area: approx. 104.9 sq. metres (1129.0 sq. feet)

Score	Energy rating	Current	Potential
92+	A		
81-91	B		
69-80	C	72 C	78 C
55-68	D		
39-54	E		
21-38	F		
1-20	G		