

RAINBOW REID



ESTATE AGENTS || LETTING AGENTS || PROPERTY MANAGEMENT



160 Abercorn Crescent , Harrow, HA2 0PU

A bright, spacious and well presented three bedroom end of terrace house featuring a luxury, 10'1 x 6'1 kitchen including electric oven with gas cooker and extractor over, fridge/freezer and washer/dryer, access to garden. 26'1 x 11'9 through lounge with wood effect flooring and access to garden. Fully tiled downstairs w.c. On the first floor there is a luxury, fully tiled bathroom with shower attachment over bath, bedrooms measuring 13'7 x 10'11, 12'4 x 10'11 and 6'11 x 6'.

Approximately 145' rear garden. Off street front parking. Gas central heating and double glazed. New flooring throughout. Viewing highly advised.

Council tax band D
Available 29th June.

Situated 0.5 mile from South Harrow's Piccadilly Line tube and bus stations and 330 yards the sought after Whitmore High School and 0.5 mile from Vaughan Primary School.

£2,300 Per Month

160 Abercorn Crescent

, Harrow, HA2 0PU

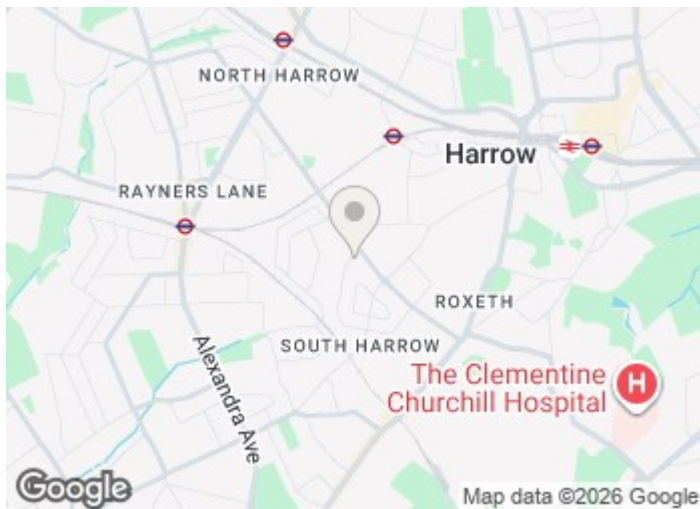

[Directions](#)



Floor Plan

160 Abercorn Crescent, Harrow, HA2 0PU

Approximate Gross Internal Area = 78.9 sq m / 849 sq ft

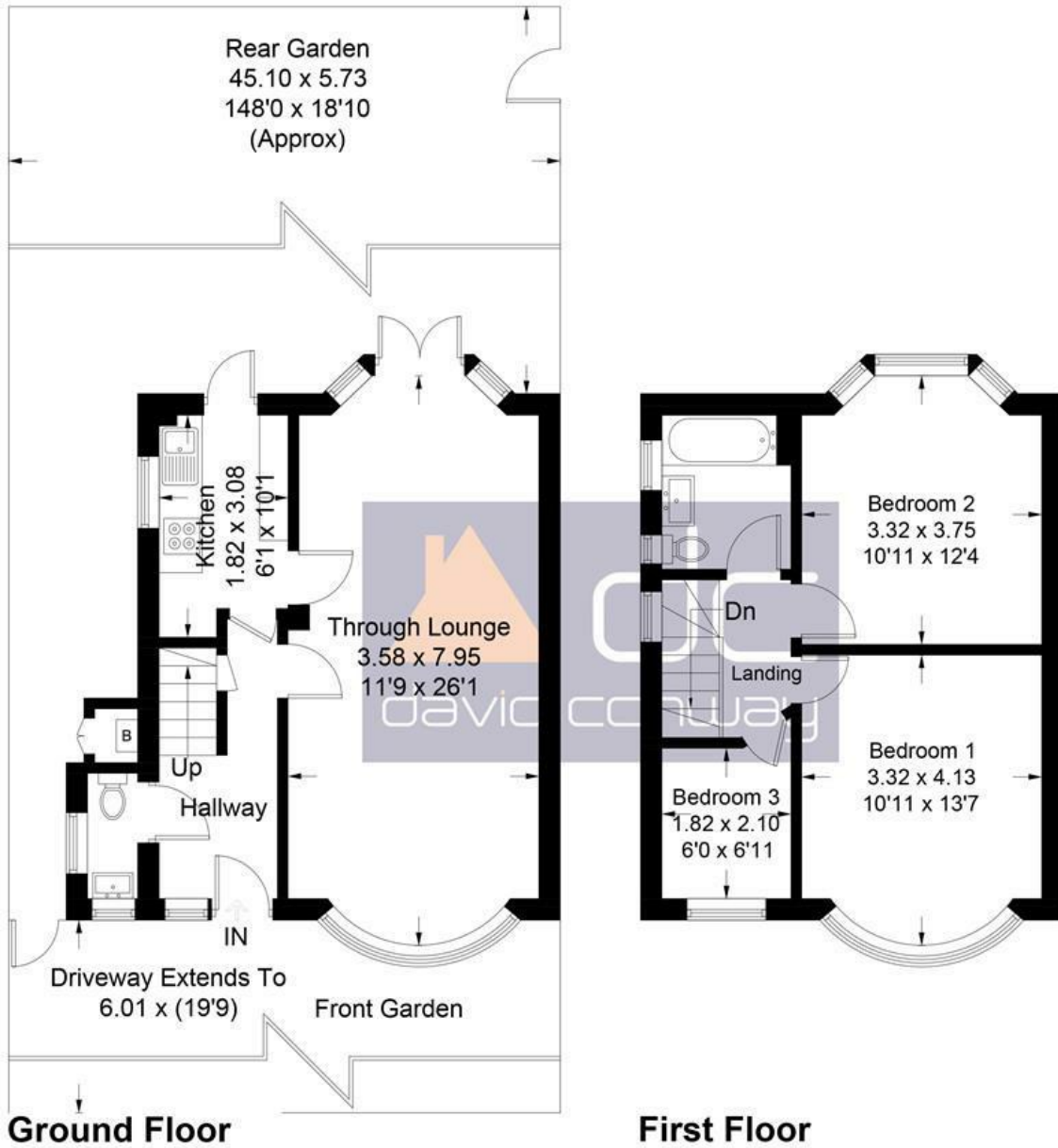

Illustration for identification purposes only, measurements are approximate, not to scale. David Conway © 2019 (ID602195)

These particulars, whilst believed to be accurate are set out as a general outline only for guidance and do not constitute any part of an offer or contract. Intending purchasers should not rely on them as statements of representation of fact, but must satisfy themselves by inspection or otherwise as to their accuracy. No person in this firm's employment has the authority to make or give any representation or warranty in respect of the property.

