



27 Simpson Street | Manchester | M4 4GB

Asking Price £205,000

The
**GOOD
ESTATE**
AGENCY

27 Simpson Street | Angel Meadows Manchester | M4 4GB

1 BED APARTMENT WITH TERRACE & PARKING. Welcome to Halo House, a charming one-bedroom apartment nestled in the desirable Angel Meadows area, perfectly situated between the vibrant neighbourhoods of Ancoats. This delightful property is located on the fifth floor, offering a spacious living area that spans an impressive 544 square feet, making it an ideal home for individuals or couples seeking comfort and convenience.

As you enter the apartment, you will be greeted by a bright and airy reception room that seamlessly flows into the well-appointed kitchen, creating an inviting space for both relaxation and entertaining. The bedroom is generously sized, providing a peaceful retreat at the end of the day. The house bathroom features a shower over the bath, catering to all your bathing needs.

One of the standout features of this property is the top floor balcony or terrace, where you can enjoy your morning coffee or unwind in the evening while taking in the views of the surrounding area. Additionally, the apartment comes with an allocated parking space, a valuable asset in this bustling location.

Currently let for £1,100 per calendar month until October 1, 2026, this apartment presents an excellent investment opportunity, achieving a rental yield of 6.4%. Whether you are looking for a new home or a sound investment, this property in Angel Meadows is not to be missed. With its prime location and appealing features, Halo House offers a perfect blend of modern living and urban convenience.

- ONE BEDROOM APARTMENT
- TOP FLOOR BALCONY / TERRACE
- FITTED KITCHEN WITH BOSCH APPLIANCES
- CURRENTLY LET FOR £1,100PCM UNTIL 1/10/26, ACHIEVING A RENTAL YIELD OF 6.4%
- ANGEL MEADOWS LOCATION
- 5TH FLOOR
- OPEN PLAN LIVING & DINING ROOM
- STYLISH BATHROOM
- 544 SQ FT
- CLOSE TO VICTORIA STATION





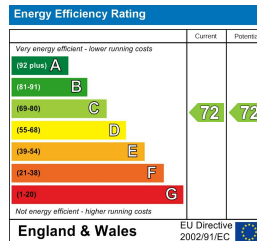
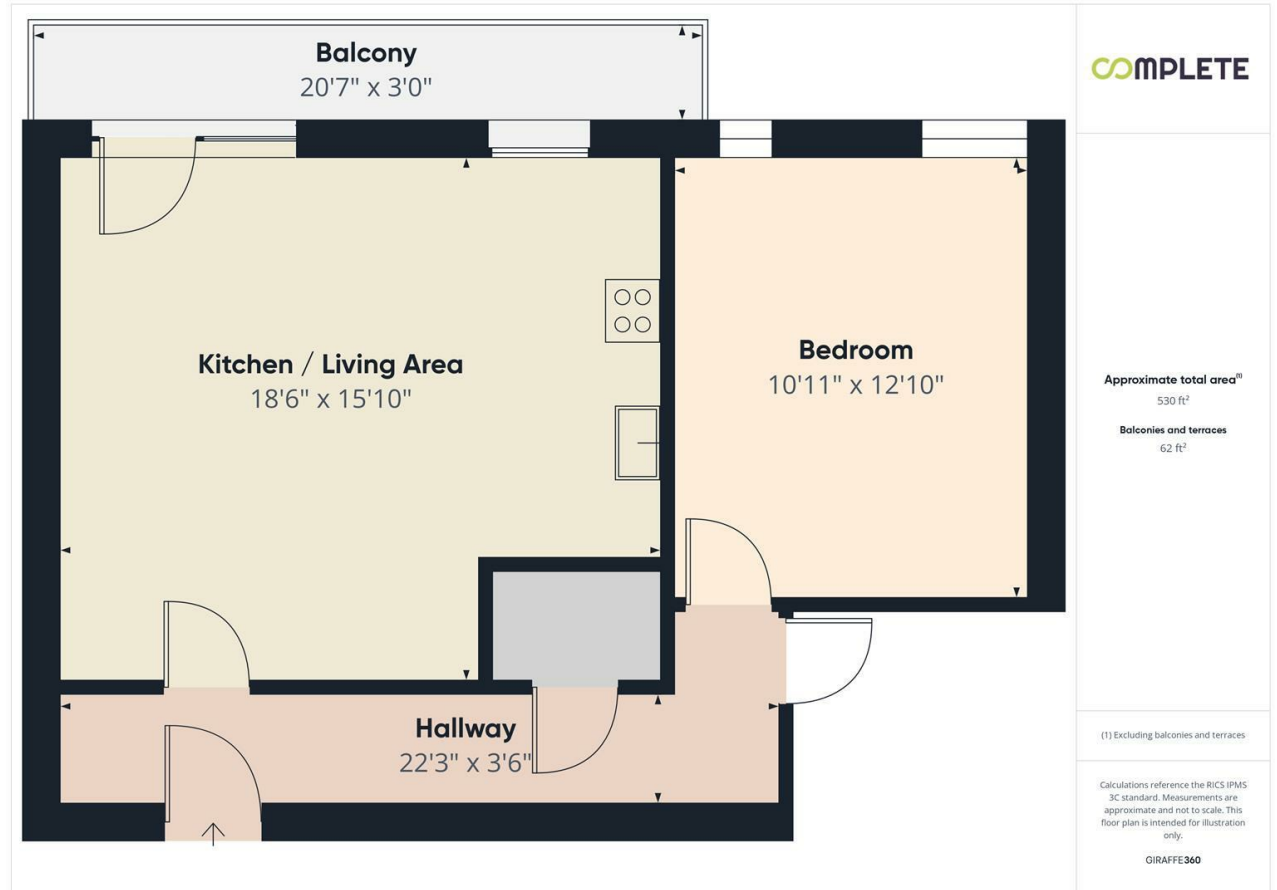
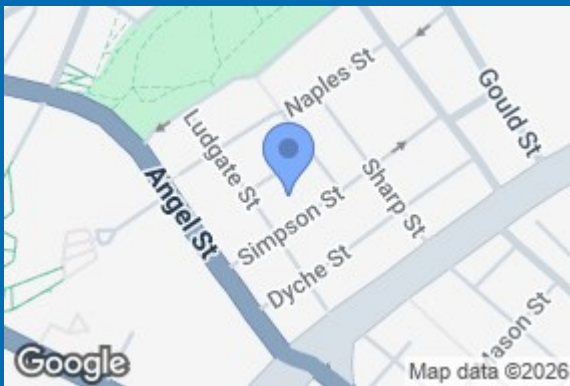
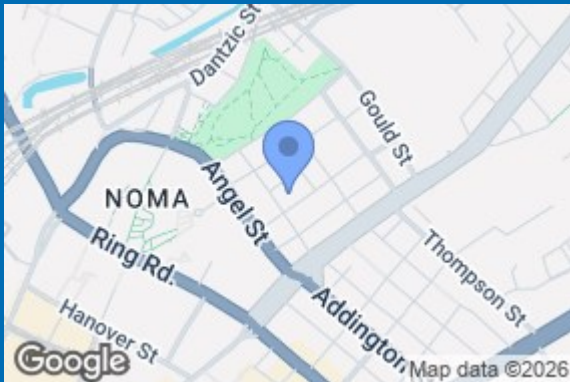
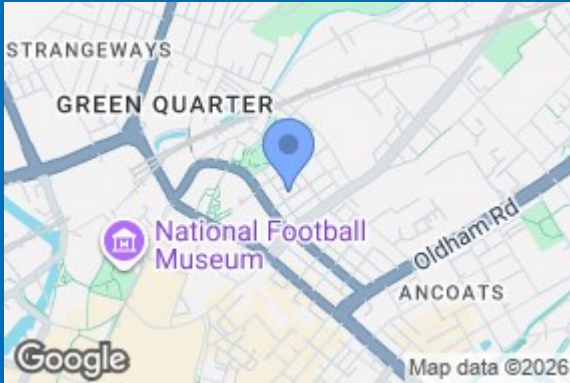

68 Quay Street
Manchester
M3 3EJ
0161 513 2034
hello@thegea.co.uk
www.thegea.co.uk