

**14 CHANTRY MEAD
HUNGERFORD**



Marshall

Estate Agents

14 Chantry Mead

Hungerford, Berkshire, RG17 0HT

£299,950

Approximately 0.7 Miles to Hungerford
Railway Station

Approximately 9 Miles to Newbury

Approximately 3.7 Miles to M4 J14

- Freehold
- Mid Terraced House
- Sought After Residential Area
- Sitting Room
- Kitchen/ Dining Room
- Three Bedrooms
- Family Shower Room
- Landscaped Low Maintenance Garden
- Garage
- Parking space
- Gas Central Heating
- Double Glazing
- Glorious Far Reaching Views



Situation

The pretty market Town of Hungerford is steeped in History and sits on the banks of the chalk stream River Kennet and the Kennet and Avon canal. The Town is well served by a variety of shops including butchers, bakers, independent retailers and of course antique shops. Other amenities include two supermarkets, a post office, two building societies and a doctors surgery. There is also a swimming pool, leisure sports centre, gym and tennis club.



The Property

A lovely mid terrace house located in a sought after residential area with glorious far reaching views.

This lovely home includes a generous Kitchen/Dining room with wooden cabinetry and tiled work surfaces and a comfortable Sitting room with patio doors leading out to the garden.

Upstairs, three well proportioned Bedrooms are served by a modern shower room.

The property benefits from gas central heating and double glazing.

Outside

To the front the property is accessed by shared steps that lead to a small patio area and in turn the front door.

To the rear there is a landscaped low maintenance garden with a sun terrace towards the top of the garden.

There is a single garage plus a private parking space to the side of the garage.







Score	Energy rating	Current	Potential
92+	A		
81-91	B		84 B
69-80	C	72 C	
55-68	D		
39-54	E		
21-38	F		
1-20	G		

Services

Mains Water & Drainage
 Mains Electricity
 Mains Gas

Council Tax Band: C

What 3 Words Location: ///maximum.soaps.deferring

Ground Floor

Approx. 34.4 sq. metres (369.8 sq. feet)

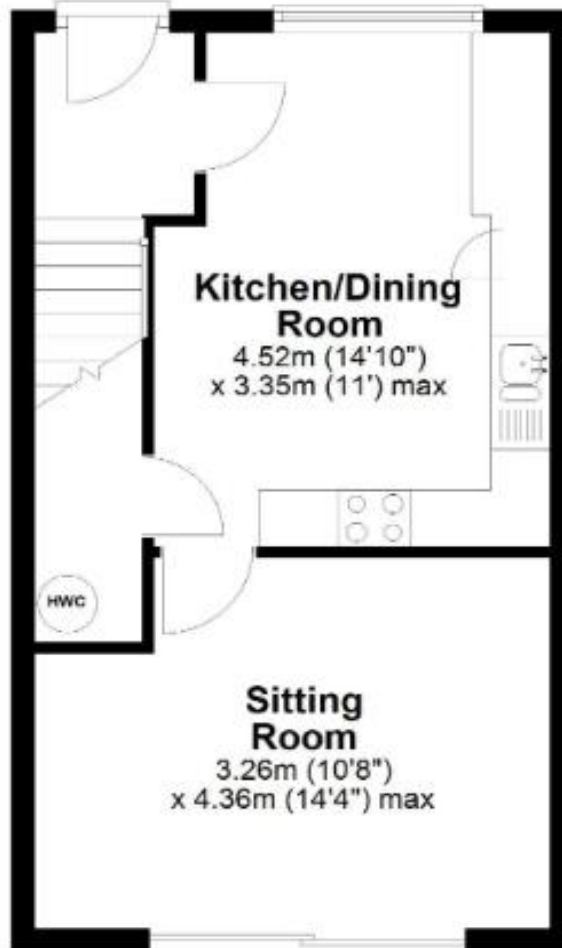

First Floor

Approx. 34.5 sq. metres (371.2 sq. feet)

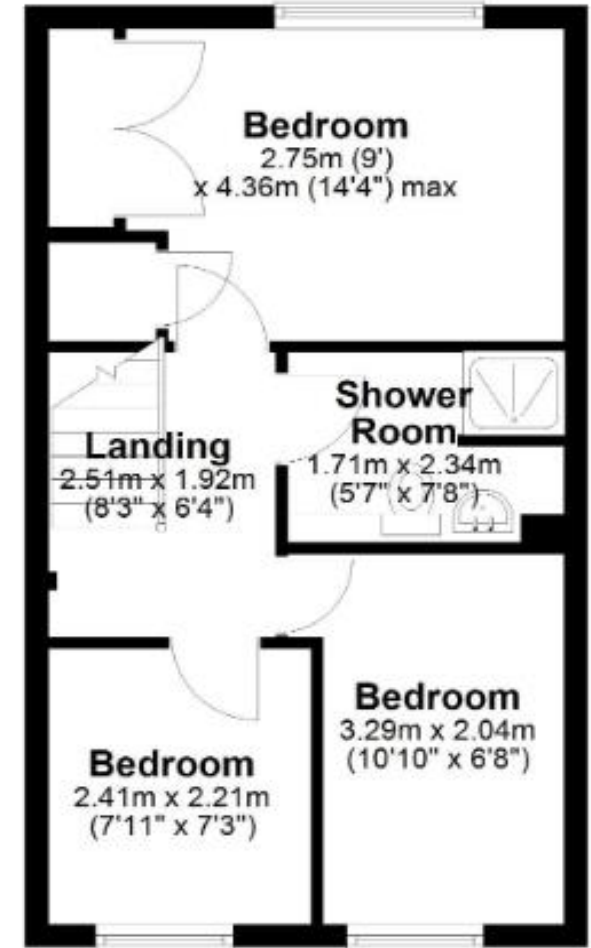

Total area: approx. 68.8 sq. metres (741.0 sq. feet)

14 Chantry Mead, Hungerford

01488 686867

www.marshallestateagents.co.uk
 sales@marshallestateagents.co.uk
 19 High Street
 Hungerford, Berkshire, RG17 0NL



These particulars are not an offer or contract or part thereof. Their accuracy is not guaranteed. No statement made in them shall be relied on as a statement or representation of fact and we and the vendors have no responsibility for them. We and our employees have no authority to and do not make or give any representations or warranty concerning this property any appliances mentioned or general services and any intending purchase must rely upon an inspection of the property.