



## Yeoman Street, SE8

£500,000

Situated within this extremely sought after development, this stunning two double bedroom flat boasts a large open plan kitchen and living space, modern bathroom, ample storage, private balcony, communal roof terrace and gym facilities.

Located just 0.4 miles from Surrey Quays station and 0.8 miles to Canada Water station, Mandara Place offers excellent transport links to anywhere in London. A wide range of shops, deli's and restaurants are close by.

### Features

- Two Double Bedrooms
- Excellent Condition
- Gym Facilities
- Fantastic Location
- Chain Free
- Private Balcony

# Yeoman Street, London, SE8

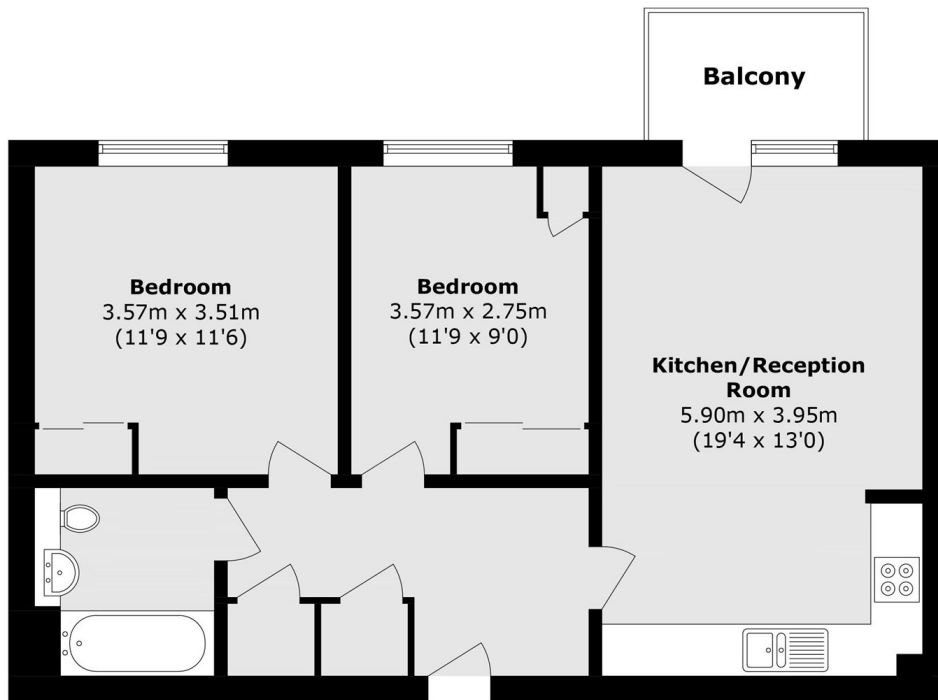

## Fourth Floor

Total area (approx.): 60.5 sq. m (651.2 sq. ft)

Balcony area (approx.): 3.6 sq. m (38.7 sq. ft)