



Pinkmove

## Ellick Street, Guide Price £130,000 to £140,000

- Quaint Two-Bedroom Terraced House with character features
- Spacious Lounge/Diner with Log Burner
- Family Shower Room
- Boarded Attic Space
- Located in Blaenavon, a UNESCO World Heritage Town
- Close to Local Shops, Schools and Amenities



Pinkmove

01633 746088  
team@pinkmove.co.uk



## About the property

Now on the market — this beautiful two-bedroom terraced house is located in the heart of Blaenavon, a UNESCO World Heritage town celebrated for its rich industrial heritage and stunning natural surroundings.

Upon entering the property, you are welcomed into a spacious open-plan living and dining room, beautifully presented and featuring a cosy log burner — perfect for relaxing evenings or entertaining guests. To the rear of the home, a well-equipped kitchen leads directly to a practical family shower room, offering both convenience and comfort. Upstairs, the property boasts two double bedrooms, providing flexible living arrangements for couples, small families, or those working from home. A boarded attic offers valuable additional storage space, enhancing the home's practicality.

Outside, the rear garden is fully enclosed and features both a patio and a lawned area, creating a peaceful outdoor retreat ideal for relaxing, gardening, or hosting.

This home enjoys a central location on Ellick Street, with easy access to local shops, cafés, and amenities along Blaenavon High Street. St Peter's Church in Wales Primary School is just a short walk away, while other schools including Blaenavon Heritage School and Abersychan Comprehensive are within easy reach. Regular bus services connect Blaenavon to nearby towns such as Pontypool, Cwmbran, and Newport, and road links via the A4043 provide straightforward access to the M4 corridor for commuting to Cardiff and Bristol.

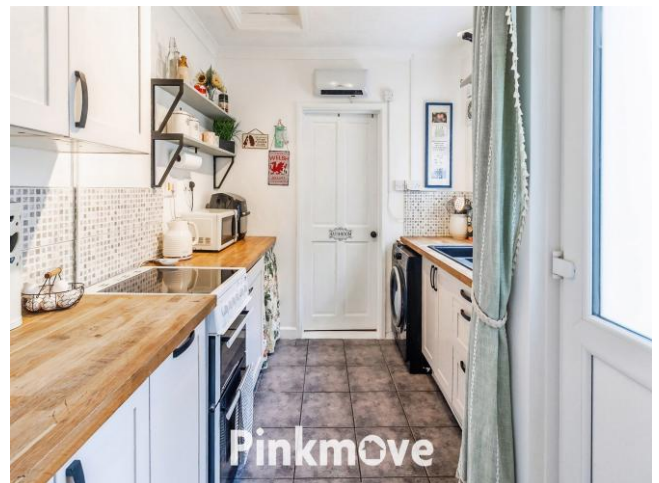



## Accommodation

### Lounge/Diner

20' 10" x 11' 11" ( 6.35m x 3.63m )

### Kitchen

9' 1" x 7' 11" ( 2.77m x 2.41m )

Max measurements

### Shower Room

4' 11" x 8' ( 1.50m x 2.44m )

### Bedroom 1

9' 10" x 11' 11" ( 3.00m x 3.63m )

### Bedroom 2

10' 10" x 9' ( 3.30m x 2.74m )

01633 746088

team@pinkmove.co.uk

**Pinkmove**

## Floorplan

### Ground Floor

Approx. 33.2 sq. metres (357.1 sq. feet)

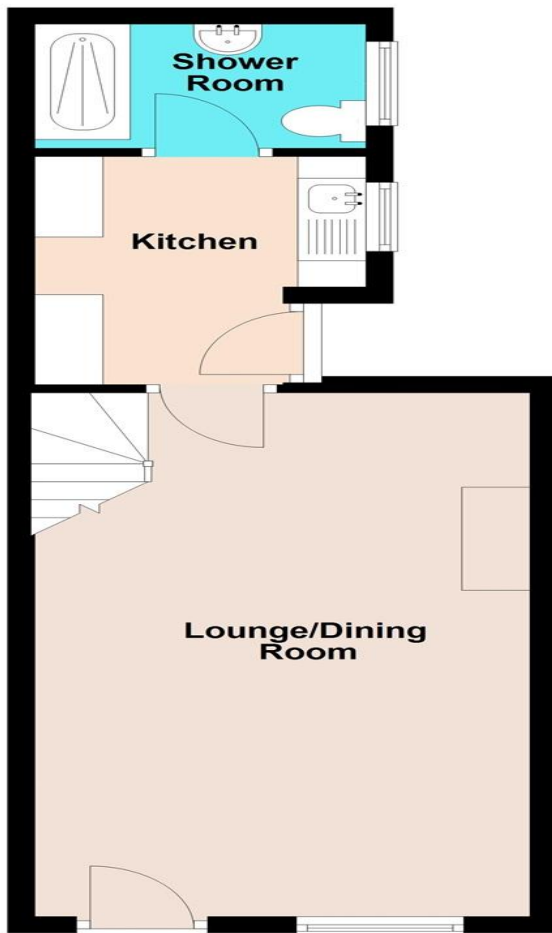

### First Floor

Approx. 22.7 sq. metres (243.9 sq. feet)



Total area: approx. 55.8 sq. metres (601.0 sq. feet)

**10 Ellick Street**

## Important Information

Note while we endeavour to make our sales details accurate and reliable, if there is any point which is of particular interest to you, please contact the office and we will be pleased to confirm the position for you. We have not personally tested any apparatus, equipment, fixtures, fittings or services and cannot verify they are in working order or fit for their purposes. Nothing in these particulars is intended to indicate that carpets or curtains, furnishings or fittings, electrical goods (whether wired or not). Gas fires or light fittings or any other fixtures not expressly included form part of the property offered for sale. This computer generated Floorplan, if applicable, is intended as a general guide to the layout and design of the property. It is not to scale and should not be relied upon for dimensions. Tenure: We cannot confirm the tenure of the property as we have not had access to the legal documents. The buyer is advised to obtain verification from their solicitor or surveyor.

Peter Alan Limited is registered in England and Wales under company number 2073153, Registered Office is Cumbria House, 16-20 Hockliffe Street, Leighton Buzzard, Bedfordshire, LU7 1GN. VAT Registration Number is 500 2481 05. For activities relating to regulated mortgages and non-investment insurance contracts, Peter Alan Limited is an appointed representative of Connells Limited which is authorised and regulated by the Financial Conduct Authority. Connells Limited's Financial Services Register number is 302221. Most buy-to-let

