



## Palace Gardens Terrace, W8

£1,850 Per calendar month

This bright and spacious studio apartment is situated on the third floor of a well-maintained portered building, complete with lift access. Thoughtfully laid out, the property features a separate kitchen and a private balcony, offering both comfort and practicality. Ideal for a single professional, it provides a stylish home with convenient access to Kensington Gardens and Notting Hill Gate Station

Broadwalk Court is on Palace Gardens Terrace and is convenient for the wide range of shops and amenities of both Notting Hill Gate and Kensington High Street; including Whole Foods and the Coronet cinema.

### Features

- Porter
- Balcony
- Lift
- Part Furnished
- Heating And Hot Water Included
- Notting Hill Gate Station



Palace Gardens Terrace, W8



# Palace Gardens Terrace, London, W8

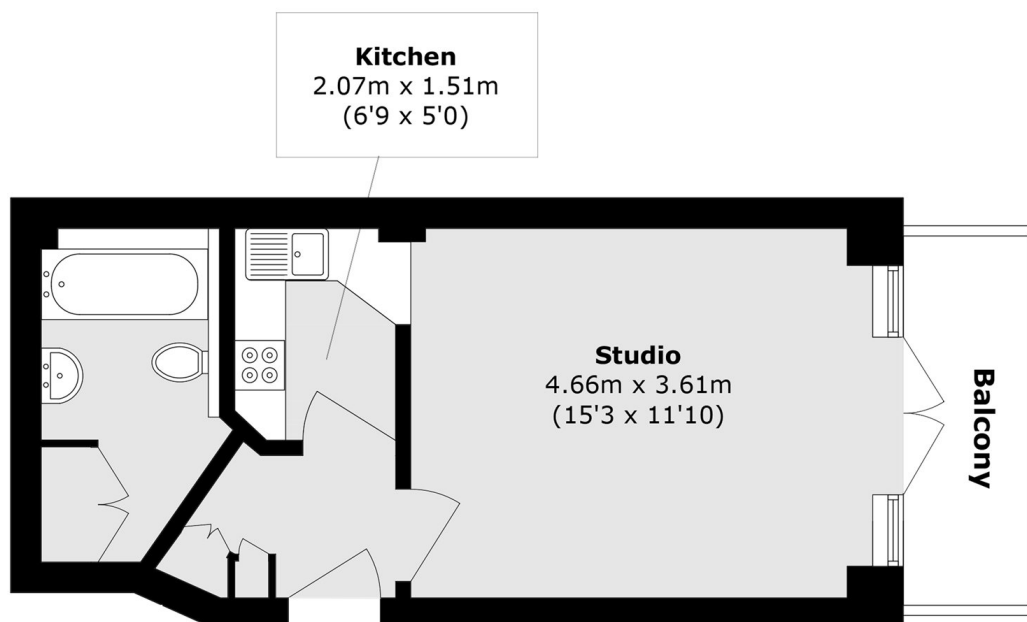

Total area (approx.): 28.8 sq. m (310.0 sq. ft)

Balcony area (approx.): 4.4 sq. m (47.3 sq. ft)